

THE CORPORATION OF THE DISTRICT OF BURNABY

BYLAW NO. 9637

A BYLAW to amend Bylaw No. 4742, being
Burnaby Zoning Bylaw 1965

WHEREAS application for rezoning has been made to the Council.

AND WHEREAS the Council has held a public hearing thereon after duly giving notice of the time and place of such hearing as prescribed by Sections 956 and 957 of the Municipal Act, R.S.B.C. 1979.

NOW THEREFORE the Council of The Corporation of the District of Burnaby ENACTS as follows:

1. This Bylaw may be cited as BURNABY ZONING BYLAW 1965, AMENDMENT BYLAW NO. 41, 1991.
2. The Map (hereinafter called "Map 'A'"), attached to and forming an integral part of Bylaw No. 4742, being "Burnaby Zoning Bylaw 1965", and designated as the Official Zoning Map of The Corporation of the District of Burnaby, is hereby amended according to the Map (hereinafter called "Map 'B'"), marginally numbered R.Z. 1892, annexed to this Bylaw, and in accordance with the explanatory legend, notations, references and boundaries designated, described, delimited and specified in particularity shown upon said Map 'B'; and the various boundaries and districts shown upon said Map 'B' respectively are an amendment of and in substitution for the respective districts, designated and marked on said Map 'A' insofar as the same are changed, modified or varied thereby, and the said Map 'A' shall be deemed to be and is hereby declared to be amended accordingly and the said Map 'B' is hereby declared to be and shall form an integral part of said Map 'A', as if originally incorporated therein and shall be interpreted accordingly.

3. The Comprehensive Development Plan represented in the report of the Director Planning & Building Inspection entitled "Planning and Building Inspection, Rezoning Reference #68/90, 1991 August 19" for the rezoning of Parcel "One" (Explanatory Plan 10599), Lot "C", Block 2, District Lot 73, Group 1, New Westminster District, Plan 4326 from M1 Manufacturing District, M6 Truck Terminal District and R5 Residential District to CD Comprehensive Development District, based on M5 District use and density and in accordance with the Community Plan guidelines, including the sketches contained therein, and on file in the office of the Director Planning and Building Inspection, is deemed to be attached to and form part of this Bylaw and any development on the lands rezoned by this Bylaw shall be in conformity with the said Comprehensive Development Plan.

Read a first time this 3rd day of SEPTEMBER 1991
Read a second time this 7th day of OCTOBER 1991
Read a third time this 13th day of OCTOBER 1992
Reconsidered and adopted this 14th day of FEBRUARY 1994

MAYOR

CLERK

BYLAW NUMBER 9637 BEING A BYLAW TO AMEND RZ #68/90
 BYLAW NUMBER 4742 BEING THE BURNABY ZONING BYLAW 1965

MAP "B"

PROPERTY REZONED TO:

CD COMPREHENSIVE DEVELOPMENT DISTRICT (BASED ON M5 LIGHT INDUSTRIAL DISTRICT USE AND DENSITY AND IN ACCORDANCE WITH THE COMMUNITY PLAN GUIDELINES AS SHOWN IN APPENDIX "A" OF THE REZONING REPORT)
 TRANS CANADA HWY

LEGAL: PARCEL "ONE" (EXPLANATORY PLAN 10599), LOT "C", BLK. 2, D.L. 73, PLAN 4326;

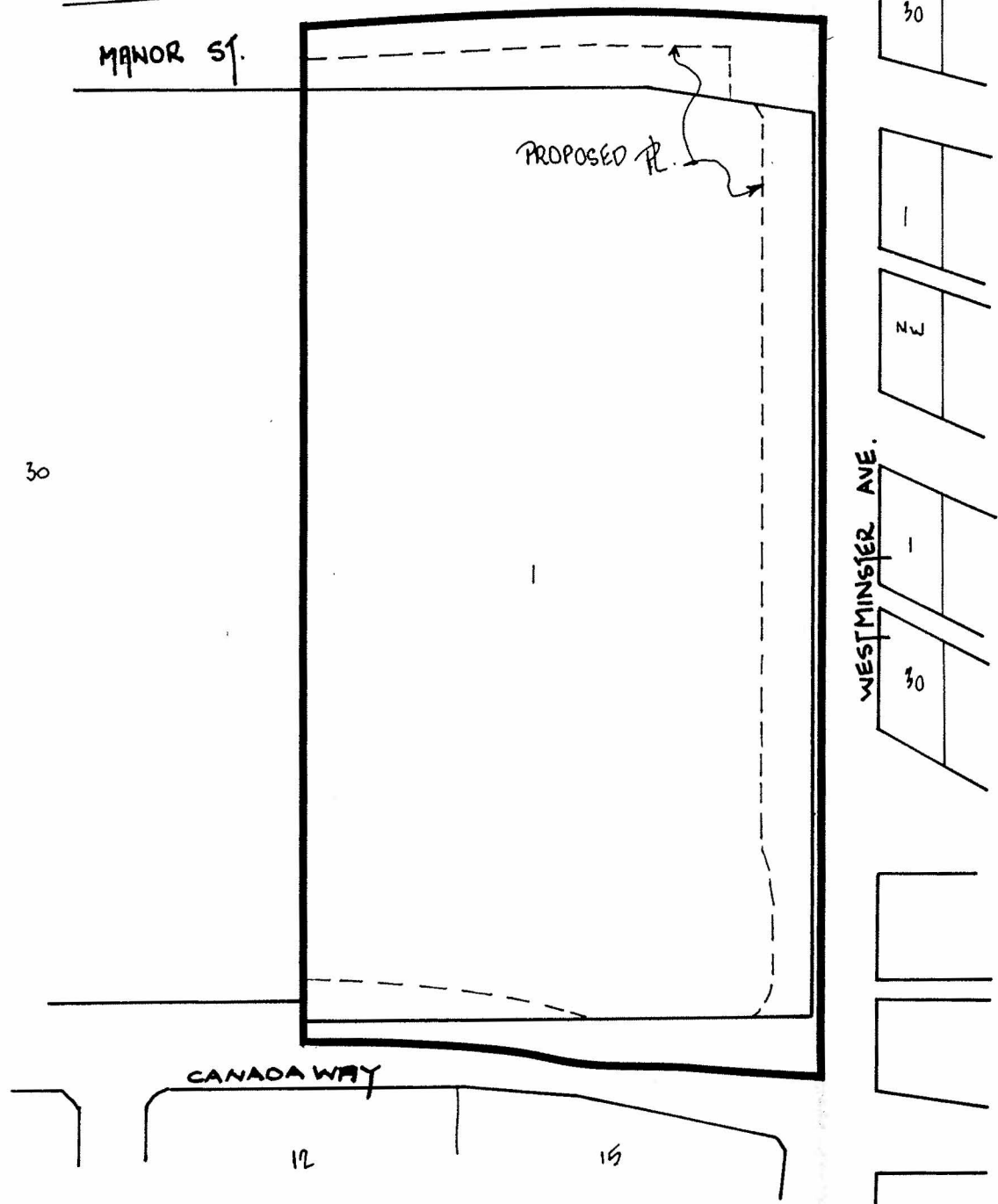

THE AREA(S) SHOWN ABOVE OUTLINED IN BLACK (—) IS (ARE) REZONED:

FROM: M1 MANUFACTURING DISTRICT, M6 TRUCK TERMINAL DISTRICT AND R5 RESIDENTIAL DISTRICT

TO: CD COMPREHENSIVE DEVELOPMENT DISTRICT (BASED ON M5 LIGHT INDUSTRIAL DISTRICT USE AND DENSITY AND IN ACCORDANCE WITH THE COMMUNITY PLAN GUIDELINES AS SHOWN IN APPENDIX "A" OF THE REZONING REPORT)

PLANNING DEPARTMENT	THE CORPORATION OF THE DISTRICT OF BURNABY	
SCALE	1:2000	OFFICIAL ZONING MAP
DRAWN	J.P.C.	
DATE	AUGUST 1991	
		No. RZ 1892