

THE CORPORATION OF THE DISTRICT OF BURNABY

BYLAW NO. 9528

A BYLAW to amend Bylaw No. 4742, being
Burnaby Zoning Bylaw 1965

WHEREAS application for rezoning has been made to the
Council;

AND WHEREAS the Council has held a public hearing
thereon after duly giving notice of the time and place of such
hearing as prescribed by Sections 956 and 957 of the Municipal
Act, R.S.B.C. 1979;

NOW THEREFORE the Council of The Corporation of the
District of Burnaby ENACTS as follows:

1. This Bylaw may be cited as BURNABY ZONING BYLAW 1965,
AMENDMENT BYLAW NO. 1, 1991.

2. The Map (hereinafter called "Map 'A'"), attached to and
forming an integral part of Bylaw No. 4742, being "Burnaby Zoning
Bylaw 1965", and designated as the Official Zoning Map of The
Corporation of the District of Burnaby, is hereby amended
according to the Map (hereinafter called "Map 'B'"), marginally
numbered R.Z. 1859, annexed to this Bylaw, and in accordance with
the explanatory legend, notations, references and boundaries
designated, described, delimited and specified in particularity
shown upon said Map 'B'; and the various boundaries and
districts shown upon said Map 'B' respectively are an amendment
of and in substitution for the respective districts, designated
and marked on said Map 'A' insofar as the same are changed,
modified or varied thereby, and the said Map 'A' shall be deemed
to be and is hereby declared to be amended accordingly and the
said Map 'B' is hereby declared to be and shall form an integral
part of said Map 'A', as if originally incorporated therein and
shall be interpreted accordingly.



3. The Comprehensive Development Plan entitled COMMERCIAL DEVELOPMENT prepared by URBAN DESIGN GROUP ARCHITECTS and on file in the office of the Director Planning and Building Inspection, is deemed to be attached to and form part of this Bylaw and any development on the lands rezoned by this Bylaw shall be in conformity with the said Comprehensive Development Plan.

Read a first time this 14th day of JANUARY 1991

Read a second time this 4th day of FEBRUARY 1991

Read a third time this 6th day of MAY 1991

Reconsidered and adopted this 3rd day of SEPTEMBER 1991

MAYOR

CLERK

BYLAW NUMBER 9528 BEING A BYLAW TO AMEND RZ #23/90
BYLAW NUMBER 4742 BEING THE BURNABY ZONING BYLAW 1965

PROPERTY REZONED TO:

MAP "B"

CD COMPREHENSIVE DEVELOPMENT DISTRICT
(BASED ON C1 NEIGHBOURHOOD COMMERCIAL DISTRICT
GUIDELINES AND IN ACCORDANCE WITH THE DEVELOPMENT
PLAN ENTITLED "COMMERCIAL DEVELOPMENT" PREPARED BY
URBAN DESIGN GROUP ARCHITECTS)

LEGAL: PCL. 2 (EXP. PLAN 10916) OF PARCEL A, BLK. 23, D.L. 1, PLAN 3043;

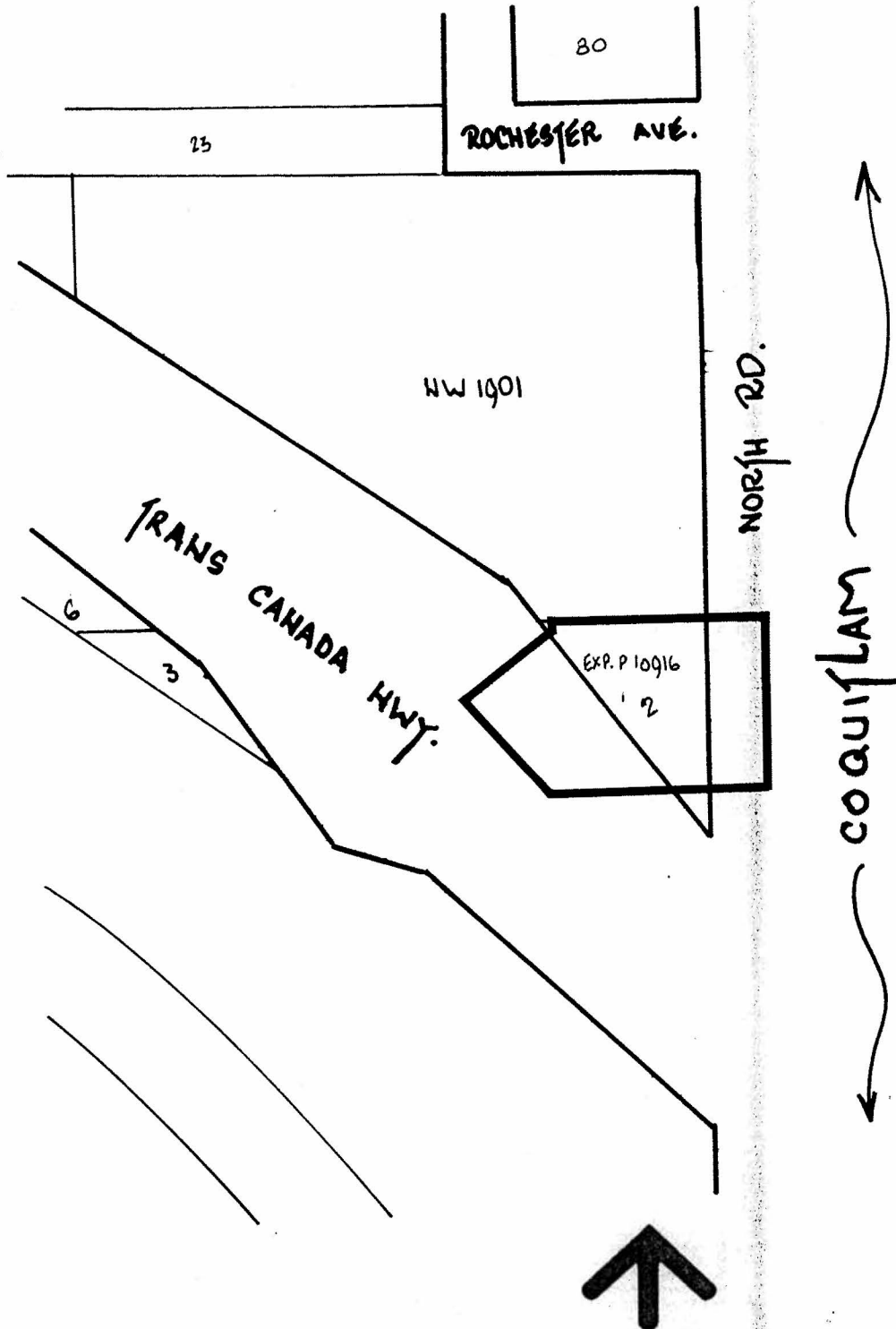

THE AREA(S) SHOWN ABOVE
OUTLINED IN BLACK (—)
IS (ARE) REZONED:

FROM: M2 GENERAL INDUSTRIAL DISTRICT
TO: CD COMPREHENSIVE DEVELOPMENT DISTRICT
(BASED ON C1 NEIGHBOURHOOD COMMERCIAL DISTRICT
GUIDELINES AND IN ACCORDANCE WITH THE DEVELOPMENT
PLAN ENTITLED "COMMERCIAL DEVELOPMENT" PREPARED BY
URBAN DESIGN GROUP ARCHITECTS)

PLANNING DEPARTMENT		THE CORPORATION OF THE DISTRICT OF BURNABY	
SCALE	1:2000	OFFICIAL ZONING MAP	
DRAWN	J.P.C.		
DATE	DECEMBER 1990		
		No. RZ 1859	