

THE CORPORATION OF THE DISTRICT OF BURNABY

BYLAW NO. 9502

A BYLAW to amend Bylaw No. 4742, being
Burnaby Zoning Bylaw 1965



WHEREAS application for rezoning has been made to the Council.

AND WHEREAS the Council has held a public hearing thereon after duly giving notice of the hearing as prescribed by sections 956 and 957 of the Municipal Act R.S.B.C. 1979.

NOW THEREFORE the Council of The Corporation of the District of Burnaby ENACTS as follows:

1. This Bylaw may be cited as BURNABY ZONING BYLAW 1965, AMENDMENT BYLAW NO. 69, 1990.
2. The map (hereinafter called "Map 'A'") attached to and forming an integral part of Bylaw No. 4742, being Burnaby Zoning Bylaw 1965, and designated as the Official Zoning Map of The Corporation of the District of Burnaby, is hereby amended according to the Map (hereinafter called "Map 'B'"), marginally numbered R.Z. 1838 annexed to this Bylaw, and in accordance with the explanatory legend, notations, references and boundaries designated, described, delimited and specified in particularity shown upon said Map 'B', and the various boundaries and districts shown upon said Map 'B', respectively are an amendment of and in substitution for the respective districts, designated and marked on said Map 'A' insofar as the same are changed, modified or varied thereby, and the said Map 'A' shall be deemed to be and is hereby declared to be amended accordingly and the said Map 'B' is hereby declared to be and shall form an integral part of said Map 'A' as if originally incorporated therein and shall be interpreted accordingly.

Read a first time this	26th	day of	NOVEMBER	1990
Read a second time this	14th	day of	JANUARY	1991
Read a third time this	28th	day of	JANUARY	1991
Reconsidered and adopted this	4th	day of	FEBRUARY	1991

MAYOR

CLERK

BYLAW NUMBER 9502

BEING A BYLAW TO AMEND

RZ #51/90

BYLAW NUMBER 4742 BEING THE BURNABY ZONING BYLAW 1965

E) CAMERON DISTRICT PARK

PROPERTY REZONED TO:

P3 PARK AND PUBLIC USE DISTRICT

LEGAL: (PLEASE SEE ATTACHED APPENDIX)

MAP "B"

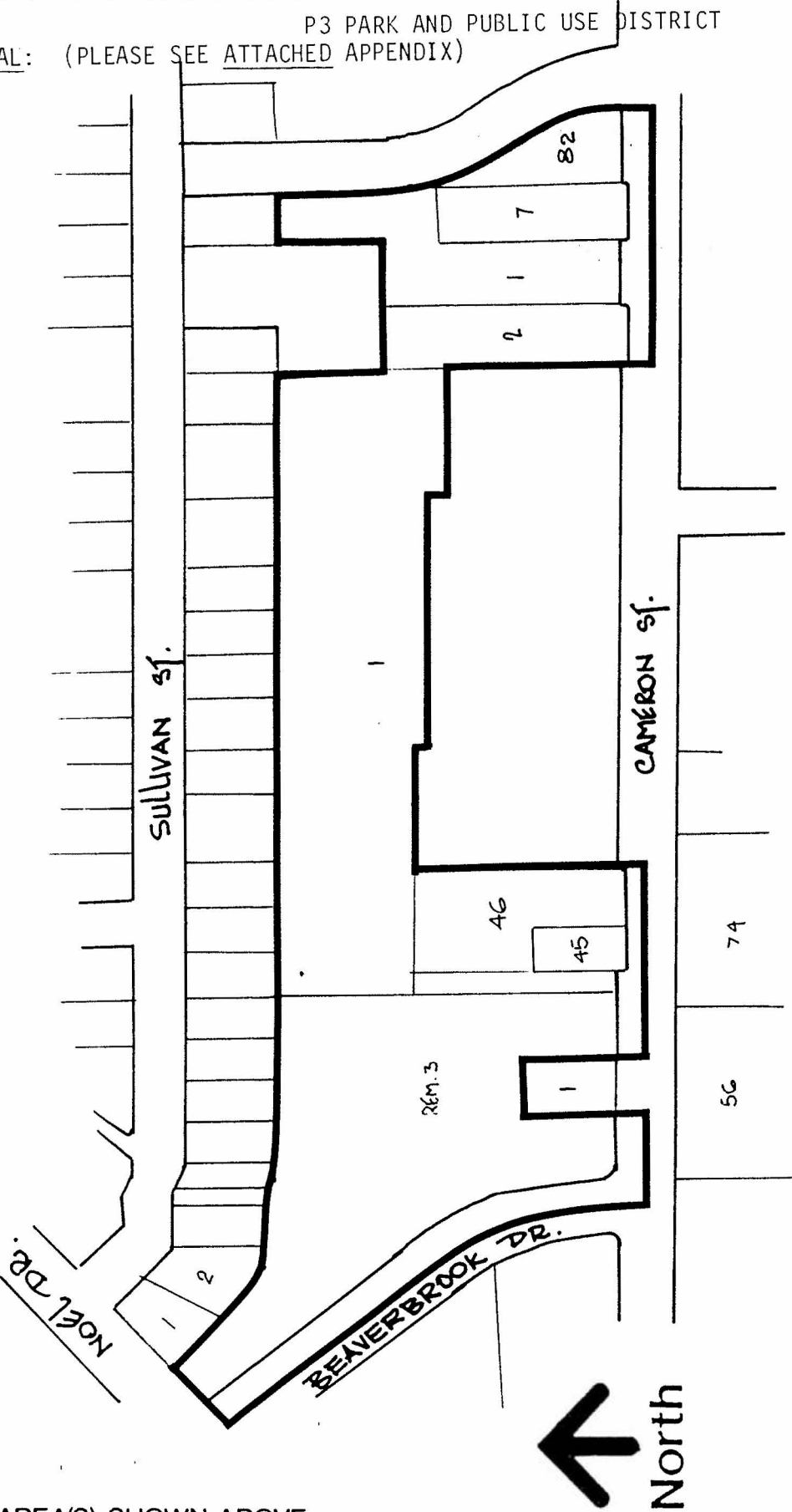

THE AREA(S) SHOWN ABOVE
OUTLINED IN BLACK (—)
IS (ARE) REZONED: FROM: R2 RESIDENTIAL DISTRICT
TO: P3 PARK AND PUBLIC USE DISTRICT

APPENDIX

ADDRESSES AND LEGAL DESCRIPTIONS

REZONING REFERENCE #51/90

E) CAMERON DISTRICT PARK - BYLAW #9502; AMENDMENT #69/90;

<u>ADDRESS</u>	<u>LEGAL DESCRIPTION</u>
9375 CAMERON STREET	D.L. 6, LOT 3, EXC. PL. 71915, PLAN 68479;
9423 CAMERON STREET	D.L. 6, LOT 45, PLAN 25843;
9443 CAMERON STREET	D.L. 6, LOT 46, PLAN 25843;
PORTION OF 9523 CAMERON STREET	D.L. 6, LOT 1, PLAN 70945;
9661 CAMERON STREET	D.L. 6, BLOCK 23, LOT 2, PLAN 6991;
9687 CAMERON STREET	D.L. 6, LOT 1, PLAN 69548;
9723 CAMERON STREET	D.L. 6, WEST 75' OF LOT 7, PLAN 4155;
9753 CAMERON STREET	D.L. 6, LOT 82, PLAN 64808;