

THE CORPORATION OF THE DISTRICT OF BURNABY

BYLAW NO. 9483

A BYLAW to amend Bylaw No. 4742, being
Burnaby Zoning Bylaw 1965

WHEREAS application for rezoning has been made to the Council.

AND WHEREAS the Council has held a public hearing thereon after duly giving notice of the time and place of such hearing as prescribed by Sections 956 and 957 of the Municipal Act, R.S.B.C. 1979.

NOW THEREFORE the Council of The Corporation of the District of Burnaby ENACTS as follows:

1. This Bylaw may be cited as BURNABY ZONING BYLAW 1965, AMENDMENT BYLAW NO. 63, 1990.
2. The Map (hereinafter called "Map 'A'"), attached to and forming an integral part of Bylaw No. 4742, being "Burnaby Zoning Bylaw 1965", and designated as the Official Zoning Map of The Corporation of the District of Burnaby, is hereby amended according to the Map (hereinafter called "Map 'B'"), marginally numbered R.Z. 1832, annexed to this Bylaw, and in accordance with the explanatory legend, notations, references and boundaries designated, described, delimited and specified in particularity shown upon said Map 'B'; and the various boundaries and districts shown upon said Map 'B' respectively are an amendment of and in substitution for the respective districts, designated and marked on said Map 'A' insofar as the same are changed, modified or varied thereby, and the said Map 'A' shall be deemed to be and is hereby declared to be amended accordingly and the said Map 'B' is hereby declared to be and shall form an integral part of said Map 'A', as if originally incorporated therein and shall be interpreted accordingly.

3. The Comprehensive Development Plan entitled METRO PLAZA prepared by WAISMAN DEWAR GROUT CARTER INC. and on file in the office of the Director Planning and Building Inspection, is deemed to be attached to and form part of this Bylaw and any development on the lands rezoned by this Bylaw shall be in conformity with the said Comprehensive Development Plan.

Read a first time this 5th day of November 19 90

Read a second time this 26th day of November 19 90

Read a third time this 8th day of July 19 91

Reconsidered and adopted this 24th day of August 1992



MAYOR



CLERK

BYLAW NUMBER 9483 BEING A BYLAW TO AMEND RZ #38/90
 BYLAW NUMBER 4742 BEING THE BURNABY ZONING BYLAW 1965

PROPERTY REZONED TO:

MAP "B"

CD COMPREHENSIVE DEVELOPMENT DISTRICT (BASED ON C3 GENERAL COMMERCIAL DISTRICT USE AND DENSITY AND METROTOWN DEVELOPMENT PLAN GUIDELINES, AND IN ACCORDANCE WITH THE DEVELOPMENT PLAN ENTITLED "METRO PLAZA" PREPARED BY WAISMAN DEWAR GROUT CARTER INC.).

LEGAL: LOTS A, B AND C OF D.L. 32 GROUP 1, PLAN 10500 AND LOTS 103 AND 104, D.L. 32, PLAN 27804; LOTS 9 AND REM. 10, PLAN 1229, D.L. 32

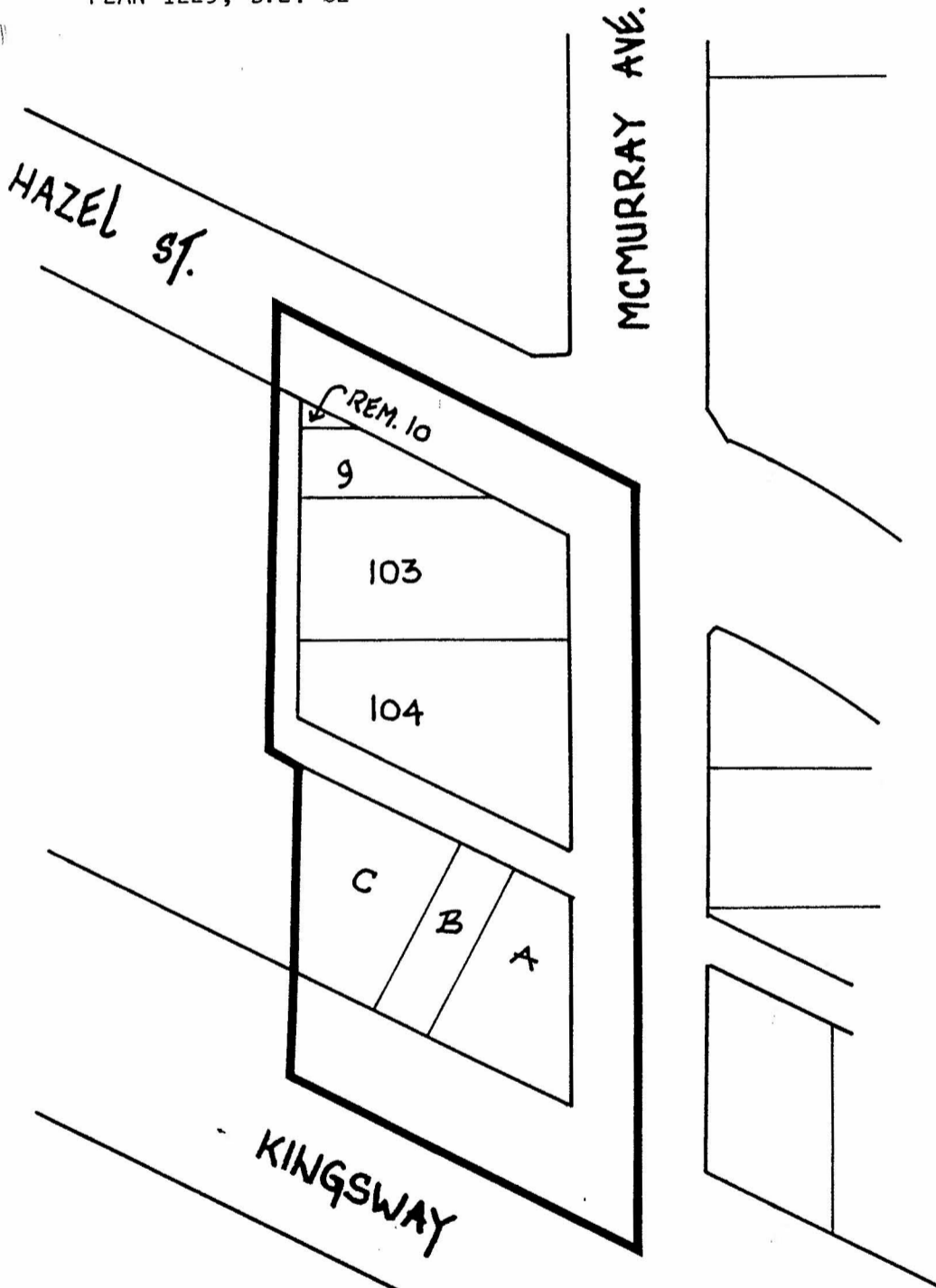

THE AREA(S) SHOWN ABOVE
 OUTLINED IN BLACK (—)
 IS (ARE) REZONED:

FROM: R5 RESIDENTIAL DISTRICT AND C3 GENERAL COMMERCIAL DISTRICT
 TO: CD COMPREHENSIVE DEVELOPMENT DISTRICT (BASED ON C3 GENERAL COMMERCIAL DISTRICT USE AND DENSITY AND METROTOWN DEVELOPMENT PLAN GUIDELINES, AND IN ACCORDANCE WITH THE DEVELOPMENT PLAN ENTITLED "METRO PLAZA" PREPARED BY WAISMAN DEWAR GROUT CARTER INC.).



PLANNING DEPARTMENT	
SCALE	1:1000
DRAWN	
DATE	OCTOBER 1990

THE CORPORATION OF THE DISTRICT OF BURNABY

OFFICIAL ZONING MAP

No. RZ 1832