

THE CORPORATION OF THE DISTRICT OF BURNABY

BYLAW NO. 9470

A BYLAW to amend Bylaw No. 4742, being Burnaby Zoning Bylaw 1965, as amended by Bylaw No. 8730, being Burnaby Zoning Bylaw 1965, Amendment Bylaw No. 24, 1987

WHEREAS application for rezoning has been made to the Council.

AND WHEREAS the Council has held a public hearing thereon after duly giving notice of the hearing as prescribed by Sections 956 and 957 of the Municipal Act R.S.B.C. 1979.

NOW THEREFORE the Council of The Corporation of the District of Burnaby ENACTS as follows:

1. This Bylaw may be cited as BURNABY ZONING BYLAW 1965, AMENDMENT BYLAW NO. 55, 1990.
2. Bylaw No. 4742, as amended by Bylaw No. 8730 is further amended by striking out Section 3 of Bylaw No. 8730 and substituting therefor the following:  
  
"3. The Comprehensive Development Plan entitled A TRAMMELL CROW DEVELOPMENT (LOUGHEED AND BOUNDARY) prepared by TTC BURNABY PROJECT LIMITED and on file in the office of the Director Planning and Building Inspection, is deemed to be attached to and form part of this Bylaw and any development on the lands rezoned by this Bylaw shall be in conformity with the said Comprehensive Development Plan."

Read a first time this	01	day of	October	1990
Read a second time this	05	day of	November	1990
Read a third time this	22	day of	July	1991
Reconsidered and adopted this	20	day of	January	1992

  
MAYOR

  
CLERK

BYLAW NUMBER 9470 BEING A BYLAW TO AMEND #107/88  
 BYLAW NUMBER 4742 BEING THE BURNABY ZONING BYLAW 1965

PROPERTY REZONED TO: "AMENDED" CD COMPREHENSIVE DEVELOPMENT DISTRICT MAP "B"  
 (BASED ON P2 ADMINISTRATION AND ASSEMBLY DISTRICT USE AND DEVELOPMENT PLAN CONCEPT GUIDELINES) AND  
 "AMENDED" CD COMPREHENSIVE DEVELOPMENT DISTRICT  
 (BASED ON M5 LIGHT INDUSTRIAL DISTRICT AND DEVELOPMENT  
 PLAN CONCEPT GUIDELINES) AND IN ACCORDANCE WITH THE  
 DEVELOPMENT PLANS ENTITLED "A TRAMMELL CROW DEVELOPMENT/  
 LOUGHEED AND BOUNDARY" PREPARED BY HAMILTON DOYLE  
 ARCHITECTS.

LEGAL: LOT 1, DISTRICT LOT 118, PLAN 76093

*Pci. 1*

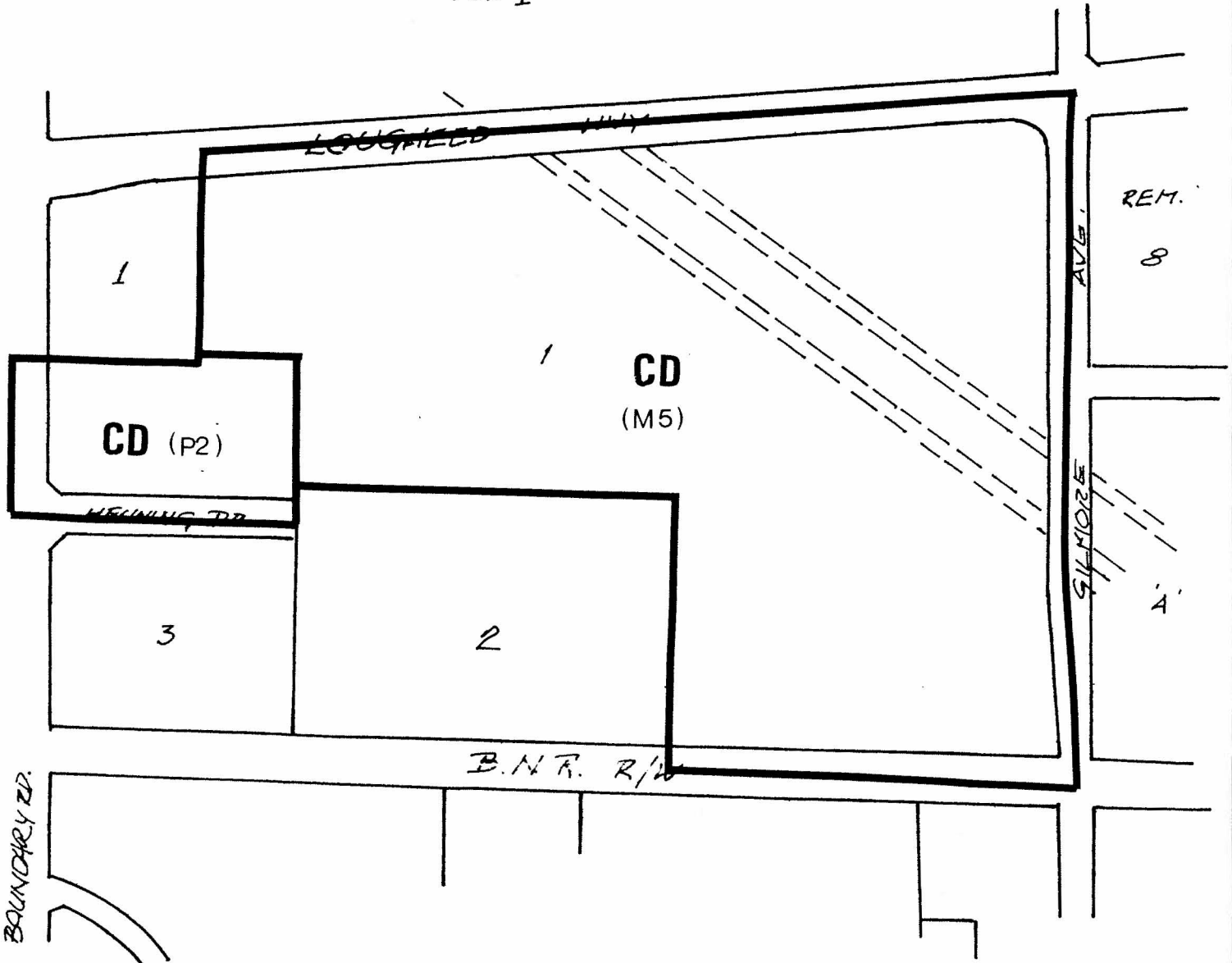

THE AREA(S) SHOWN ABOVE FROM: CD COMPREHENSIVE DEVELOPMENT DISTRICT  
 OUTLINED IN BLACK (—) IS (ARE) REZONED: TO: CD COMPREHENSIVE DEVELOPMENT DISTRICT (BASED

ON P2 ADMINISTRATION AND ASSEMBLY DISTRICT USE AND DEVELOPMENT PLAN CONCEPT GUIDELINES) AND CD COMPREHENSIVE DEVELOPMENT DISTRICT (BASED ON M5 LIGHT INDUSTRIAL DISTRICT AND DEVELOPMENT PLAN CONCEPT GUIDELINES) AND IN ACCORDANCE WITH THE DEVELOPMENT PLANS ENTITLED "A TRAMMELL CROW DEVELOPMENT/LOUGHEED AND BOUNDARY" PREPARED BY HAMILTON DOYLE ARCHITECTS.

PLANNING DEPARTMENT		THE CORPORATION OF THE DISTRICT OF BURNABY	
SCALE	<i>N.T.S.</i>	OFFICIAL ZONING MAP	
DRAWN			
DATE	<i>1990 OCT.</i>		
		No. RZ	1831