

THE CORPORATION OF THE DISTRICT OF BURNABY

BYLAW NO. 9447

A BYLAW to amend Bylaw No. 4742, being  
Burnaby Zoning Bylaw 1965 as  
amended by Bylaw No. 7400, being  
Burnaby Zoning Bylaw 1965,  
Amendment Bylaw No. 34, 1979

WHEREAS application for rezoning has been made to the  
Council.

AND WHEREAS the Council has held a public hearing  
thereon after duly giving notice of the time and place of such  
hearing as prescribed by Sections 956 and 957 of the Municipal  
Act, R.S.B.C. 1979.

NOW THEREFORE the Council of The Corporation of the  
District of Burnaby ENACTS as follows:

1. This Bylaw may be cited as BURNABY ZONING BYLAW 1965,  
AMENDMENT BYLAW NO. 45, 1990.
2. The Map (hereinafter called "Map 'A'"), attached to and  
forming an integral part of Bylaw No. 4742, being "Burnaby Zoning  
Bylaw 1965", and designated as the Official Zoning Map of The  
Corporation of the District of Burnaby, is hereby amended  
according to the Map (hereinafter called "Map 'B'"), marginally  
numbered R.Z. 1814, annexed to this Bylaw, and in accordance with  
the explanatory legend, notations, references and boundaries  
designated, described, delimited and specified in particularity  
shown upon said Map 'B'; and the various boundaries and  
districts shown upon said Map 'B' respectively are an amendment  
of and in substitution for the respective districts, designated  
and marked on said Map 'A' insofar as the same are changed,  
modified or varied thereby, and the said Map 'A' shall be deemed

to be and is hereby declared to be amended accordingly and the said Map 'B' is hereby declared to be and shall form an integral part of said Map 'A', as if originally incorporated therein and shall be interpreted accordingly.

Read a first time this 13th day of AUGUST 1990

Read a second time this 4th day of SEPTEMBER 1990

Read a third time this 10th day of SEPTEMBER 1990

Reconsidered and adopted this 17th day of SEPTEMBER 1990

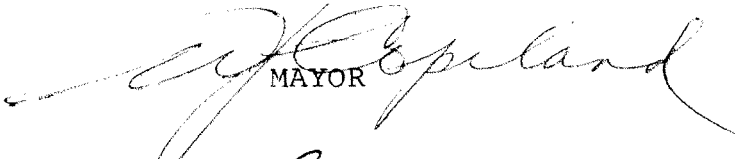
  
MAYOR

  
CLERK

BYLAW NUMBER 9447 BEING A BYLAW TO AMEND RZ #33/90  
BYLAW NUMBER 4742 BEING THE BURNABY ZONING BYLAW 1965

PROPERTY REZONED TO:

MAP "B"

"AMENDED" CD COMPREHENSIVE DEVELOPMENT DISTRICT  
(BASED ON C3a GENERAL COMMERCIAL DISTRICT GUIDELINES)

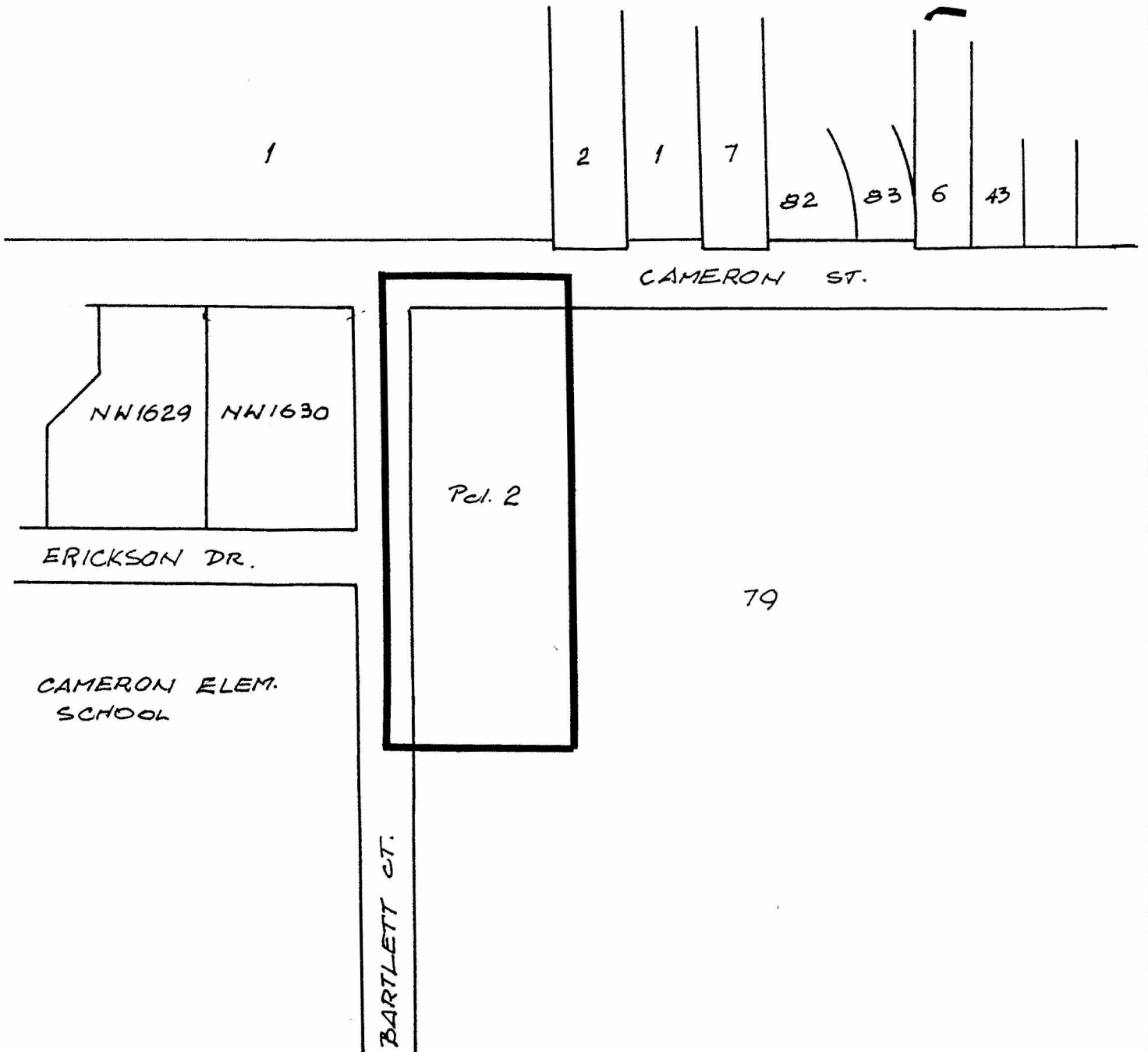

THE AREA(S) SHOWN ABOVE  
OUTLINED IN BLACK (—)  
IS (ARE) REZONED:

FROM: CD COMPREHENSIVE DEVELOPMENT DISTRICT  
(BASED ON C3 GENERAL COMMERCIAL DISTRICT GUIDELINES)

TO: CD COMPREHENSIVE DEVELOPMENT DISTRICT  
(BASED ON C3a GENERAL COMMERCIAL DISTRICT GUIDELINES)



PLANNING DEPARTMENT	
SCALE	1:2000
DRAWN	E.P.
DATE	1990 AUG

THE CORPORATION OF THE DISTRICT OF BURNABY

OFFICIAL ZONING MAP

No. RZ 1814