

THE CORPORATION OF THE DISTRICT OF BURNABY

BYLAW NO. 9422

A BYLAW to amend Bylaw No. 4742, being
Burnaby Zoning Bylaw 1965

WHEREAS application for rezoning has been made to the Council.

AND WHEREAS the Council has held a public hearing thereon after duly giving notice of the time and place of such hearing as prescribed by Sections 956 and 957 of the Municipal Act, R.S.B.C. 1979.

NOW THEREFORE the Council of The Corporation of the District of Burnaby ENACTS as follows:

1. This Bylaw may be cited as BURNABY ZONING BYLAW 1965, AMENDMENT BYLAW NO. 39, 1990.
2. The Map (hereinafter called "Map 'A'"), attached to and forming an integral part of Bylaw No. 4742, being "Burnaby Zoning Bylaw 1965", and designated as the Official Zoning Map of The Corporation of the District of Burnaby, is hereby amended according to the Map (hereinafter called "Map 'B'"), marginally numbered R.Z. 1810, annexed to this Bylaw, and in accordance with the explanatory legend, notations, references and boundaries designated, described, delimited and specified in particularity shown upon said Map 'B'; and the various boundaries and districts shown upon said Map 'B' respectively are an amendment of and in substitution for the respective districts, designated and marked on said Map 'A' insofar as the same are changed, modified or varied thereby, and the said Map 'A' shall be deemed to be and is hereby declared to be amended accordingly and the said Map 'B' is hereby declared to be and shall form an integral part of said Map 'A', as if originally incorporated therein and shall be interpreted accordingly.

BYLAW NUMBER 9422 BEING A BYLAW TO AMEND RZ #100/89
 BYLAW NUMBER 4742 BEING THE BURNABY ZONING BYLAW 1965

PROPERTY REZONED TO:

MAP "B"

CD COMPREHENSIVE DEVELOPMENT DISTRICT (BASED ON OAKALLA DEVELOPMENT PLAN GUIDELINES) AND P3 PARK AND PUBLIC USE DISTRICT.

LEGAL: PARCEL F EXCEPT PART SUBDIVIDED BY PLAN 56859, DISTRICT LOTS 83, 84, 93 AND 94, REF. PLAN 55300; PART OF PARCEL C (427684E), GROUP 1, DISTRICT LOT 94.

OAKALLA TRISON FARM

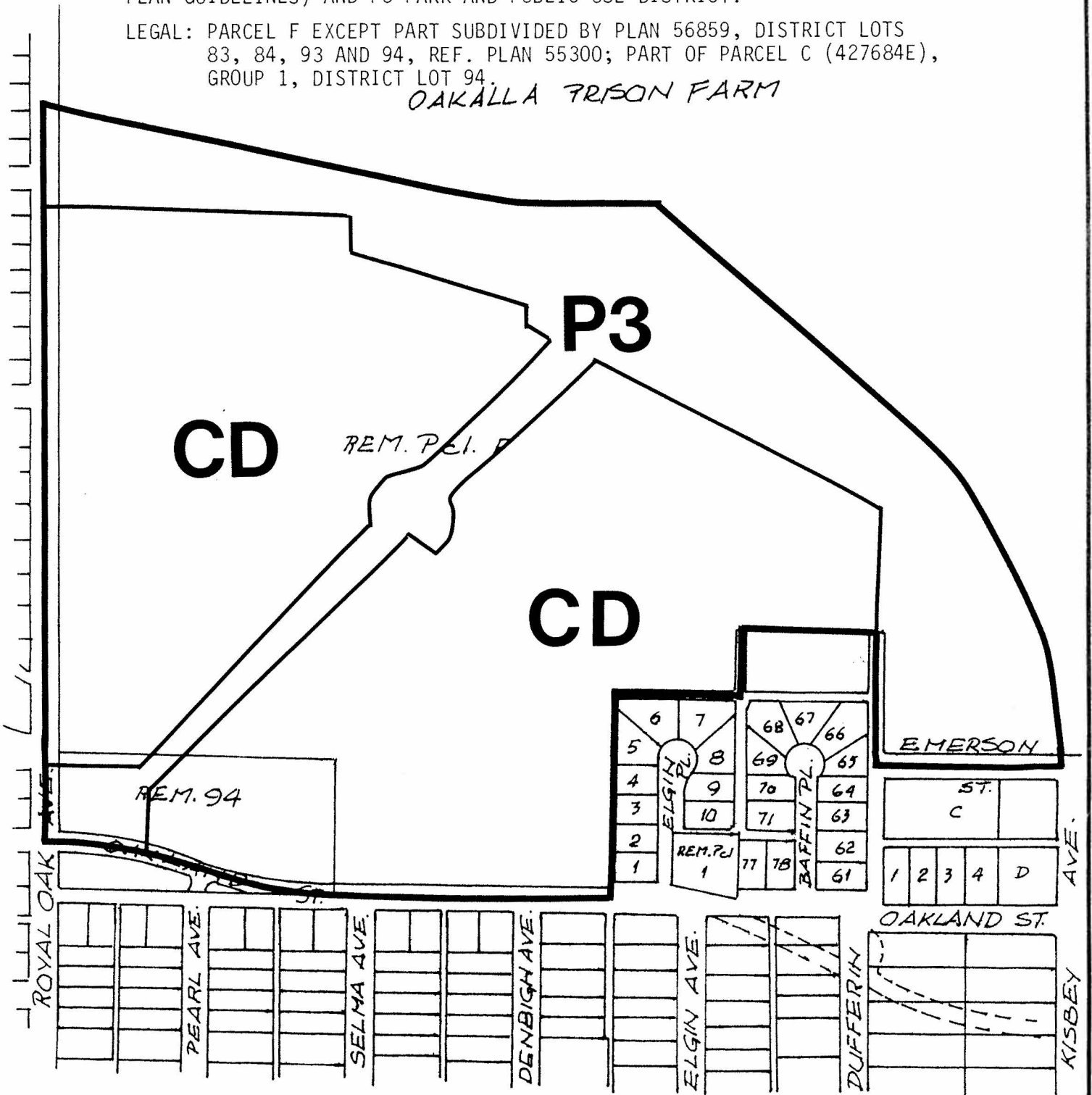

THE AREA(S) SHOWN ABOVE
 OUTLINED IN BLACK (—)
 IS (ARE) REZONED:

FROM: P6 REGIONAL INSTITUTIONAL DISTRICT AND
 R4 RESIDENTIAL DISTRICT

TO: CD COMPREHENSIVE DEVELOPMENT DISTRICT
 (BASED ON OAKALLA DEVELOPMENT PLAN GUIDELINES)
 AND P3 PARK AND PUBLIC USE DISTRICT.



PLANNING DEPARTMENT	THE CORPORATION OF THE DISTRICT OF BURNABY	
SCALE N.T.S.	OFFICIAL ZONING MAP No. RZ 1810	
RAWN E.P.		
DATE 1990 JULY		