

THE CORPORATION OF THE DISTRICT OF BURNABY

BYLAW NO. 9343

A BYLAW to amend Bylaw No. 4742, being Burnaby Zoning Bylaw 1965, as amended by Bylaw No. 8958, being Burnaby Zoning Bylaw 1965, Amendment Bylaw No. 15, 1988

WHEREAS application for rezoning has been made to the Council.

AND WHEREAS the Council has held a public hearing thereon after duly giving notice of the hearing as prescribed by Sections 956 and 957 of the Municipal Act R.S.B.C. 1979.

NOW THEREFORE the Council of The Corporation of the District of Burnaby ENACTS as follows:

1. This Bylaw may be cited as BURNABY ZONING BYLAW 1965, AMENDMENT BYLAW NO. 9, 1990.
2. Bylaw No. 4742, as amended by Bylaw No. 8958 is further amended by striking out Section 3 of Bylaw No. 8958 and substituting therefor the following:

"3. The Comprehensive Development Plan entitled CARIBOO HEIGHTS PROPOSED TOWNHOUSE DEVELOPMENT - SITE 7C prepared by OBERTO OBERTI INC. and on file in the office of the Director Planning and Building Inspection, is deemed to be attached to and form part of this Bylaw and any development on the lands rezoned by this Bylaw shall be in conformity with the said Comprehensive Development Plan."

Read a first time this	29th	day of	JANUARY	1990
Read a second time this	26th	day of	FEBRUARY	1990
Read a third time this	19th	day of	MARCH	1990
Reconsidered and adopted this	11th	day of	JUNE	1990

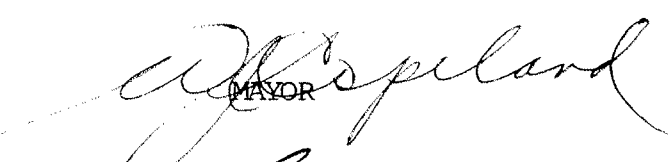
MAYOR

CLERK

BYLAW NUMBER 9343 BEING A BYLAW TO AMEND RZ #97/89
 BYLAW NUMBER 4742 BEING THE BURNABY ZONING BYLAW 1965

PROPERTY REZONED TO:

MAP "B"

(AMENDED) CD COMPREHENSIVE DEVELOPMENT DISTRICT
 (BASED ON CARIBOO COMMUNITY PLAN GUIDELINES)

LEGAL: LOT 2, D.L. 13, PLAN 81254

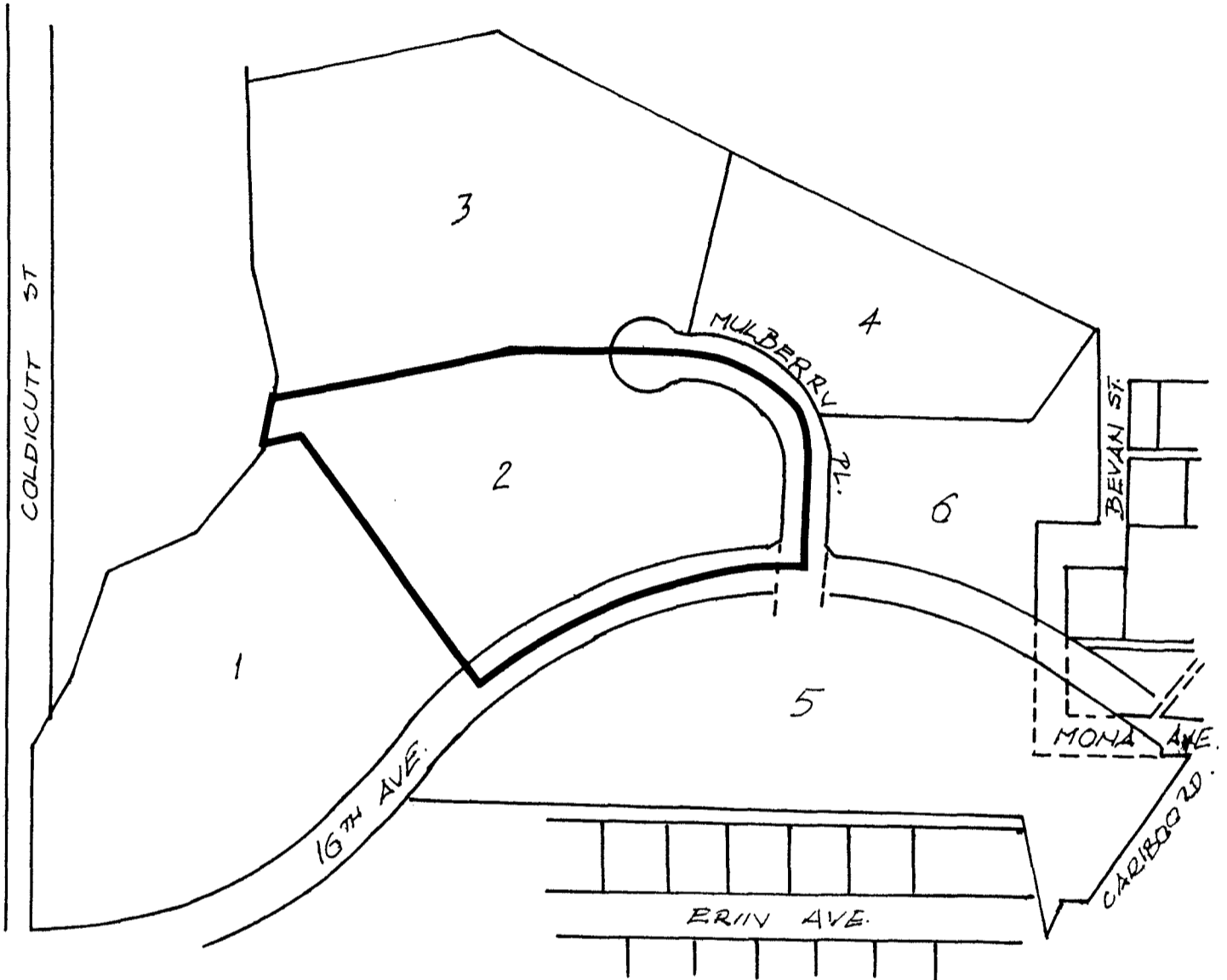

THE AREA(S) SHOWN ABOVE
 OUTLINED IN BLACK (—) IS (ARE) REZONED:

FROM: CD COMPREHENSIVE DEVELOPMENT DISTRICT
 (BASED ON CARIBOO COMMUNITY PLAN GUIDELINES)
 TO: CD COMPREHENSIVE DEVELOPMENT DISTRICT
 (BASED ON CARIBOO COMMUNITY PLAN GUIDELINES)



PLANNING DEPARTMENT	THE CORPORATION OF THE DISTRICT OF BURNABY	
SCALE N.F.S.	OFFICIAL ZONING MAP No. RZ 1783	
DRAWN E.P.		
DATE 1990 FEB.		