

THE CORPORATION OF THE DISTRICT OF BURNABY

BYLAW NO. 9342

A BYLAW to amend Bylaw No. 4742, being Burnaby Zoning Bylaw 1965, as amended by Bylaw No. 8107, being Burnaby Zoning Bylaw 1965, Amendment Bylaw No. 50, 1983

WHEREAS application for rezoning has been made to the Council.

AND WHEREAS the Council has held a public hearing thereon after duly giving notice of the hearing as prescribed by Sections 956 and 957 of the Municipal Act R.S.B.C. 1979.

NOW THEREFORE the Council of The Corporation of the District of Burnaby ENACTS as follows:

1. This Bylaw may be cited as BURNABY ZONING BYLAW 1965, AMENDMENT BYLAW NO. 8, 1990.

2. Bylaw No. 4742, as amended by Bylaw No. 8107 is further amended by striking out Section 3 of Bylaw No. 8107 and substituting therefor the following:

"3. The Comprehensive Development Plan entitled MOUNTAINSIDE VILLAGE prepared by NEIL J. PELMAN and on file in the office of the Director Planning and Building Inspection, is deemed to be attached to and form part of this Bylaw and any development on the lands rezoned by this Bylaw shall be in conformity with the said Comprehensive Development Plan."

Read a first time this	29th	day of	JANUARY	1990
Read a second time this	26th	day of	FEBRUARY	1990
Read a third time this	9th	day of	JULY	1990
Reconsidered and adopted this	23rd	day of	JULY	1990

MAYOR

CLERK

BYLAW NUMBER 9342 BEING A BYLAW TO AMEND RZ #96/89
 BYLAW NUMBER 4742 BEING THE BURNABY ZONING BYLAW 1965

PROPERTY REZONED TO:

MAP "B"

(AMENDED) CD COMPREHENSIVE DEVELOPMENT DISTRICT
 (BASED ON C1, RM1, RM2 AND P1 USE AND DENSITY)

LEGAL: D.L. 143 AND D.L. 148, STRATA LOT 35, NW 2175

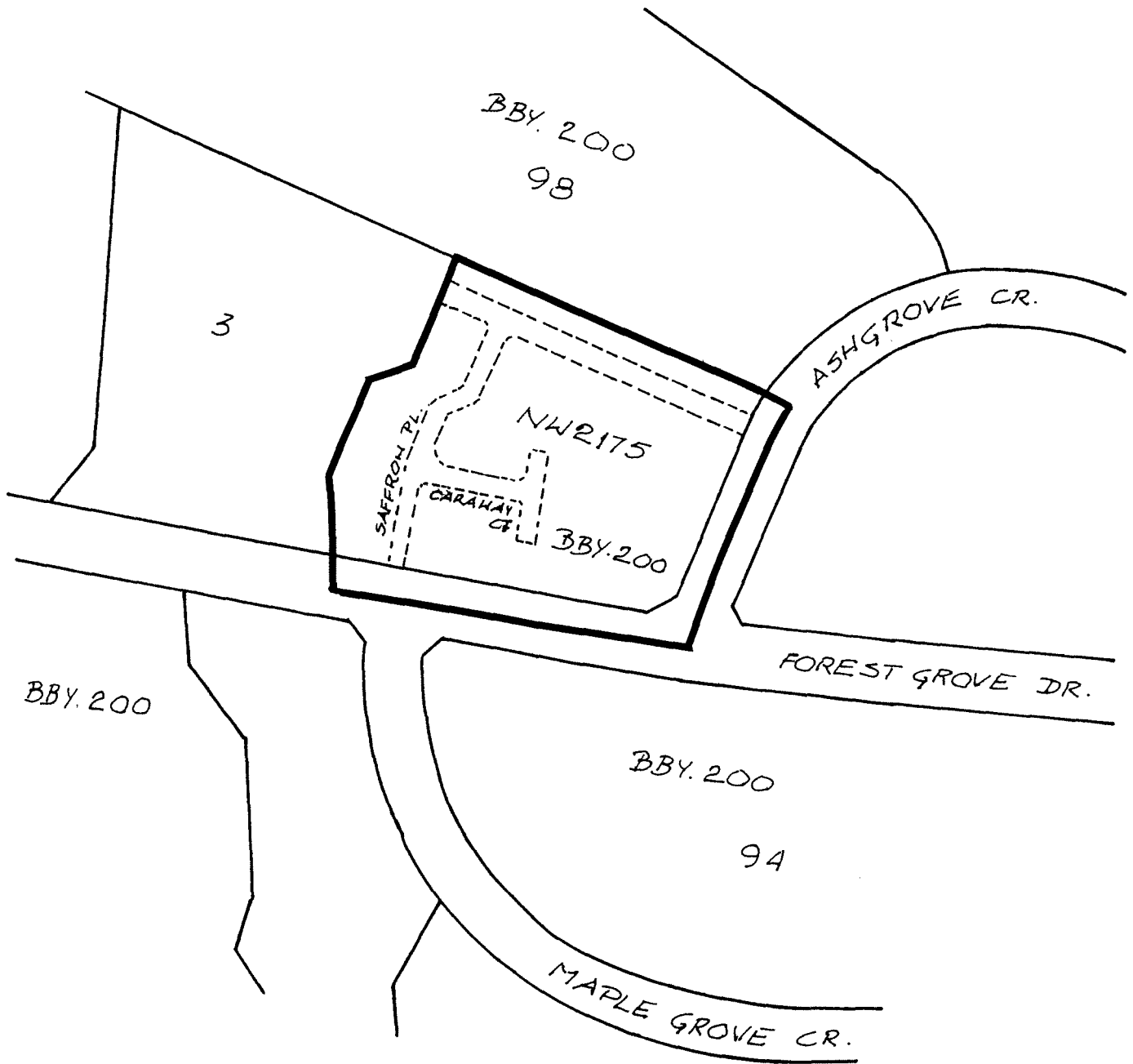

THE AREA(S) SHOWN ABOVE
 OUTLINED IN BLACK (—)
 IS (ARE) REZONED:

FROM: CD COMPREHENSIVE DEVELOPMENT DISTRICT
 (BASED ON C1, RM1 AND P1 USE AND DENSITY)

TO: CD COMPREHENSIVE DEVELOPMENT DISTRICT
 (BASED ON C1, RM1, RM2 AND P1 USE AND DENSITY)



PLANNING DEPARTMENT		THE CORPORATION OF THE DISTRICT OF BURNABY	
SCALE	1:1000	OFFICIAL ZONING MAP No. RZ 1782	
DRAWN	E.P.		
DATE	1990 FEB.		