

THE CORPORATION OF THE DISTRICT OF BURNABY

BYLAW NO. 9256



A BYLAW to reserve part of certain land for certain purposes pursuant to section 578(4) of the Municipal Act

WHEREAS the Council may by Bylaw enter into an agreement with an owner of land for reserving any part of the land for highway purposes, including the condition that the land reserved shall remain unencumbered by buildings or structures and the agreement shall have the force and effect of a restrictive covenant running with the land and shall be registered in the Land Title Office by the Municipality;

NOW THEREFORE the Council of The Corporation of the District of Burnaby ENACTS as follows:

1. This Bylaw may be cited as BURNABY HIGHWAY RESERVATION BYLAW NO. 2, 1989.
2. The Council is hereby authorized and empowered to enter into the agreement hereunto annexed with the owner of Lots 1 and 2, District Lot 130, Group 1, New Westminster District, Plan _____, for the purpose of reserving for highway purposes that part of the said lands more particularly described in the said agreement, including the condition that the lands so reserved shall remain unencumbered by buildings and structures.
3. The Municipal Clerk is hereby authorized and empowered to execute the said agreement affixing the corporate seal of the municipality thereto.

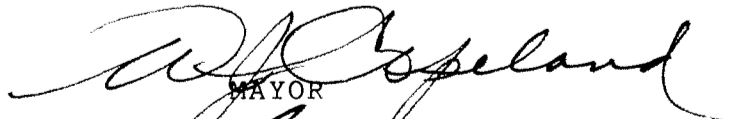
Read a first time this 8th day of AUGUST 1989
Read a second time this 8th day of AUGUST 1989
Read a third time this 8th day of AUGUST 1989
Reconsidered and adopted this 21st day of AUGUST 1989

MAYOR

CLERK

IN WITNESS WHEREOF the parties hereto have caused their corporate seals to be affixed attested by the hands of their proper signing officers as of the day and year first above written.

THE CORPORATE SEAL OF FORD MOTOR COMPANY OF CANADA, LIMITED WAS HEREUNTO AFFIXED IN THE PRESENCE OF:

Authorized Signatory

THE CORPORATE SEAL OF THE CORPORATION OF THE DISTRICT OF BURNABY WAS HEREUNTO AFFIXED IN THE PRESENCE OF:



Municipal Clerk-Authorized Signatory

THIS AGREEMENT made and entered into the day of
1989.

BETWEEN:

FORD MOTOR COMPANY OF CANADA, LIMITED
(Registration No. 662A)
2100 - 505 Burrard Street
Vancouver, B.C. V7X 1R4

(hereinafter called the "Owner")

OF THE FIRST PART

AND:

THE CORPORATION OF THE DISTRICT OF BURNABY
4949 Canada Way
Burnaby, B.C. V5G 1M2

(Hereinafter called the "Municipality")

OF THE SECOND PART

WHEREAS the Owner is the registered owner in fee simple of Lots 1 and 2, District Lot 130, Group 1, New Westminster District, Plan _____ (hereinafter called "the said lands");

AND WHEREAS pursuant to section 215 of the Land Title Act, and amendments thereto, the Municipality may enter into a covenant for the purposes set out therein;

AND WHEREAS the Owner has agreed with the Municipality to reserve part of the said lands for highway purposes;

NOW THEREFORE THIS AGREEMENT WITNESSETH that in consideration of the sum of One Dollar (\$1.00) now paid by the Municipality to the Owner (the receipt whereof is hereby acknowledged) the Owner does hereby reserve for highway purposes those portions of the said lands containing 74 m² and 2908 m², respectively, shown outlined in heavy black line on Explanatory Plan prepared by C. Wagenaar, B.C.L.S., dated June 30, 1989 (copy of which is hereunto annexed); and covenants and agrees with the Municipality that the portions of the said lands so reserved shall remain unencumbered by buildings and structures.

PLAN

DEPOSITED IN THE LAND TITLE OFFICE AT
NEW WESTMINSTER, B.C.
THIS _____ DAY OF _____ 1989.

REGISTRAR.

EXPLANATORY PLAN TO ACCOMPANY A HIGHWAY RESERVATION BYLAW OVER PORTIONS OF : LOTS 1 AND 2, DISTRICT LOT 130, GP. I, NEW WESTMINSTER DISTRICT, PLAN _____

PURSUANT TO SECTION 578(4), MUNICIPAL ACT.

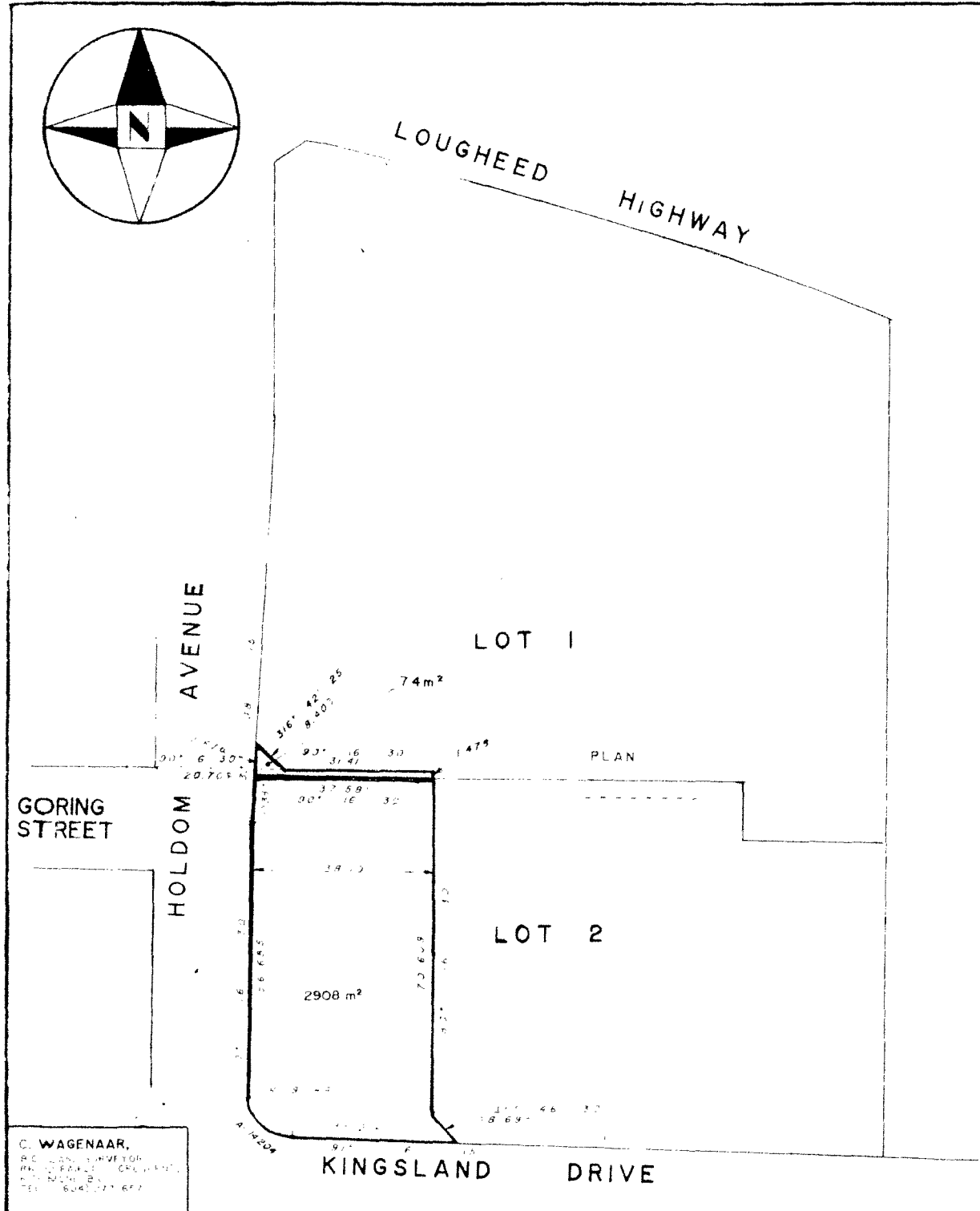

SCALE : 1 : 1000

ALL DISTANCES ARE SHOWN IN METRES.
BEARINGS ARE GRID BEARINGS AND ARE DERIVED FROM PLAN

CERTIFIED CORRECT
ACCORDING TO LAND TITLE OFFICE RECORDS
THIS 30th DAY OF June 1989

C. WAGENAAR B.C.L.S.

C. WAGENAAR,
B.C. LAND SURVEYOR
REGISTERED PROFESSIONAL
1111 BURNHAMTHORPE BLVD.
VICTORIA, B.C. V8W 2R7
TEL: 684-7776

THIS PLAN LIES WITHIN THE GREATER VANCOUVER REGIONAL DISTRICT.