

THE CORPORATION OF THE DISTRICT OF BURNABY

BYLAW NO. 9213

A BYLAW to amend Bylaw No. 4742, being Burnaby Zoning Bylaw 1965, as amended by Bylaw No. 7568, being Burnaby Zoning Bylaw 1965, Amendment Bylaw No. 42, 1980

WHEREAS application for rezoning has been made to the Council.

AND WHEREAS the Council has held a public hearing thereon after duly giving notice of the hearing as prescribed by Sections 956 and 957 of the Municipal Act R.S.B.C. 1979.

NOW THEREFORE the Council of The Corporation of the District of Burnaby ENACTS as follows:

1. This Bylaw may be cited as BURNABY ZONING BYLAW 1965, AMENDMENT BYLAW NO. 43, 1989.
2. Bylaw No. 4742, as amended by Bylaw No. 7568 is further amended by striking out Section 3 of Bylaw No. 7568 and substituting therefor the following:

"3. The Comprehensive Development Plan entitled DISCOVERY PARKS - BCIT - SITE A, OPENING LEARNING AGENCY prepared by HOWARD YANO ARCHITECTS AND POON GARDNER BILLINGTON, ARCHITECTS AND PLANNERS and on file in the office of the Director Planning and Building Inspection, is deemed to be attached to and form part of this Bylaw and any development on the lands rezoned by this Bylaw shall be in conformity with the said Comprehensive Development Plan."

Read a first time this	29th	day of	MAY	1989
Read a second time this	26th	day of	JUNE	1989
Read a third time this	29th	day of	JANUARY	1990
Reconsidered and adopted this	19th	day of	MARCH	1990

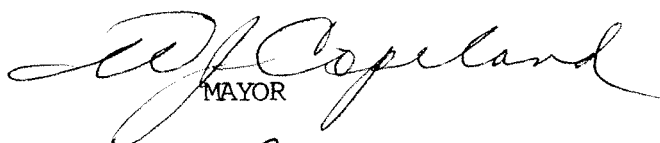
  
MAYOR

  
CLERK

BYLAW NUMBER 9213 BEING A BYLAW TO AMEND  
BYLAW NUMBER 4742 BEING THE BURNABY ZONING BYLAW 1965

PROPERTY REZONED TO: A.CD AMENDED COMPREHENSIVE DEVELOPMENT DISTRICT

LEGAL: LOT 15, DISTRICT LOT 72, PLAN 60616

MAP "B"

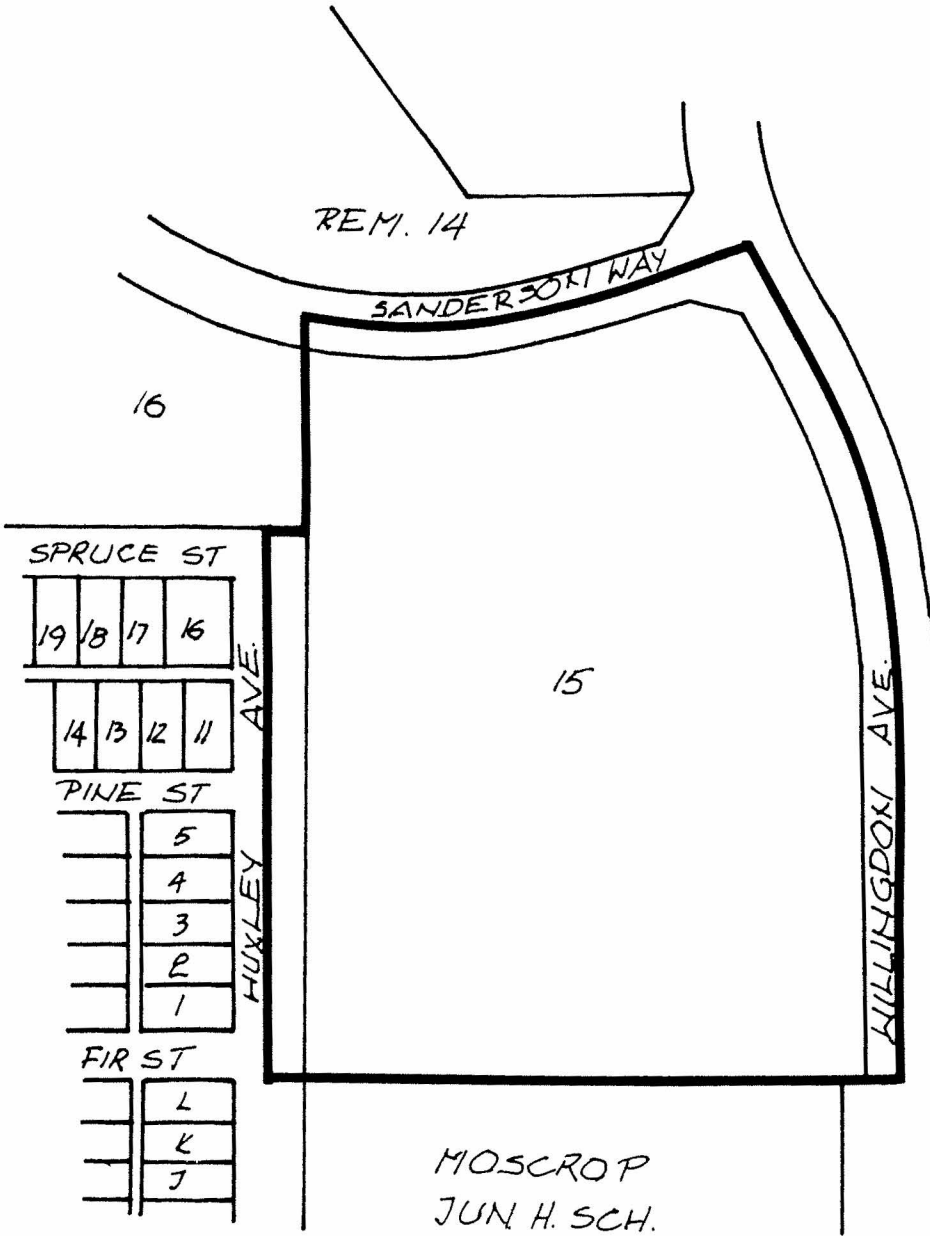

THE AREA(S) SHOWN ABOVE  
OUTLINED IN BLACK (—)  
IS (ARE) REZONED:

FROM: CD COMPREHENSIVE DEVELOPMENT DISTRICT  
(BASED ON DISCOVERY PARKS COMMUNITY PLAN)  
TO: A.CD AMENDED COMPREHENSIVE DEVELOPMENT DISTRICT  
(BASED ON ADOPTED DISCOVERY PARKS - WILLINGDON SITE -  
COMMUNITY PLAN)



PLANNING DEPARTMENT		THE CORPORATION OF THE DISTRICT OF BURNABY	
SCALE	1:2000	<h1>OFFICIAL ZONING MAP</h1> <p>No.RZ 1729</p>	
RAWN	E.P.		
DATE	MAY 1989		