

THE CORPORATION OF THE DISTRICT OF BURNABY

BYLAW NO. 9174

A BYLAW to amend Bylaw No. 4742, being Burnaby Zoning Bylaw 1965, as amended by Bylaw No. 7496, being Burnaby Zoning Bylaw 1965, Amendment Bylaw No. 14, 1980

WHEREAS application for rezoning has been made to the Council.

AND WHEREAS the Council has held a public hearing thereon after duly giving notice of the hearing as prescribed by Sections 956 and 957 of the Municipal Act R.S.B.C. 1979.

NOW THEREFORE the Council of The Corporation of the District of Burnaby ENACTS as follows:

1. This Bylaw may be cited as BURNABY ZONING BYLAW 1965, AMENDMENT BYLAW NO. 21, 1989.
2. Bylaw No. 4742, as amended by Bylaw No. 7496 is further amended by striking out Section 3 of Bylaw No. 7496 and substituting therefor the following:

"3. The Comprehensive Development Plan entitled COMPUTER SYSTEM DEVELOPMENT CENTRE prepared by POON GARDNER ARCHITECTS and on file in the office of the Director Planning and Building Inspection, is deemed to be attached to and form part of this Bylaw and any development on the lands rezoned by this Bylaw shall be in conformity with the said Comprehensive Development Plan."

Read a first time this	28th	day of	MARCH	1989
Read a second time this	24th	day of	APRIL	1989
Read a third time this	19th	day of	JUNE	1989
Reconsidered and adopted this	26th	day of	JUNE	1989

MAYOR

CLERK

BYLAW NUMBER 9174 BEING A BYLAW TO AMEND RZ #16/89
 BYLAW NUMBER 4742 BEING THE BURNABY ZONING BYLAW 1965

PROPERTY REZONED TO:

MAP B

AMENDED CD COMPREHENSIVE DEVELOPMENT DISTRICT
 (DISCOVERY PARK COMMUNITY PLAN GUIDELINES)

PORTION OF LOT 13 EXCEPT REF. PL. 70812, D.L. 71, PLAN 59477

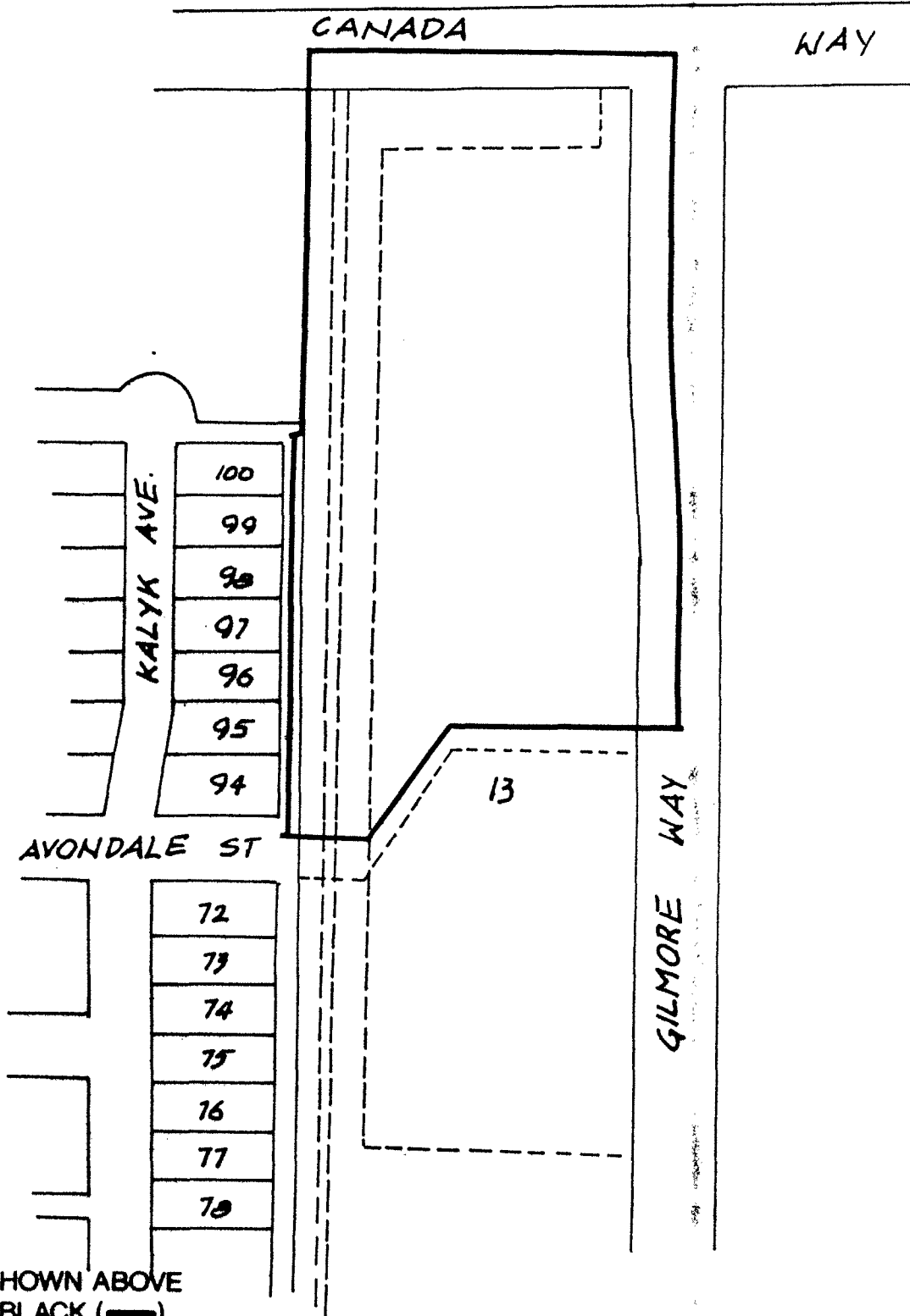

THE AREA(S) SHOWN ABOVE
 OUTLINED IN BLACK (—)
 IS (ARE) REZONED:

FROM: CD COMPREHENSIVE DEVELOPMENT DISTRICT
 TO: AMENDED CD COMPREHENSIVE DEVELOPMENT DISTRICT
 (DISCOVERY PARK COMMUNITY PLAN GUIDELINES)



PLANNING DEPARTMENT	THE CORPORATION OF THE DISTRICT OF BURNABY	
SCALE 1:2000	OFFICIAL ZONING MAP	
DRAWN E.P.		
DATE 1989 APR.		