

THE CORPORATION OF THE DISTRICT OF BURNABY

BYLAW NO. 9155

A BYLAW to amend Bylaw No. 4742, being Burnaby Zoning Bylaw 1965, as amended by Bylaw No. 8605, being Burnaby Zoning Bylaw 1965, Amendment Bylaw No. 71, 1986

WHEREAS application for rezoning has been made to the Council.

AND WHEREAS the Council has held a public hearing thereon after duly giving notice of the hearing as prescribed by Sections 956 and 957 of the Municipal Act R.S.B.C. 1979.

NOW THEREFORE the Council of The Corporation of the District of Burnaby ENACTS as follows:

1. This Bylaw may be cited as BURNABY ZONING BYLAW 1965, AMENDMENT BYLAW NO. 11, 1989.
2. Bylaw No. 4742, as amended by Bylaw No. 8605 is further amended by striking out Section 3 of Bylaw No. 8605 and substituting therefor the following:

"3. The Comprehensive Development Plan entitled PROPOSED AMENDMENTS - APARTMENT COMPONENT THE STATION SQUARE DEVELOPMENT AT METROTOWN prepared by HAMILTON, DOYLE ARCHITECTS and on file in the office of the Director Planning and Building Inspection, is deemed to be attached to and form part of this Bylaw and any development on the lands rezoned by this Bylaw shall be in conformity with the said Comprehensive Development Plan."

Read a first time this	27th	day of	FEBRUARY	1989
Read a second time this	28th	day of	MARCH	1989
Read a third time this	8th	day of	MAY	1989
Reconsidered and adopted this	23rd	day of	MAY	1989

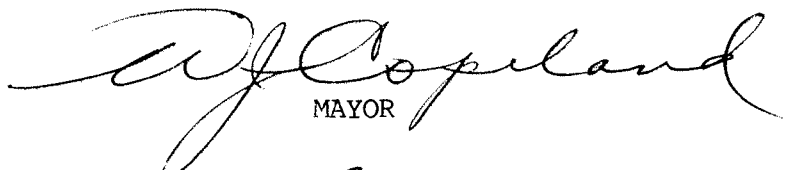
MAYOR

CLERK

BYLAW NUMBER 9155 BEING A BYLAW TO AMEND RZ #5/89
 BYLAW NUMBER 4742 BEING THE BURNABY ZONING BYLAW 1965

PROPERTY REZONED TO:

MAP "B"

AMENDED CD COMPREHENSIVE DEVELOPMENT DISTRICT
 (BASED ON C3 GENERAL COMMERCIAL DISTRICT &
 RM5 MULTIPLE FAMILY RESIDENTIAL DISTRICT GUIDELINES)

LEGAL: TOWER A: AIRSPACE PARCEL 1, D.L. 153, GROUP 1, NWD. PLAN 77784,
 PARCEL IDENTIFIED 011-089-458

TOWER B: LOT A, D.L. 153, GROUP 1, NWD, PLAN 77781

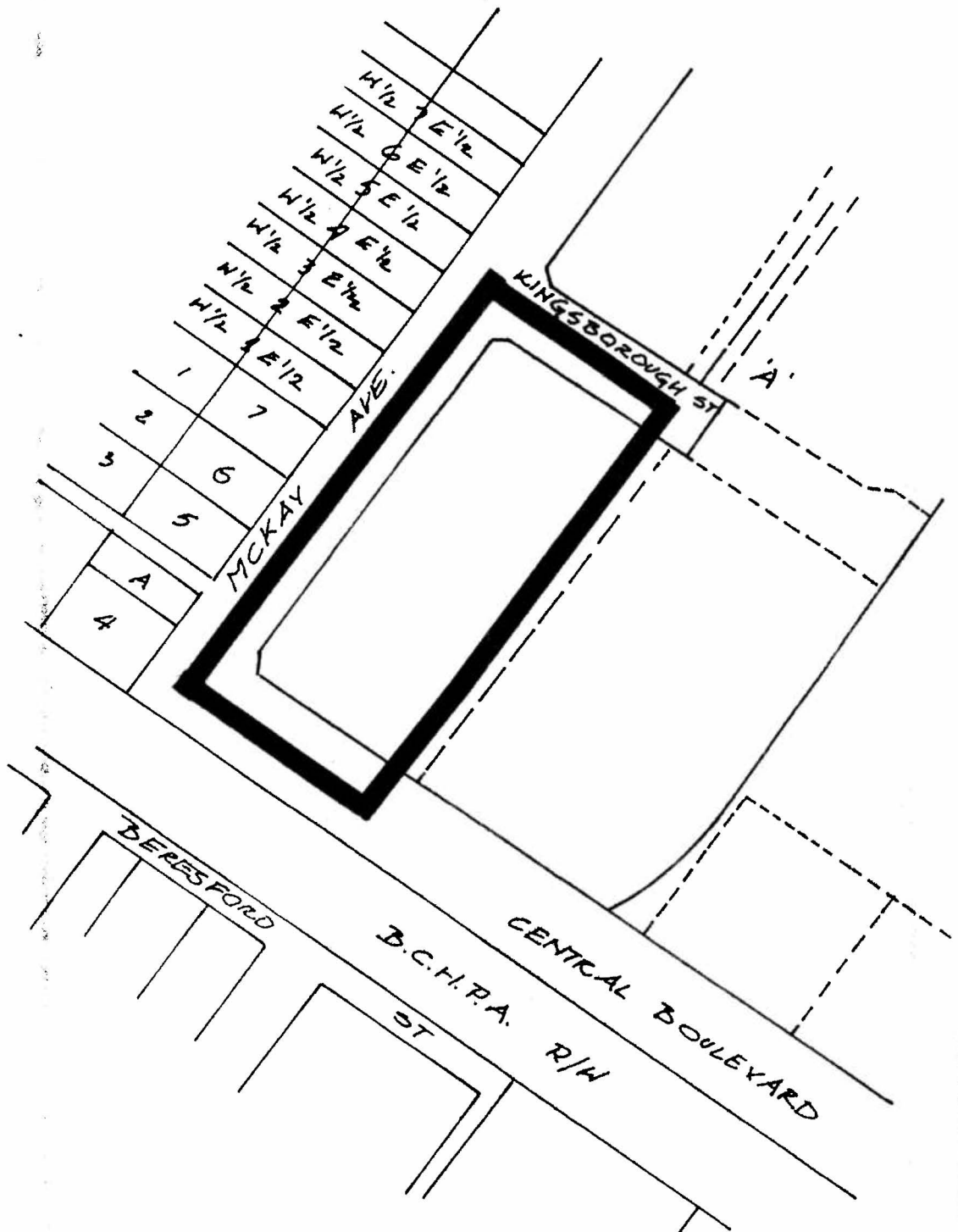

THE AREA(S) SHOWN ABOVE
 OUTLINED IN BLACK (—)
 IS (ARE) REZONED:

FROM: CD COMPREHENSIVE DEVELOPMENT DISTRICT
 (BASED ON C3 AND RM5 GUIDELINES)

TO: AMENDED CD COMPREHENSIVE DEVELOPMENT DISTRICT
 (BASED ON C3 AND RM5 GUIDELINES)



PLANNING DEPARTMENT	THE CORPORATION OF THE DISTRICT OF BURNABY	
SCALE	1:2000	OFFICIAL ZONING MAP
DRAWN	E. T.	
DATE	1989 MARCH	
		No. RZ 1700