

THE CORPORATION OF THE DISTRICT OF BURNABY

BYLAW NO. 9139

A BYLAW to amend Bylaw No. 4742, being Burnaby Zoning Bylaw 1965, as amended by Bylaw No. 8828, being Burnaby Zoning Bylaw 1965, Amendment Bylaw No. 79, 1987

WHEREAS application for rezoning has been made to the Council.

AND WHEREAS the Council has held a public hearing thereon after duly giving notice of the hearing as prescribed by Sections 956 and 957 of the Municipal Act R.S.B.C. 1979.

NOW THEREFORE the Council of The Corporation of the District of Burnaby ENACTS as follows:

1. This Bylaw may be cited as BURNABY ZONING BYLAW 1965, AMENDMENT BYLAW NO. 4, 1989.
2. Bylaw No. 4742, as amended by Bylaw No. 8828 is further amended by striking out Section 3 of Bylaw No. 8828 and substituting therefor the following:

"3. The Comprehensive Development Plan entitled MARINE WAY BUSINESS PARK prepared by CHANDLER KENNEDY ARCHITECTS, INC. and on file in the office of the Director Planning and Building Inspection, is deemed to be attached to and form part of this Bylaw and any development on the lands rezoned by this Bylaw shall be in conformity with the said Comprehensive Development Plan."

Read a first time this	30th	day of	JAN	1989
Read a second time this	27th	day of	FEB	1989
Read a third time this	29th	day of	MAY	1989
Reconsidered and adopted this	5th	day of	JUNE	1989

  
MAYOR

  
CLERK

BYLAW NUMBER 9139 BEING A BYLAW TO AMEND  
 BYLAW NUMBER 4742 BEING THE BURNABY ZONING BYLAW 1965

PROPERTY REZONED TO: AMENDED CD COMPREHENSIVE DEVELOPMENT DISTRICT  
 (BASED ON M2 GENERAL INDUSTRIAL DISTRICT/  
 M5 LIGHT INDUSTRIAL DISTRICT GUIDELINES)

LEGAL: LOT 1, DISTRICT LOT 161, PLAN 79633

MAP "B"

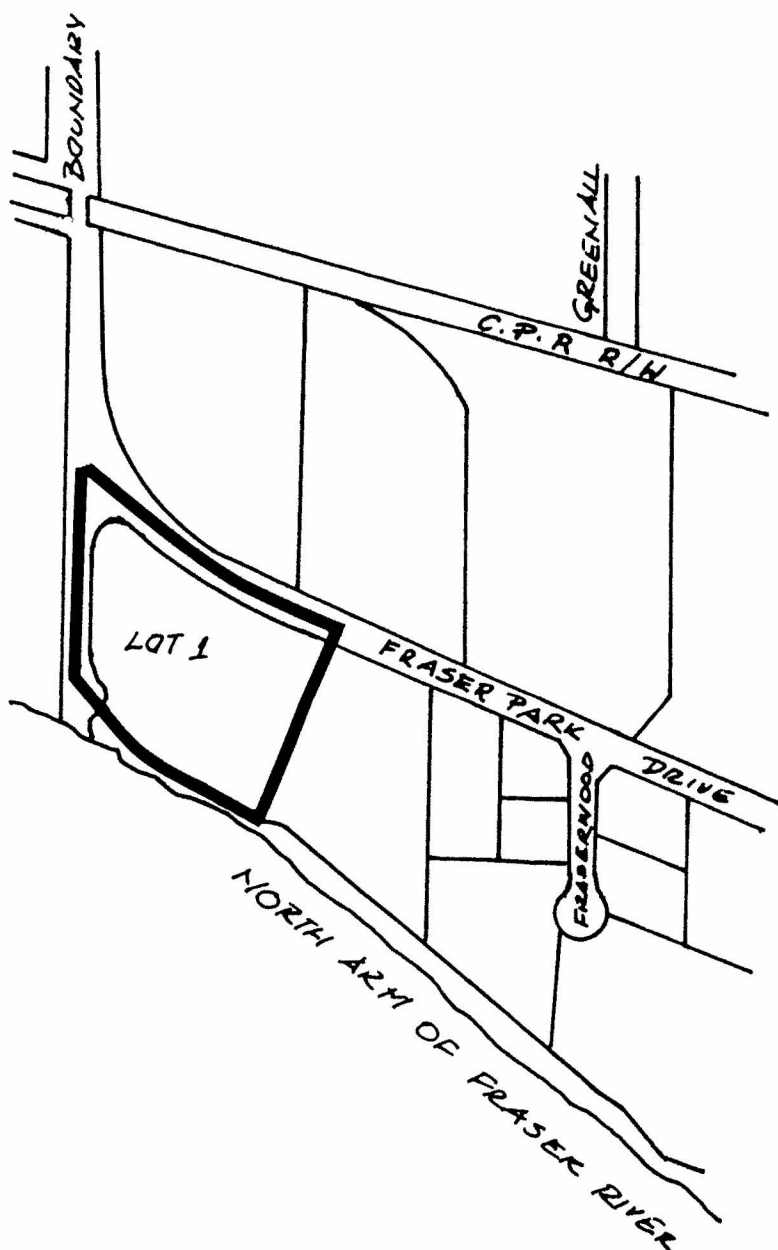

THE AREA(S) SHOWN ABOVE  
 OUTLINED IN BLACK (—)  
 IS/ (ARE) REZONED:

FROM: CD COMPREHENSIVE DEVELOPMENT DISTRICT  
 (BASED ON M2 GENERAL INDUSTRIAL DISTRICT/  
 M5 LIGHT INDUSTRIAL DISTRICT GUIDELINES)  
 TO: AMENDED CD COMPREHENSIVE DEVELOPMENT DISTRICT  
 (BASED ON M2 GENERAL INDUSTRIAL DISTRICT/  
 M5 LIGHT INDUSTRIAL DISTRICT GUIDELINES)



PLANNING DEPARTMENT	THE CORPORATION OF THE DISTRICT OF BURNABY	
SCALE	N.T.S.	OFFICIAL ZONING MAP No. RZ 1693
DRAWN	E.P.	
DATE	1989 FEB.	