

THE CORPORATION OF THE DISTRICT OF BURNABY

BYLAW NO. 9094

A BYLAW to amend Bylaw No. 4742, being Burnaby Zoning Bylaw 1965, as amended by Bylaw No. 8460, being Burnaby Zoning Bylaw 1965, Amendment Bylaw No. 70, 1985

WHEREAS application for rezoning has been made to the Council.

AND WHEREAS the Council has held a public hearing thereon after duly giving notice of the hearing as prescribed by Sections 956 and 957 of the Municipal Act R.S.B.C. 1979.

NOW THEREFORE the Council of The Corporation of the District of Burnaby ENACTS as follows:

1. This Bylaw may be cited as BURNABY ZONING BYLAW 1965, AMENDMENT BYLAW NO. 67, 1988.
2. Bylaw No. 4742, as amended by Bylaw No. 8460 is further amended by striking out Section 3 of Bylaw No. 8460 and substituting therefor the following:

"3. The Comprehensive Development Plan entitled EXPANSION OF RETAIL MALL AND OFFICE DEVELOPMENT prepared by AITKEN WREGLESWORTH ASSOCIATES and on file in the office of the Director Planning and Building Inspection, is deemed to be attached to and form part of this Bylaw and any development on the lands rezoned by this Bylaw shall be in conformity with the said Comprehensive Development Plan."

Read a first time this 26th day of SEPTEMBER 1988  
Read a second time this 24th day of OCTOBER 1988  
Read a third time this 12th day of DECEMBER 1988  
Reconsidered and adopted this 30th day of JANUARY 1989

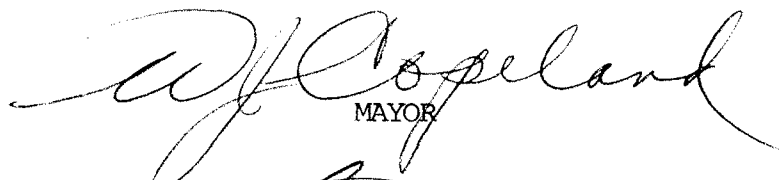
  
MAYOR

  
CLERK

BYLAW NUMBER 9094 BEING A BYLAW TO AMEND RZ #99/87  
 BYLAW NUMBER 4742 BEING THE BURNABY ZONING BYLAW 1965

PROPERTY REZONED TO:

MAP B

AMENDED CD COMPREHENSIVE DEVELOPMENT  
 (BASED ON C3, RM5 AND P2 GUIDELINES)

LOT 209 EXCEPT PART SUBDIVIDED BY PLAN 72017,  
 D.L. 153, PLAN 67065

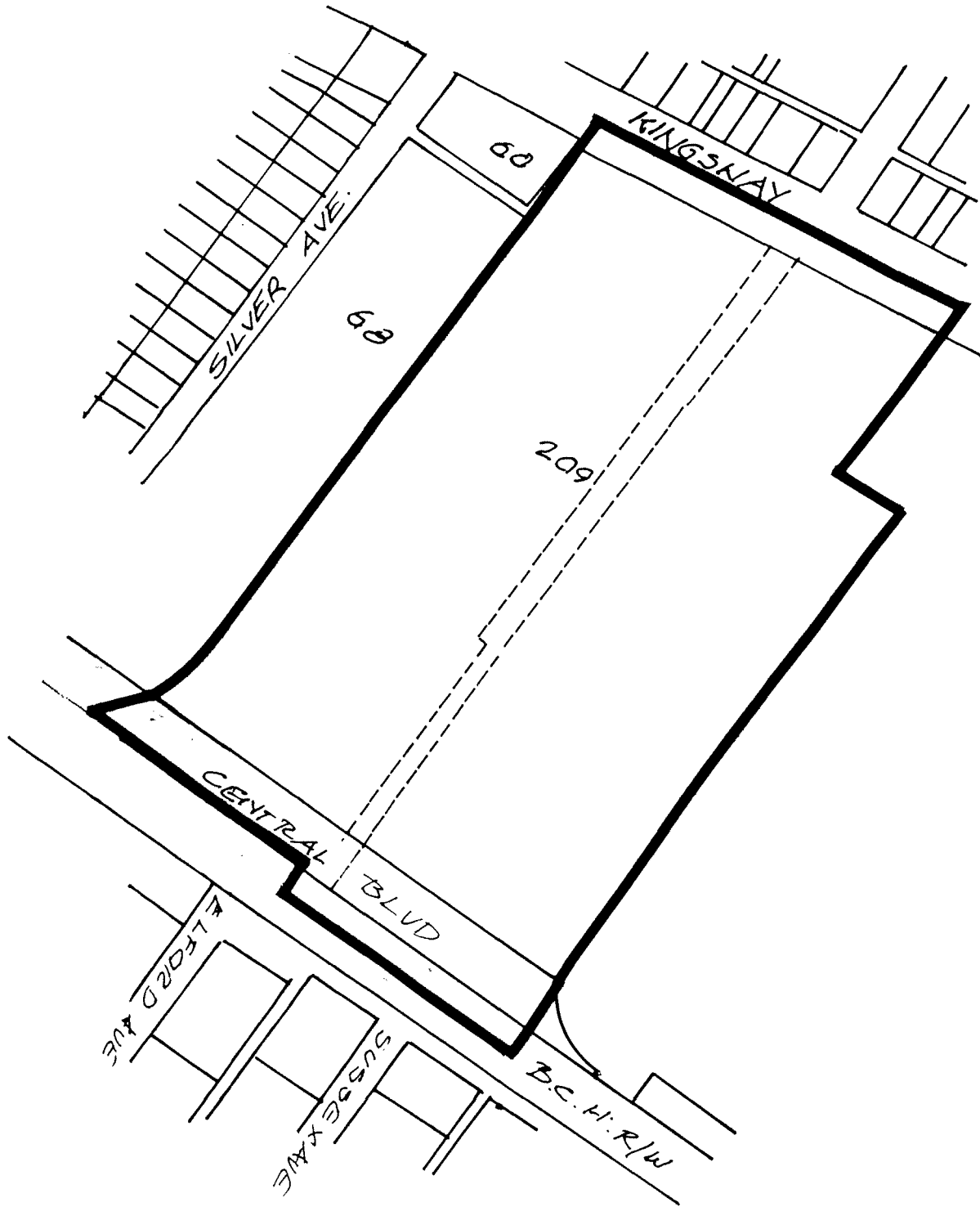

THE AREA(S) SHOWN ABOVE  
 OUTLINED IN BLACK (—)  
 IS (ARE) REZONED:

FROM: CD COMPREHENSIVE DEVELOPMENT DISTRICT  
 (BASED ON C3 GENERAL COMMERCIAL, RM5 MULTIPLE  
 FAMILY RESIDENTIAL, P2 ADMINISTRATION & ASSEMBLY  
 DISTRICT GUIDELINES) AND M1 MANUFACTURING DISTRICT  
 TO: AMENDED CD COMPREHENSIVE DEVELOPMENT DISTRICT (BASED ON C3  
 GENERAL COMMERCIAL, RM5 MULTIPLE FAMILY RESIDENTIAL AND P2  
 ADMINISTRATION AND ASSEMBLY DISTRICT GUIDELINES)



PLANNING DEPARTMENT		THE CORPORATION OF THE DISTRICT OF BURNABY	
SCALE	N.T.S.	<h1>OFFICIAL ZONING MAP</h1>	
DRAWN	E.P.		
DATE	1988 OCT.		
		No. RZ	1675