

THE CORPORATION OF THE DISTRICT OF BURNABY

BYLAW NO. 9045

A BYLAW to amend Bylaw No. 4742, being Burnaby Zoning Bylaw 1965, as amended by Bylaw No. 8830, being Burnaby Zoning Bylaw 1965, Amendment Bylaw No. 81, 1987

WHEREAS application for rezoning has been made to the Council.

AND WHEREAS the Council has held a public hearing thereon after duly giving notice of the hearing as prescribed by Sections 956 and 957 of the Municipal Act R.S.B.C. 1979.

NOW THEREFORE the Council of The Corporation of the District of Burnaby ENACTS as follows:

1. This Bylaw may be cited as BURNABY ZONING BYLAW 1965, AMENDMENT BYLAW NO. 45, 1988.

2. Bylaw No. 4742, as amended by Bylaw No. 8830 is further amended by striking out Section 3 of Bylaw No. 8830 and substituting therefor the following:

"3. The Comprehensive Development Plan entitled BOUNTY 1 HOUSING COOP prepared by WEBER AND ASSOCIATE and on file in the office of the Director Planning and Building Inspection, is deemed to be attached to and form part of this Bylaw and any development on the lands rezoned by this Bylaw shall be in conformity with the said Comprehensive Development Plan."

Read a first time this	11th	day of	JULY	1988
Read a second time this	25th	day of	JULY	1988
Read a third time this	24th	day of	OCTOBER	1988
Reconsidered and adopted this	12th	day of	DECEMBER	1988

  
MAYOR

  
DEPUTY MUNICIPAL CLERK

BYLAW NUMBER 9045 BEING A BYLAW TO AMEND  
BYLAW NUMBER 4742 BEING THE BURNABY ZONING BYLAW 1965

PROPERTY REZONED TO: AMENDED (CD) COMPREHENSIVE DEVELOPMENT DISTRICT  
PORTION OF LOT 15, DISTRICT LOT 171, PLAN 25271;  
PORTION OF LOT 71, DISTRICT LOT 171, PLAN 34756, GROUP 1, NWD.

MAP "B"

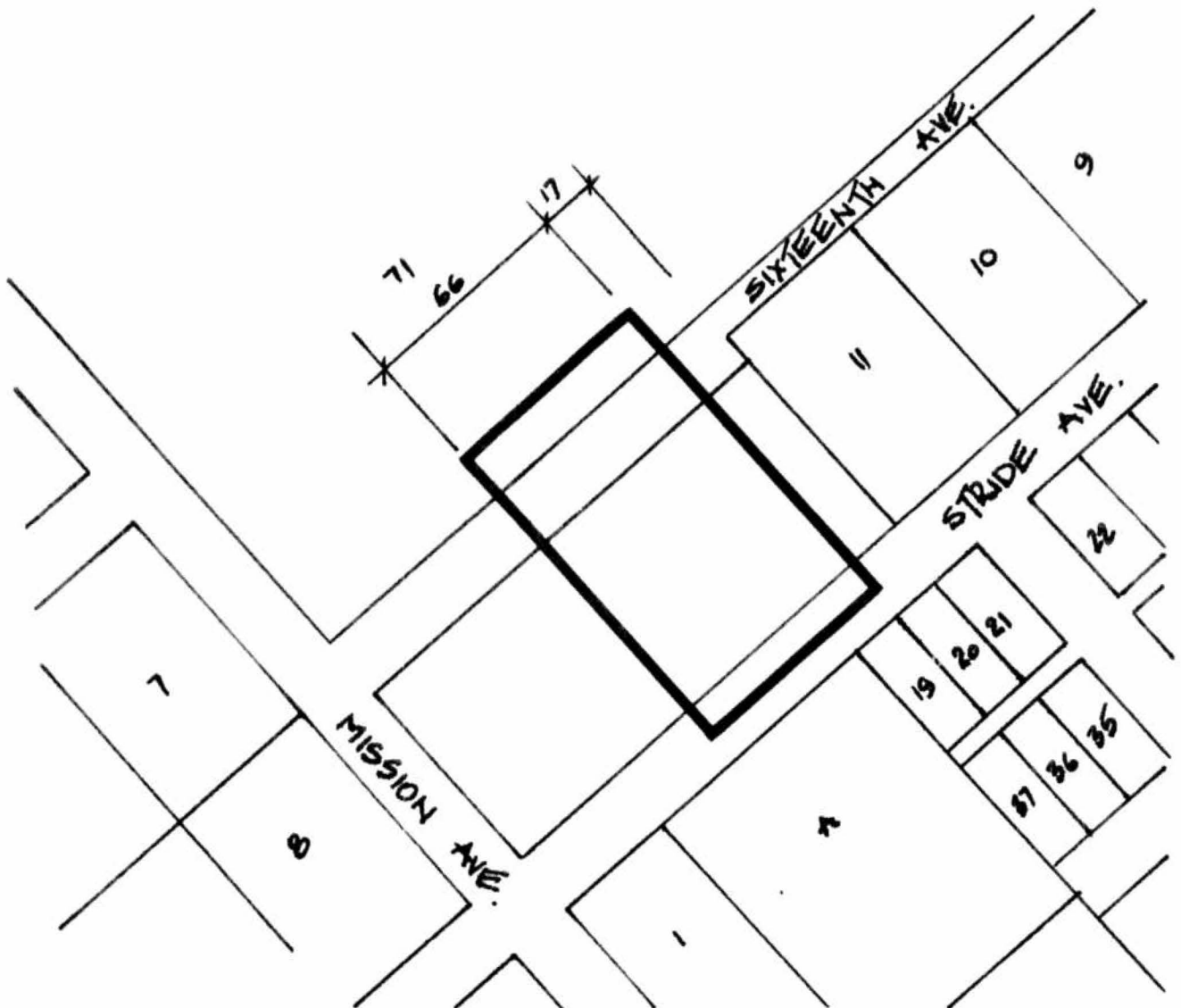

THE AREA(S) SHOWN ABOVE  
OUTLINED IN BLACK (—)  
IS (ARE) REZONED:

FROM: (CD) COMPREHENSIVE DEVELOPMENT DISTRICT  
TO: AMENDED (CD) COMPREHENSIVE DEVELOPMENT DISTRICT  
(BASED ON RM3 MULTIPLE FAMILY RESIDENTIAL DISTRICT)

PLANNING DEPARTMENT		THE CORPORATION OF THE DISTRICT OF BURNABY	
SCALE	1:2000	OFFICIAL ZONING MAP	
DRAWN	J.C.		
DATE	July 1988		
		No. RZ 1650	