

THE CORPORATION OF THE DISTRICT OF BURNABY

BYLAW NO. 8966

A BYLAW to amend Bylaw No. 4742, being  
Burnaby Zoning Bylaw 1965

WHEREAS application for rezoning has been made to the Council.

AND WHEREAS the Council has held a public hearing thereon after duly giving notice of the time and place of such hearing as prescribed by Sections 956 and 957 of the Municipal Act, R.S.B.C. 1979.

NOW THEREFORE the Council of The Corporation of the District of Burnaby ENACTS as follows:

1. This Bylaw may be cited as BURNABY ZONING BYLAW 1965, AMENDMENT BYLAW NO. 18, 1988.

2. The Map (hereinafter called "Map 'A'"), attached to and forming an integral part of Bylaw No. 4742, being "Burnaby Zoning Bylaw 1965", and designated as the Official Zoning Map of The Corporation of the District of Burnaby, is hereby amended according to the Map (hereinafter called "Map 'B'"), marginally numbered R.Z. 1624, annexed to this Bylaw, and in accordance with the explanatory legend, notations, references and boundaries designated, described, delimited and specified in particularity shown upon said Map 'B'; and the various boundaries and districts shown upon said Map 'B' respectively are an amendment of and in substitution for the respective districts, designated and marked on said Map 'A' insofar as the same are changed, modified or varied thereby, and the said Map 'A' shall be deemed to be and is hereby declared to be amended accordingly and the said Map 'B' is hereby declared to be and shall form an integral part of said Map 'A', as if originally incorporated therein and shall be interpreted accordingly.

3. The Comprehensive Development Plan represented in the report of the Director Planning & Building Inspection entitled "Rezoning of a portion of Rem. 6 except Reference Plan 14874 and except occupied portion, District Lot 85, Plan 11109 (Hart House) from P3 (Park and Public Use District) to CD (Comprehensive Development) based on P2 (Administration and Assembly District Guildelines)" dated February 23, 1988 including the sketches contained therein and on file in the office of the Director Planning and Building Inspection, is deemed to be attached to and form part of this Bylaw and any development on the lands rezoned by this Bylaw shall be in conformity with the said Comprehensive Development Plan.

Read a first time this 29th day of FEBRUARY 1988  
Read a second time this 28th day of MARCH 1988  
Read a third time this 28th day of MARCH 1988  
Reconsidered and adopted this 11th day of APRIL 1988

  
MAYOR

  
D E P U T Y C L E R K

BYLAW NUMBER 8966 BEING A BYLAW TO AMEND  
BYLAW NUMBER 4742 BEING THE BURNABY ZONING BYLAW 1965

PROPERTY REZONED TO: CD COMPREHENSIVE DEVELOPMENT DISTRICT

MAP B

Portion of Lot 6, Plan 11109, D.L.'s 85 & 79 exc. Ref. Plan 14874, Pcl. "A"

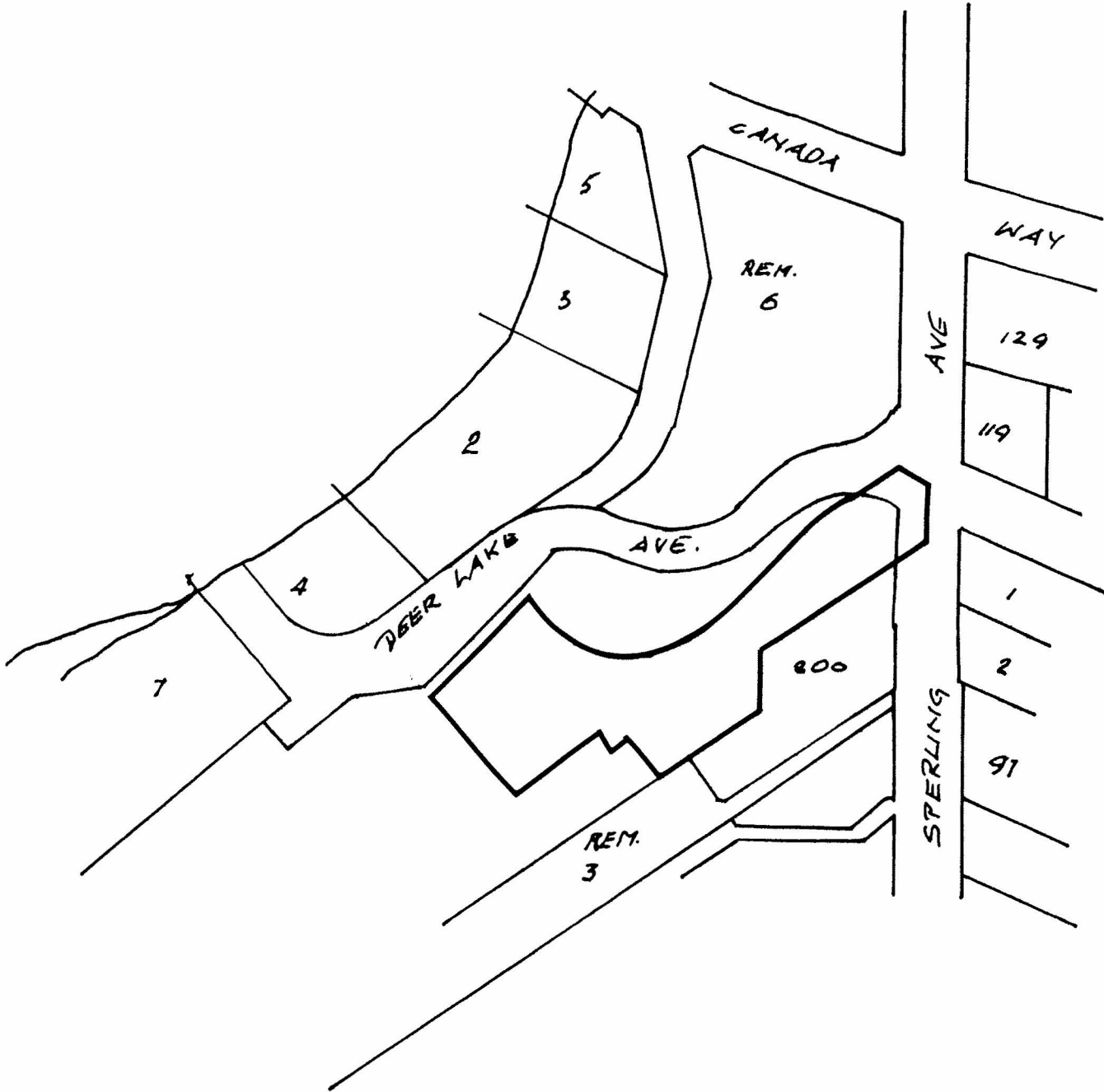

THE AREA(S) SHOWN ABOVE  
OUTLINED IN BLACK (—)  
IS (ARE) REZONED:

FROM: P3 PARK AND PUBLIC USE DISTRICT  
TO: CD COMPREHENSIVE DEVELOPMENT DISTRICT



PLANNING DEPARTMENT		THE CORPORATION OF THE DISTRICT OF BURNABY	
SCALE	1:2000	OFFICIAL ZONING MAP	
DRAWN	G.P.		
DATE	1988 FEB.		
		No. RZ 1624	