

THE CORPORATION OF THE DISTRICT OF BURNABY

BYLAW NO. 8801

A BYLAW to amend Bylaw No. 4742, being Burnaby Zoning Bylaw 1965, as amended by Bylaw No. 6441, being Burnaby Zoning Bylaw 1965, Amendment Bylaw No. 10, 1974

WHEREAS application for rezoning has been made to the Council.

AND WHEREAS the Council has held a public hearing thereon after duly giving notice of the hearing as prescribed by Sections 956 and 957 of the Municipal Act R.S.B.C. 1979.

NOW THEREFORE the Council of The Corporation of the District of Burnaby ENACTS as follows:

1. This Bylaw may be cited as BURNABY ZONING BYLAW 1965, AMENDMENT BYLAW NO. 59, 1987.

2. Bylaw No. 4742, as amended by Bylaw No. 6441 is further amended by striking out Section 3 of Bylaw No. 6441 and substituting therefor the following:

"3. The Comprehensive Development entitled COMMERCIAL/MULTIPLE FAMILY RESIDENTIAL DEVELOPMENT/KINGSWAY AND McKERCHER prepared by MELHADO, WATERLOW, ARCHITECTS and on file in the office of the Director Planning and Building Inspection, is deemed to be attached to and form part of this Bylaw and any development on the lands rezoned by this Bylaw shall be in conformity with the said Comprehensive Development Plan."

| | | | | |
|-------------------------------|------|--------|-----------|------------------|
| Read a first time this | 24th | day of | AUGUST | 1987 |
| Read a second time this | 21st | day of | SEPTEMBER | 1987 |
| Read a third time this | 25th | day of | JANUARY | 19 ⁸⁸ |
| Reconsidered and adopted this | 8th | day of | AUGUST | 19 ⁸⁸ |

ACTING MAYOR

L. Rankin

Michael J. ...
CLERK

BYLAW NUMBER 8801 BEING A BYLAW TO AMEND
BYLAW NUMBER 4742 BEING THE BURNABY ZONING BYLAW 1965

PROPERTY REZONED TO: AMENDED CD COMPREHENSIVE DEVELOPMENT DISTRICT MAP B

Lots 10, 11, & 12, D.L. 32, Group 1, Plan 2250, NWD; & Lots 13 & 14,
D.L. 32, Group 1, Plan 7662, NWD

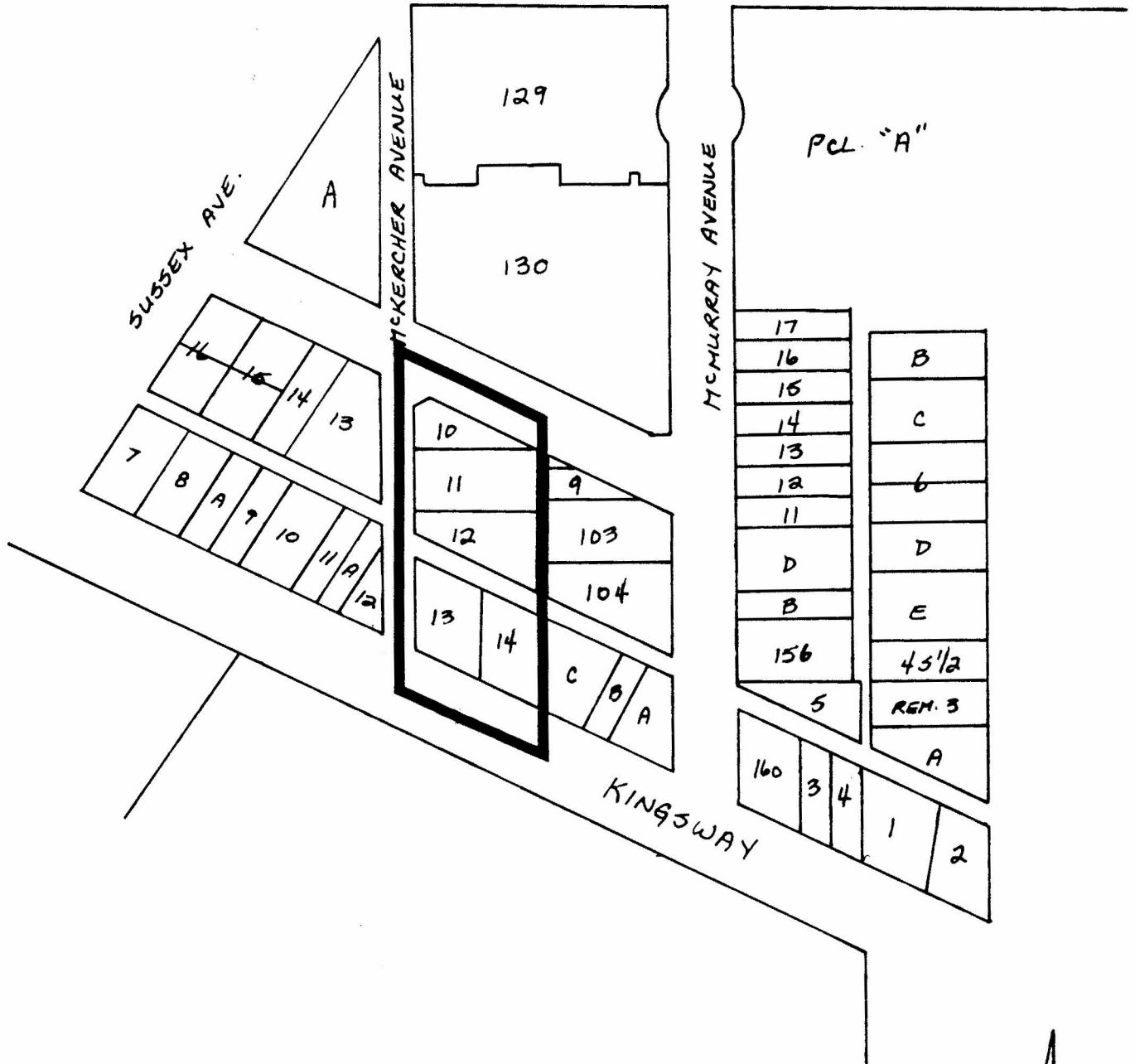

THE AREA(S) SHOWN ABOVE
OUTLINED IN BLACK (—)
IS (ARE) REZONED:

FROM: R5 RESIDENTIAL DISTRICT &
CD COMPREHENSIVE DEVELOPMENT DISTRICT

TO: AMENDED CD COMPREHENSIVE DEVELOPMENT DISTRICT

| | | | |
|---------------------|---------|--|--|
| PLANNING DEPARTMENT | | THE CORPORATION OF THE DISTRICT OF BURNABY | |
| SCALE | 1:2000 | OFFICIAL ZONING MAP 1516 No. RZ | |
| DRAWN | J.S. | | |
| DATE | 87 Aug. | | |