

THE CORPORATION OF THE DISTRICT OF BURNABY

BYLAW NO. 8797

A BYLAW to amend Bylaw No. 4742, being  
Burnaby Zoning Bylaw 1965

WHEREAS application for rezoning has been made to the Council.

AND WHEREAS the Council has held a public hearing thereon after duly giving notice of the hearing as prescribed by sections 956 and 957 of the Municipal Act R.S.B.C. 1979.

NOW THEREFORE the Council of The Corporation of the District of Burnaby ENACTS as follows:

1. This Bylaw may be cited as BURNABY ZONING BYLAW 1965, AMENDMENT BYLAW NO. 57, 1987.

2. The map (hereinafter called "Map 'A'") attached to and forming an integral part of Bylaw No. 4742, being Burnaby Zoning Bylaw 1965, and designated as the Official Zoning Map of The Corporation of the District of Burnaby, is hereby amended according to the Map (hereinafter called "Map 'B'"), marginally numbered R.Z. 1514 annexed to this Bylaw, and in accordance with the explanatory legend, notations, references and boundaries designated, described, delimited and specified in particularity shown upon said Map 'B', and the various boundaries and districts shown upon said Map 'B', respectively are an amendment of and in substitution for the respective districts, designated and marked on said Map 'A' insofar as the same are changed, modified or varied thereby, and the said Map 'A' shall be deemed to be and is hereby declared to be amended accordingly and the said Map 'B' is hereby declared to be and shall form an integral part of said Map 'A' as if originally incorporated therein and shall be interpreted accordingly.

Read a first time this 27th day of JULY 1987

Read a second time this 8th day of SEPT. 1987

Read a third time this 21st day of SEPT. 1987

Reconsidered and adopted this 28th day of SEPT. 1987

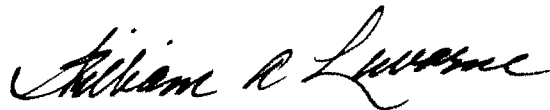

MAYOR



CLERK

BYLAW NUMBER 8797 BEING A BYLAW TO AMEND  
BYLAW NUMBER 4742 BEING THE BURNABY ZONING BYLAW 1965

PROPERTY REZONED TO: R3 RESIDENTIAL DISTRICT

MAP B

SEE ATTACHED APPENDIX "A" FOR LEGAL DESCRIPTION

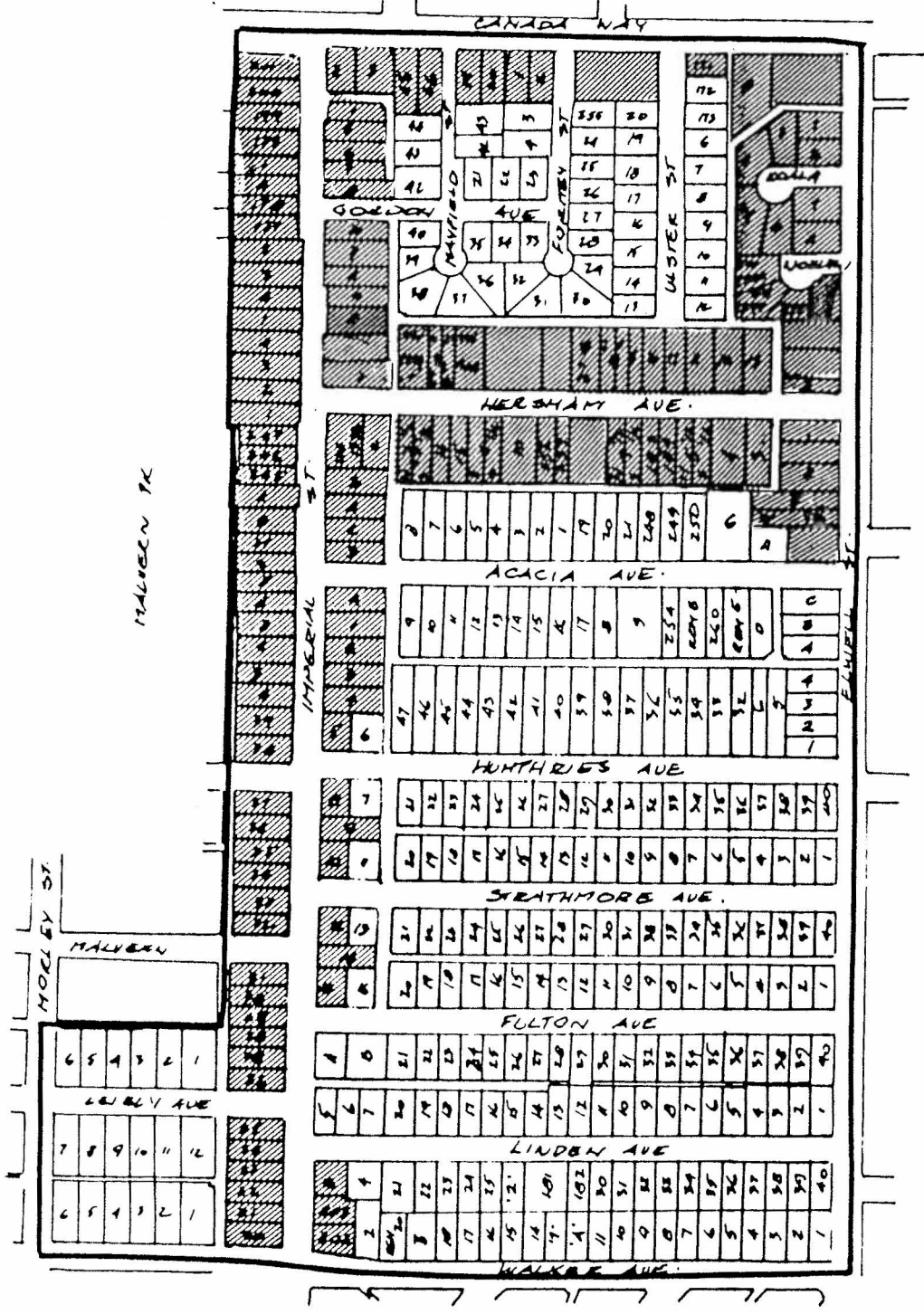

THE AREA(S) SHOWN ABOVE OUTLINED IN BLACK (—) IS (ARE) REZONED:

 - Properties excluded from rezoning amendment bylaw

FROM: R5 RESIDENTIAL DISTRICT  
TO: R3 RESIDENTIAL DISTRICT

PLANNING DEPARTMENT		THE CORPORATION OF THE DISTRICT OF BURNABY	
SCALE		<h1>OFFICIAL ZONING MAP</h1>	
DRAWN			
DATE			
		No. RZ 1514	

REZONING REFERENCE #88/87

Area bounded by Canada Way, Elwell Street, Walker Avenue, Morley Street, the R5 Residential District zoning boundary abutting the rear lot line of the properties along Leibly Avenue and the rear lot line of the properties along Imperial Street excluding:

6591 Canada Way	Lot 201, Plan 30288, D.L. 91
6618 Humphries Ave.	Lot 5, Blks. 9/13/16/21, Plan 14446, D.L. 91
6628 Acacia Avenue.	Lot "B", Blk. 8, Plan 15864, D.L. 91
6629 Acacia Avenue	Lot "A", Plan 15864, D.L. 91
6637 Canada Way	Lot 3, Plan 24182, D.L. 91
6649 Canada Way	Lot 45, Plan 16894, D.L. 91
6659 Canada Way	Lot 46, Blks. 1 - 3, Plan 16894, D.L. 91
6681 Canada Way	Lot 19, Blk. 1, Plan 534, D.L. 91
6693 Canada Way	Lot 20, Blk. 1, Plan 534, D.L. 91
6707 Canada Way	Lot 1, Blk. 2, Plan 534, D.L. 91
7661 Formby Street	Lot 2, Blk. 2, Plan 534, D.L. 91
6755 Canada Way	Lot 253, Plan 41113, D.L. 91
6811 Canada Way	Lot 171, Plan 25383
6841 Canada Way	Lot 8, Blk. 4, Plan 17673
6869 Canada Way	Pcl. A (EP14593), Lot 1, Plan 4210, D.L. 91
7309 Imperial St.	Lot 20, Plan 14446, D.L. 91
7310 Imperial St.	Lot 202, Plan 30994, D.L. 91
7317 Imperial St.	Lot 21, Blk. 16, Plan 14446, D.L. 91
7320 Imperial St.	Lot 203, Plan 30994, D.L. 91
7323 Imperial St.	Lot 22, Blk. 16, Plan 14446, D.L. 91
7329 Imperial St.	Lot 23, Plan 14446, D.L. 91
7335 Imperial St.	Lot 24, Blks. 9/13/16/21, Plan 14446, D.L. 91C
7340 Imperial St.	Lot "B", Plan 14836, D.L. 91
6569 Leibly Ave.	Lot 25, Blk. 17, Plan 14446, D.L. 91
6570 Leibly Ave.	Lot 26, Plan 14446, D.L. 91
7365 Imperial St.	Lot 27, Plan 14446, D.L. 91
7373 Imperial St.	Lot 28, Plan 14446, D.L. 91
7379 Imperial St.	Lot 29, Plan 14446, D.L. 91
7385 Imperial St.	Lot 30, Blks. 9/13/16/21, Plan 14446, D.L. 91C
7393 Imperial St.	Lot 31, Plan 14446, D.L. 91
7406 Imperial St.	Lot 15, Plan 14446, D.L. 91

7407 Imperial St.	Lot 32, Blk. 19, Plan 14446, D.L. 91
7412 Imperial St.	Lot 14, Blks. 9/13/16/21, Plan 14446, D.L. 91
7415 Imperial St.	Lot 33, Blks. 19 & 20, Plan 14446, D.L. 91
7422 Imperial St.	Lot 12, Plan 14446, D.L. 91
7423 Imperial St.	Lot 34, Blks. 9/13/16/21, Plan 14446, D.L. 91
7429 Imperial St.	Lot 35, Blks. 9/13/16/21, Plan 14446, D.L. 91
7435 Imperial St.	Lot 36, Plan 14446, D.L. 91
7436 Imperial St.	Lot 11, Plan 14446, D.L. 91
7442 Imperial St.	Lot 9, Plan 14446, D.L. 91
7443 Imperial St.	Lot 37, Plan 14446, D.L. 91
7452 Imperial St.	Lot 8, Plan 14446, D.L. 91
7459 Imperial St.	Lot 38, Blk. 21, Plan 14446, D.L. 91
7467 Imperial St.	Lot 39, Blks. 9/13/16/21, Plan 14446, D.L. 91
7474 Imperial St.	Lt 4, Blks. 9/13/16/21, Plan 14446, D.L. 91
7475 Imperial St.	Lot "A", Plan 15388, D.L. 91
7478 Imperial St.	Lot 3, Plan 14446, D.L. 91
7483 Imperial St.	Lot "B", Plan 15388, D.L. 91
7486 Imperial St.	Lot 2, Plan 14446, D.L. 91
7489 Imperial St.	Lot "C", Plan 15388, D.L. 91
7492 Imperial St.	Lot 1, Plan 14446, D.L. 91
7497 Imperial St.	Lot "D", Blks. 22/23/24, Plan 15388, D.L. 91
7503 Imperial St.	Lot "E", Plan 15388, D.L. 91
7511 Imperial St.	Lot "F", Plan 15388, D.L. 91
7516 Imperial St.	Lot "C", Blk. 8, Plan 15864, D.L. 91
7517 Imperial St.	Lot "G", Blks. 22/23/24, Plan 15388, D.L. 91
7525 Imperial St.	Lot "H", Plan 15388, D.L. 91
7526 Imperial St.	Lot "A", Blks. 6 & 7, Plan 15358, D.L. 91
7533 Imperial St.	Lot "B", Plan 15115, D.L. 91
7536 Imperial St.	Lot "B", Blk. 7, Plan 15358, D.L. 91
7541 Imperial St.	Pcl. "A" (EP13885), Lot 24, Plan 535, D.L. 91 ex. pl. B/L A32277
7551 Imperial St.	Lot 245, Plan 36451, D.L. 91
7561 Imperial St.	Lot 246, Plan 36451, D.L. 91
7567 Imperial St.	Lot 247, Plan 36451, D.L. 91
7571 Imperial St.	Lot 1, Plan 580, D.L. 91
7579 Imperial St.	Lot 2, Blk. 25, Plan 580 exc. pl. B/L A32277, D.L. 91

7584 Imperial St.	Lot 4, Plan 579 exc. pl. B/L A32277, D.L. 91
7587 Imperial St.	Lot 3 ex. pt. on filing A32277, Blk. 25, Plan 580, D.L. 91
7595 Imperial St.	Lot 4, Plan 580, D.L. 91
7605 Imperial St.	Lot 1, Blk. 26, Plan 580 exc. pl. pt. on filing A32277, D.L. 91
7606 Imperial St.	Lot "C", Blk. 5, Plan 15366, D.L. 91
7613 Imperial St.	Lot 2, Plan 580 ex. pl. filing A32277, D.L. 91
7614 Imperial St.	Lot "A" exc. pt. on filing A32277 & A53966, Plan 12628, D.L. 91
7621 Imperial St.	Lot 3, Blk. 26, Plan 580 exc. pl. B/L A32277, D.L. 91
7624 Imperial St.	Lot "B" exc. pl. B/L A32277 & A53966, Blk. 5, Plan 12628, D.L. 91
7628 Imperial St.	Lot 10, Plan 651 exc. pl. pt. on filing A32277 & A53966, D.L. 91
7629 Imperial St.	Pcl. "P", Pcl. 2, Blk. 1/2/26, expl. pl. 1396 on filing A32277, Plans 535 & 580, D.L. 91
7637 Imperial St.	Lot 177, Plan 26458, D.L. 91
7642 Imperial St.	Lot 8, Plan 651 exc. pl. B/L A32277, D.L. 91
7645 Imperial St.	Lot 178, Plan 26458, D.L. 91
7650 Imperial St.	Lot 7, Plan 651 exc. pl. filing A32277 & RP35561 (Pcl. A), D.L. 91
7653 Imperial St.	Pcl. "A" (EP14086), Plan 535, D.L. 91
7656 Imperial St.	Lot 6, Plan 651 exc. pl. pt. pl. A32277 & RP35561 (SE 20'), D.L. 91
7661 Imperial St.	Lots 1 & 2, Pcl. 1 (PE 12934) of Pcl. "P" (EP8508) exc. Pcl. "A" (EP14086), Plan 535, D.L. 91
7664 Imperial St.	Lot 5, Plan 651 ex. pt. on pl. with B/L filed A32277 and ex. Pcl. "A" (RP35561), D.L. 91
7665 Imperial St.	Lot 179, Plan 26709, D.L. 91
7669 Imperial St.	Lot 199, Plan 30288, D.L. 91
7674 Imperial St.	Lot 1, Plan 24182, D.L. 91
7677 Imperial St.	Lot 200, Plan 30288, D.L. 91
7690 Imperial St.	Lot 2, Plan 24182, D.L. 91
7578 Imperial Street	Lot "A", D.L. 91, Plan 72764
7594 Imperial Street	Lot "D", D.L. 91, Plan 15366
6615 Hersham Ave.	Lot 2, Plan NW 1332, D.L. 91
6628 Hersham Avenue	Lot 1, D.L. 91, Plan 72544
6639 Hersham Ave.	Lot 2, Plan 19837, D.L. 91
6648 Hersham Avenue	Lot 1, D.L. 91, Plan NW1224

6658 Hersham Avenue	Lot 2 NW1/2, Blk. 5, D.L. 91 S pt., Plan 2332
6668 Hersham Avenue	Pcl. "A", Lot 2, D.L. 91, Plan 2332
6676 Hersham Avenue	Lot 2, D.L. 91, Plan NW302
6692 Hersham Avenue	Lot 1, D.L. 91, Plan 71692
6704 Hersham Avenue	Lot 341, D.L. 91, Plan 63643
6708 Hersham Avenue	Lot 342, D.L. 91, Plan 63643
6712 Hersham Avenue	Lot 349, D.L. 91, Plan 69824
6716 Hersham Avenue	Lot 350, D.L. 91, Plan 69824
6740 Hersham Avenue	Lot "A" S1/2, Blk. 5, D.L. 91, Plan 11387
6754 Hersham Avenue	Pcl. "A" (566288E), Lot 8, D.L. 91, Plan 2332
6764 Hersham Avenue	Pcl. "C", Lot 8, D.L. 91, Plan 2332
6772 Hersham Avenue	Pcl. "B" (BY73868), Lot 9, D.L. 91, Plan 2332
6782 Hersham Avenue	Lot 16, D.L. 91, Plan 20691
6790 Hersham Avenue	Lot 17, Blk. 5, D.L. 91SE, Plan 20691
6812 Hersham Avenue	Lot 11, D.L. 91, Plan 2332
6828 Hersham Avenue	Lot 12, D.L. 91, Plan 2332
6840 Hersham Avenue	Lot 13, D.L. 91, Plan 2332
6649 Hersham Avenue	Lot 13 N1/2, Blk. 6, D.L. 91 S pt., Plan 2367
6659 Hersham Avenue	Lot 13 S1/2, D.L. 91, Plan 2367
6667 Hersham Avenue	Lot 14, D.L. 91, Plan 23195
6679 Hersham Avenue	Lot 15, D.L. 91, Plan 23195
6685 Hersham Avenue	Pcl. "A" of Lot 11, D.L. 91, Plan 2367
6695 Hersham Avenue	Lot 11 S1/2, D.L. 91, Plan 2367
6711 Hersham Avenue	Lot 10, D.L. 91, Plan 2367
6721 Hersham Avenue	Lot 256, D.L. 19, Plan 43486
6731 Hersham Avenue	Lot 257, D.L. 91, Plan 43486
6749 Hersham Avenue	Lot 347, D.L. 91, Plan 65100
6755 Hersham Avenue	Lot 348, D.L. 91, Plan 65100
6765 Hersham Avenue	Lot 7 N1/2, Blk. 6, D.L. 91 SE pt., Plan 2367
6777 Hersham Avenue	Lot 7 S1/2, D.L. 91, Plan 2367
6785 Hersham Avenue	Lot 183, D.L. 91, Plan 27060
6791 Hersham Avenue	Lot 184, D.L. 91, Plan 27060
6805 Hersham Avenue	Lot 5 N1/2, Blk. 6, D.L. 91 SE pt., Plan 2367
6813 Hersham Avenue	Pcl. "A", Lot 5, D.L. 91, Plan 2367
6833 Hersham Avenue	Lot 4, D.L. 91, Plan 2367

6843 Hersham Avenue	Lot 3, D.L. 91, Plan 2367
7515 Elwell Street	Lot 2 exc. Plan EP15751 (Pcl. "A"), D.L. 91, Plan 700
7523 Elwell Street	Lot 1 W1/2, D.L. 91, Plan 700
7531 Elwell Street	Pcl. "B", Lot 1, D.L. 91, Plan 700
7539 Elwell Street	Lot 2, D.L. 91, Plan 2367
7547 Elwell Street	Lot 1 W. 53.82', Blk. 6, D.L. 91, Plan 2367
7559 Elwell Street	Lot 1 exc. W. 53.82', D.L. 91, Plan 2367
7575 Elwell Street	Pcl. "A", Lot 15, D.L. 91, Plan 2332
7581 Elwell Street	Lot 346, D.L. 91, Plan 63992
7585 Elwell Street	Lot 345, D.L. 91, Plan 63992
7591 Elwell Street	Lot 343, D.L. 91, Plan 68767
7595 Elwell Street	Lot 344, D.L. 91, Plan 68767
7607 Elwell Street	Lot 2, D.L. 91, Plan 71761
7629 Elwell Street	Pcl. "A" expl. pl. 15279, Blk. 4, Plan 4210, D.L. 91
7645 Elwell Street	Lot 7, Plan 17673, D.L. 91
7657 Elwell Street	Lot 2, Plan 17673, D.L. 91
7673 Elwell Street	Lot 1, Plan 17673, D.L. 91
6845 Noelani Place	Lot 2, Plan NW 1400, D.L. 91
6855 Noelani Place	Lot 2, Plan NW 1399, D.L. 91
6865 Noelani Place	Lot 338, Plan 56677, D.L. 91
6875 Noelani Place	Lot 1, D.L. 91, Plan 71761
6840 Koala Court	Lot 4, Plan 17673, D.L. 91
6841 Koala Court	Lot 5, Plan 17673, D.L. 91
6860 Koala Court	Lot 3, Blks. 1 & 2, Plan 17673, D.L. 91
6861 Koala Court	Lot 6, Plan 17673, D.L. 91