

THE CORPORATION OF THE DISTRICT OF BURNABY

BYLAW NO. 8741

A BYLAW to amend Bylaw No. 4742, being Burnaby Zoning Bylaw 1965, as amended by Bylaw No. 7560, being Burnaby Zoning Bylaw 1965, Amendment Bylaw No. 36, 1980

WHEREAS application for rezoning has been made to the Council.

AND WHEREAS the Council has held a public hearing thereon after duly giving notice of the hearing as prescribed by Sections 956 and 957 of the Municipal Act R.S.B.C. 1979.

NOW THEREFORE the Council of The Corporation of the District of Burnaby ENACTS as follows:

1. This Bylaw may be cited as BURNABY ZONING BYLAW 1965, AMENDMENT BYLAW NO. 30, 1987.
2. Bylaw No. 4742, as amended by Bylaw No. 7560 is further amended by striking out Section 3 of Bylaw No. 7560 and substituting therefor the following:

"3. The Comprehensive Development entitled INDUSTRIAL DEVELOPMENT-PRODUCTION WAY prepared by HANSED ENGINEERING and on file in the office of the Director Planning and Building Inspection, is deemed to be attached to and form part of this Bylaw and any development on the lands rezoned by this Bylaw shall be in conformity with the said Comprehensive Development Plan."

Read a first time this	23rd	day of	MARCH	1987
Read a second time this	27th	day of	APRIL	1987
Read a third time this	8th	day of	JUNE	1987
Reconsidered and adopted this	13th	day of	JULY	1987

MAYOR *William A. Lawrence*

DEPUTY CLERK *J. [Signature]*

CERTIFIED A TRUE COPY THIS 14th DAY OF JULY 1987

DEPUTY *[Signature]*
AUTHORIZED SIGNATORY
MUNICIPAL CLERK

BYLAW NUMBER 8741 BEING A BYLAW TO AMEND
BYLAW NUMBER 4742 BEING THE BURNABY ZONING BYLAW 1965

PROPERTY REZONED TO: AMENDED CD COMPREHENSIVE DEVELOPMENT DISTRICT

Lot 89, D.L. 10, Group 1, NWD, Plan 63231

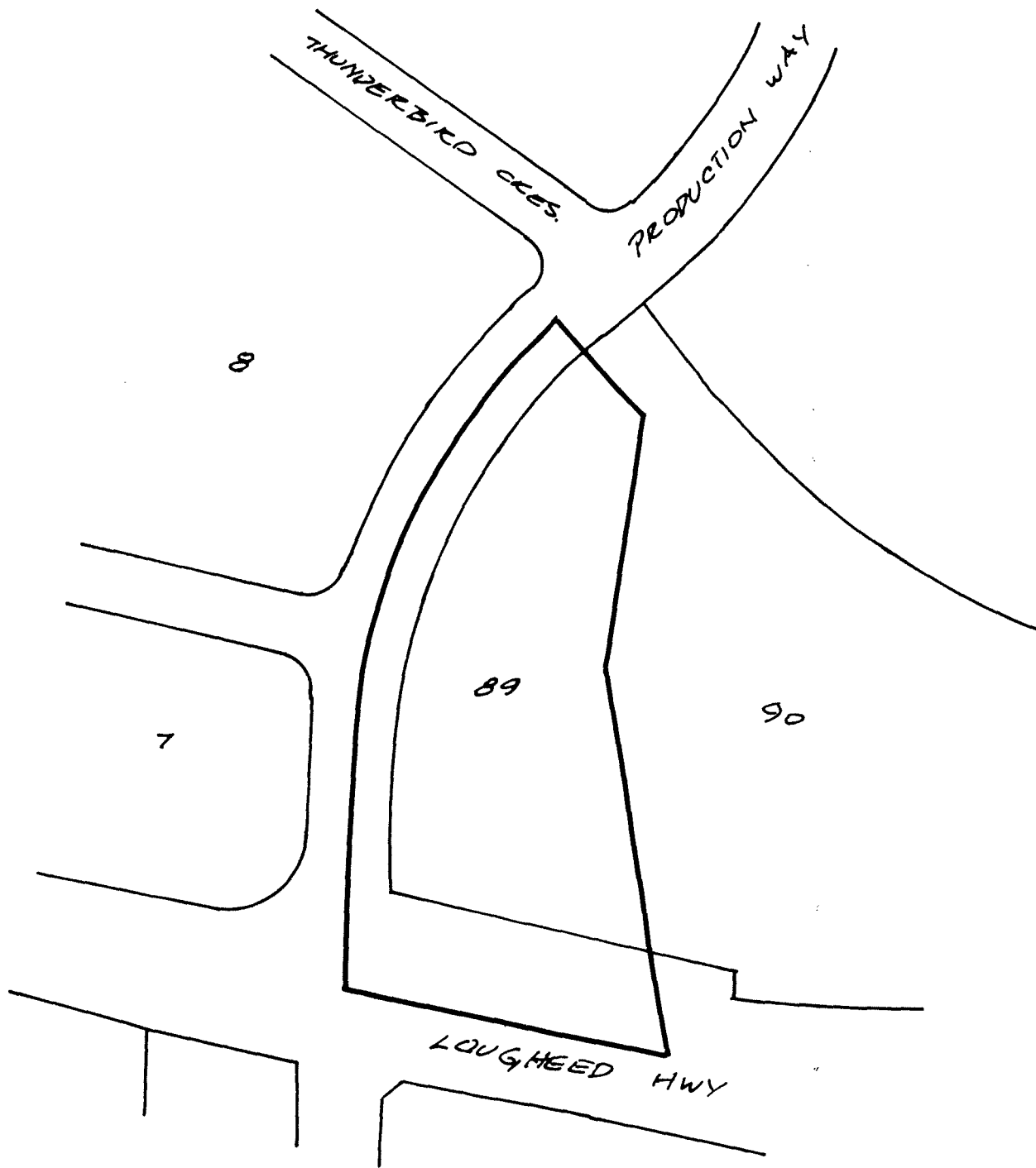

THE AREA(S) SHOWN ABOVE
OUTLINED IN BLACK (—)
IS (ARE) REZONED:

FROM: CD COMPREHENSIVE DEVELOPMENT DISTRICT
TO: AMENDED CD COMPREHENSIVE DEVELOPMENT DISTRICT



PLANNING DEPARTMENT		THE CORPORATION OF THE DISTRICT OF BURNABY	
SCALE	1:2000	OFFICIAL ZONING MAP No. RZ 1489	
DRAWN	E. P.		
DATE	1987 APR.		