

THE CORPORATION OF THE DISTRICT OF BURNABY

BYLAW NO. 8561

A BYLAW to amend Bylaw No. 4742, being  
Burnaby Zoning Bylaw 1965

WHEREAS application for rezoning has been made to the Council.

AND WHEREAS the Council has held a public hearing thereon after duly giving notice of the time and place of such hearing as prescribed by section 720 of the Municipal Act, R.S.B.C. 1979.

NOW THEREFORE the Council of The Corporation of the District of Burnaby ENACTS as follows:

1. This Bylaw may be cited as BURNABY ZONING BYLAW 1965, AMENDMENT BYLAW NO. 42, 1986.
2. The Map (hereinafter called "Map 'A'"), attached to and forming an integral part of Bylaw No. 4742, being "Burnaby Zoning Bylaw 1965", and designated as the Official Zoning Map of The Corporation of the District of Burnaby, is hereby amended according to the Map (hereinafter called "Map 'B'"), marginally numbered R.Z. 1388, annexed to this Bylaw, and in accordance with the explanatory legend, notations, references and boundaries designated, described, delimited and specified in particularity shown upon said Map 'B'; and the various boundaries and districts shown upon said Map 'B' respectively are an amendment of and in substitution for the respective districts, designated and marked on said Map 'A' insofar as the same are changed, modified or varied thereby, and the said Map 'A' shall be deemed to be and is hereby declared to be amended accordingly and the said Map 'B' is hereby declared to be and shall form an integral part of said Map 'A', as if originally incorporated therein and shall be interpreted accordingly.

3. The Comprehensive Development Plan entitled OFFICE/  
RESIDENTIAL DEVELOPMENT KINGSWAY/JERSEY AVENUE prepared by L.  
LAIDLAW, ARCHITECT, and on file in the office of the Director  
Planning and Building Inspection, is deemed to be attached to and  
form part of this bylaw and any development on the lands rezoned  
by this bylaw shall be in conformity with the said Comprehensive  
Development Plan.

Read a first time this 20th day of MAY 1986

Read a second time this 16th day of JUNE 1986

Read a third time this 7th day of JULY 1986

Reconsidered and adopted this 5th day of AUGUST 1986

  
MAYOR

  
CLERK

BYLAW NUMBER 8561 BEING A BYLAW TO AMEND  
BYLAW NUMBER 4742 BEING THE BURNABY ZONING BYLAW 1965

PROPERTY REZONED TO: CD COMPREHENSIVE DEVELOPMENT DISTRICT

Lots 8, 9, 10, Blk. 3, D.L. 34, Grp. 1, Plan 1441, NWD;  
Lots "A" & "B", D.L. 34, Grp. 1, Plan 12192, NWD

MAP "B"

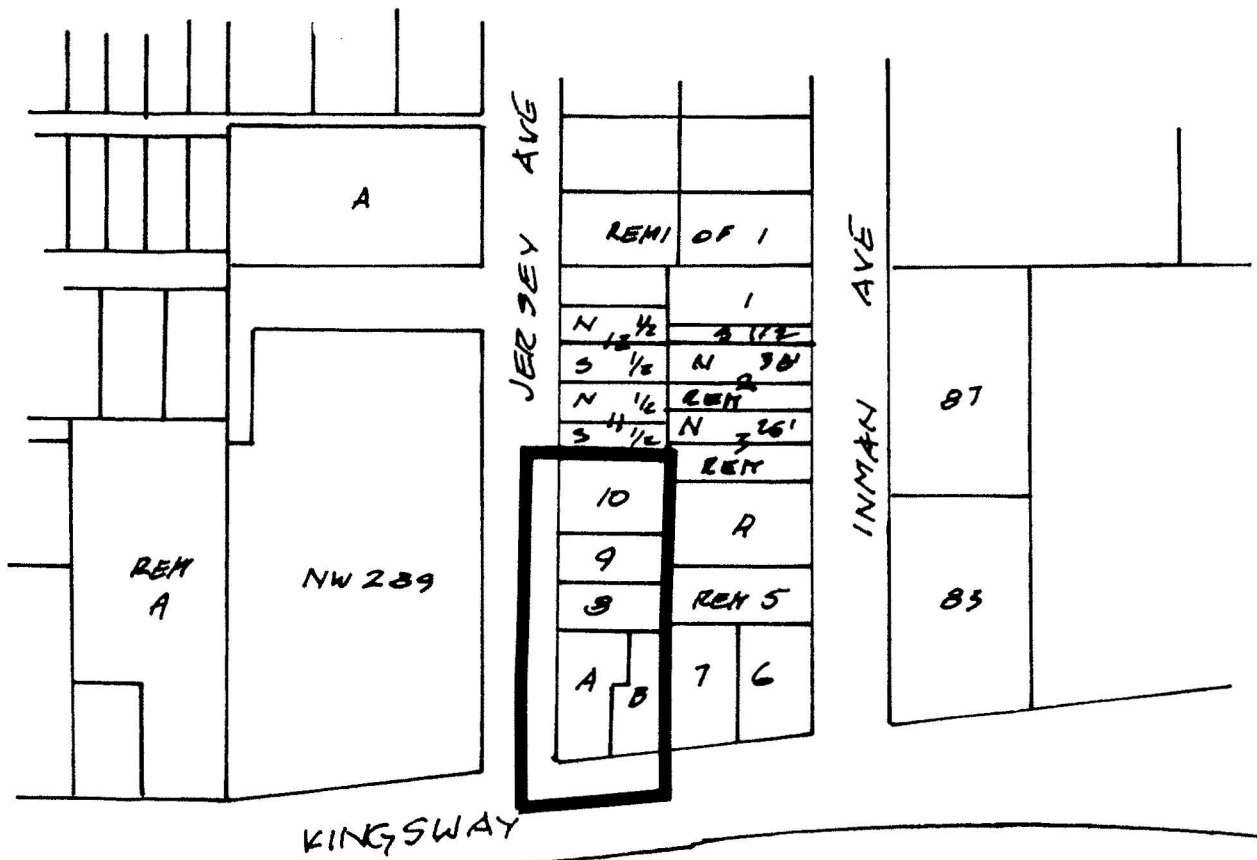

THE AREA(S) SHOWN ABOVE  
OUTLINED IN BLACK (—)  
IS (ARE) REZONED:

FROM: R5 RESIDENTIAL DISTRICT AND  
C4 SERVICE COMMERCIAL DISTRICT  
TO: CD COMPREHENSIVE DEVELOPMENT DISTRICT



PLANNING DEPARTMENT	
SCALE	1:2000
DRAWN	G. P.

THE CORPORATION OF THE DISTRICT OF BURNABY

OFFICIAL ZONING MAP