

THE CORPORATION OF THE DISTRICT OF BURNABY

BYLAW NO. 8529

A BYLAW to amend Bylaw No. 4742, being  
Burnaby Zoning Bylaw 1965

WHEREAS application for rezoning has been made to the Council.

AND WHEREAS the Council has held a public hearing thereon after duly giving notice of the time and place of such hearing as prescribed by section 720 of the Municipal Act, R.S.B.C. 1979.

NOW THEREFORE the Council of The Corporation of the District of Burnaby ENACTS as follows:

1. This Bylaw may be cited as "BURNABY ZONING BYLAW 1965, AMENDMENT BYLAW NO. 23, 1986."

2. The Map (hereinafter called "Map 'A'"), attached to and forming an integral part of Bylaw No. 4742, being "Burnaby Zoning Bylaw 1965", and designated as the Official Zoning Map of The Corporation of the District of Burnaby, is hereby amended according to the Map (hereinafter called "Map 'B'"), marginally numbered R.Z. 1367, annexed to this Bylaw, and in accordance with the explanatory legend, notations, references and boundaries designated, described, delimited and specified in particularity shown upon said Map 'B'; and the various boundaries and districts shown upon said Map 'B' respectively are an amendment of and in substitution for the respective districts, designated and marked on said Map 'A' insofar as the same are changed, modified or varied thereby, and the said Map 'A' shall be deemed to be and is hereby declared to be amended accordingly and the said Map 'B' is hereby declared to be and shall form an integral part of said Map 'A', as if originally incorporated therein and shall be interpreted accordingly.

3. The Comprehensive Development Plan entitled COMMERCIAL DEVELOPMENT/NORTH ROAD & CAMERON ROAD prepared by EARL PONT ARCHITECT and on file in the office of the Director Planning and Building Inspection, is deemed to be attached to and form part of this bylaw and any development on the lands rezoned by this bylaw shall be in conformity with the said Comprehensive Development Plan.

Read a first time this 1st day of APRIL 1986

Read a second time this 28th day of APRIL 1986

Read a third time this 5th day of AUGUST 1986

Reconsidered and adopted this 23rd day of FEBRUARY 1987



M A Y O R



C L E R K

BYLAW NUMBER 8529 BEING A BYLAW TO AMEND  
 BYLAW NUMBER 4742 BEING THE BURNABY ZONING BYLAW 1965

PROPERTY REZONED TO: CD COMPREHENSIVE DEVELOPMENT DISTRICT AND  
 C7 DRIVE-IN RESTAURANT DISTRICT

Lot 2, of D.L. 4, Grp. 1, Plan 7464 Exc. W. 200 ft. and Pcl. "E", Ref. Pl. 33125; S. 198.25 ft. of Pcl. "C", Ref. Pl. 2399 of Lot 8 of D.L. 4, Grp. 1, Plan 845 Exc. S. 99.125 ft. and Pcl. 1, Ref. Pl. 33125; S. 99.125 ft. of Pcl. "C", Ref. Pl. 2399 of Lot 8 of D.L. 4, Grp. 1, Plan 845 Exc. Pcl. 1, Ref. Pl. 33125; Pcl "E", Ref. Pl. 1286 of Lot 8, D.L. 4, Grp. 1, Plan 845 Exc. Pcl. 1, Ref. Pl. 33125; Parcel "G", Exp. Plan 14388 Exc. Ref. Pl. 33125 of Lot 8 of D.L. 4, Grp. 1, Plan 845; Lot 1, Pcl. "C", Lot 8 of D.L. 4, Grp. 1, Plan 7464; W. 200 ft. of Lot 2 of D.L. 4, Grp. 1, Plan 7464 Exc. the E. 72 ft.; E. 72 ft. of the W. 200 ft. of Lot 2, D.L. 4, Grp. 1, Plan 746

MAP 'B'

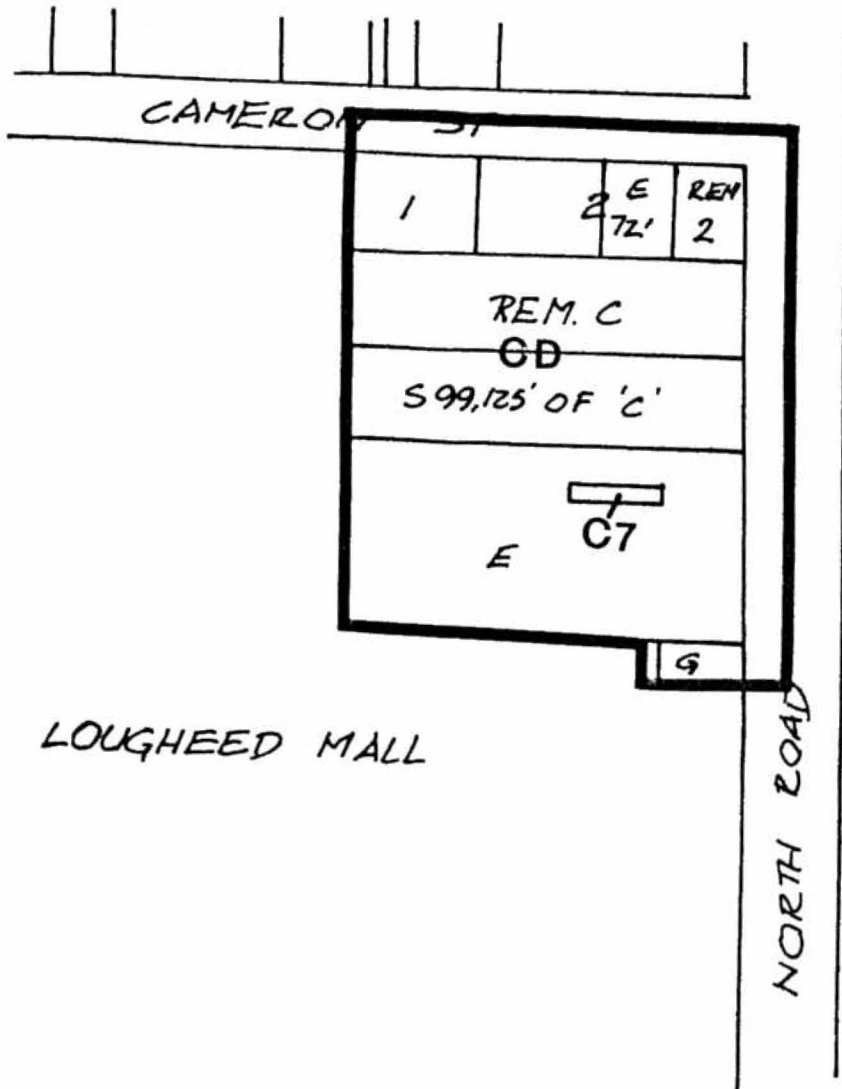

THE AREA(S) SHOWN ABOVE  
 OUTLINED IN BLACK (—)  
 IS (ARE) REZONED:

FROM: C1 NEIGHBOURHOOD COMMERCIAL DISTRICT  
 C3 GENERAL COMMERCIAL DISTRICT AND  
 A2 SMALL HOLDINGS DISTRICT  
 TO: CD COMPREHENSIVE DEVELOPMENT DISTRICT AND  
 C7 DRIVE-IN RESTAURANT DISTRICT

PLANNING DEPARTMENT	
SCALE	1:2000
DRAWN	E. P.

THE CORPORATION OF THE DISTRICT OF BURNABY

OFFICIAL ZONING MAP