

THE CORPORATION OF THE DISTRICT OF BURNABY

BYLAW NO. 8256

A BYLAW to amend Bylaw No. 4742, being
Burnaby Zoning Bylaw 1965

WHEREAS application for rezoning has been made to the Council.

AND WHEREAS the Council has held a public hearing thereon after duly giving notice of the time and place of such hearing as prescribed by section 720 of the Municipal Act, R.S.B.C. 1979.

NOW THEREFORE the Council of The Corporation of the District of Burnaby ENACTS as follows:

1. This Bylaw may be cited as "BURNABY ZONING BYLAW 1965, AMENDMENT BYLAW NO. 56, 1984."
2. The Map (hereinafter called "Map 'A'"), attached to and forming an integral part of Bylaw No. 4742, being "Burnaby Zoning Bylaw 1965", and designated as the Official Zoning Map of The Corporation of the District of Burnaby, is hereby amended according to the Map (hereinafter called "Map 'B'"), marginally numbered R.Z. 1236, annexed to this Bylaw, and in accordance with the explanatory legend, notations, references and boundaries designated, described, delimited and specified in particularity shown upon said Map 'B'; and the various boundaries and districts shown upon said Map 'B' respectively are an amendment of and in substitution for the respective districts, designated and marked on said Map 'A' insofar as the same are changed, modified or varied thereby, and the said Map 'A' shall be deemed to be and is hereby declared to be amended accordingly and the said Map 'B' is hereby declared to be and shall form an integral part of said Map 'A', as if originally incorporated therein and shall be interpreted accordingly.

3. The Comprehensive Development Plan entitled "MULTIPLE FAMILY DEVELOPMENT/DUTHIE AND BARNET", prepared by MORTON ASSOCIATES, Architects, and on file in the office of the Director Planning and Building Inspection, is deemed to be attached to and form part of this bylaw and any development on the lands rezoned by this bylaw shall be in conformity with the said Comprehensive Development Plan.

Read a first time this 27th day of AUGUST 1984.

Read a second time this 24th day of SEPTEMBER 1984.

Read a third time this 26th day of NOVEMBER 1984.

Reconsidered and adopted this 10th day of DECEMBER 1984.

MAYOR



CLERK

BYLAW NUMBER 8256 BEING A BYLAW TO AMEND
BYLAW NUMBER 4742 BEING THE BURNABY ZONING BYLAW 1965

PROPERTY REZONED TO: CD COMPREHENSIVE DEVELOPMENT DISTRICT

Lot 17, Lot 18 Pcl "A" Expl. Pl. 15768, Lot 18 Exc. Pcl "A" Expl. Pl. 15768,
Lots 10, 11, 12, 13 & 14, Blk. 2, D.L. 207, Plan 4032

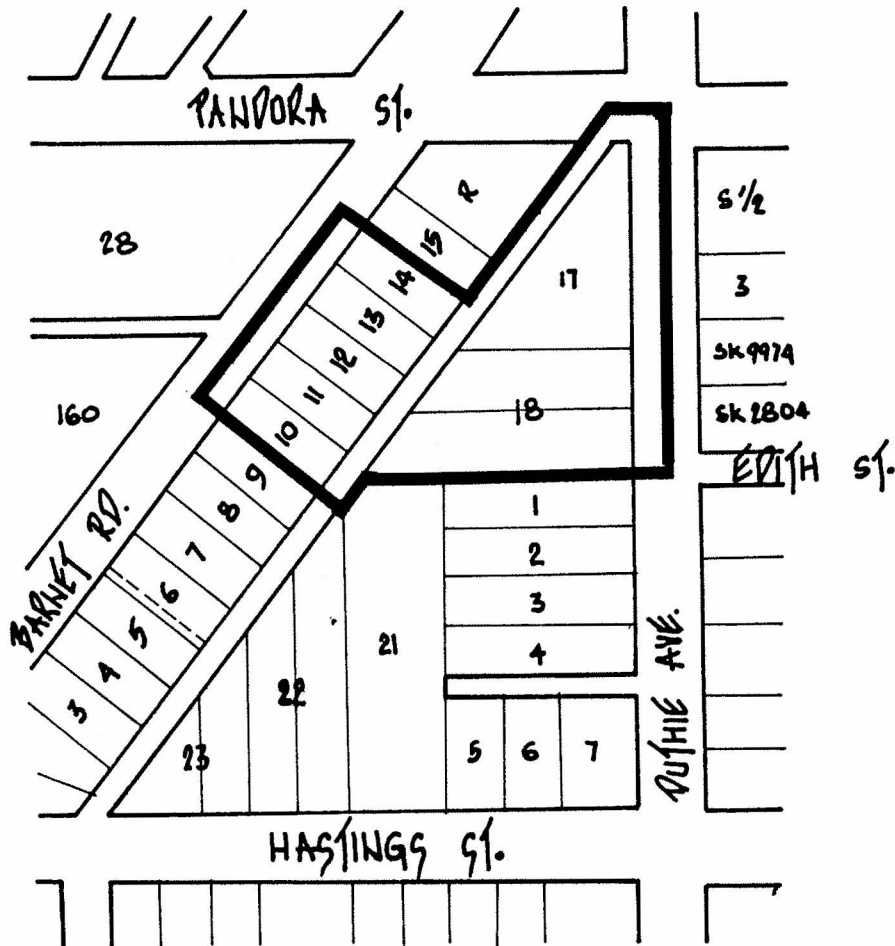
MAP "B"



THE AREA(S) SHOWN ABOVE
OUTLINED IN BLACK (—)
IS (ARE) REZONED:

FROM: R4 RESIDENTIAL DISTRICT AND
P1 NEIGHBOURHOOD INSTITUTIONAL DISTRICT
TO: CD COMPREHENSIVE DEVELOPMENT DISTRICT

PLANNING DEPARTMENT	
SCALE	1" = 200'
DRAWN	J.P.C.
DATE	AUG 1984

THE CORPORATION OF THE DISTRICT OF BURNABY

OFFICIAL ZONING MAP