

THE CORPORATION OF THE DISTRICT OF BURNABY

BYLAW NO. 8255

A BYLAW to amend Bylaw No. 4742, being  
Burnaby Zoning Bylaw 1965

WHEREAS application for rezoning has been made to the Council.

AND WHEREAS the Council has held a public hearing thereon after duly giving notice of the hearing as prescribed by section 720 of the Municipal Act R.S.B.C. 1979.

NOW THEREFORE the Council of The Corporation of the District of Burnaby ENACTS as follows:

1. This Bylaw may be cited as BURNABY ZONING BYLAW 1965, AMENDMENT BYLAW NO. 55, 1984.
2. The Map (hereinafter called "Map 'A'") attached to and forming an integral part of Bylaw No. 4742, being Burnaby Zoning Bylaw 1965, and designated as the Official Zoning Map of The Corporation of the District of Burnaby, is hereby amended according to the Map (hereinafter called "Map 'B'"), marginally numbered R.Z. 1235 annexed to this Bylaw, and in accordance with the explanatory legend, notations, references and boundaries designated, described, delimited and specified in particularly shown upon said Map 'B'; and the various boundaries and districts shown upon said Map 'B' respectively are an amendment of and in substitution for the respective districts, designated and marked on said Map 'A' insofar as the same are changed, modified or varied thereby, and the said Map 'A' shall be deemed to be and is hereby declared to be amended accordingly and the said Map 'B' is hereby declared to be and shall form an integral part of said Map 'A', as if originally incorporated therein, and shall be interpreted accordingly.

Read a first time this 27th day of AUGUST 1984

Read a second time this 24th day of SEPTEMBER 1984

Read a third time this 2nd day of JULY 1985

Reconsidered and adopted 17th this day of NOVEMBER 1986

ACTING

*Gary Beznik*  
MAYOR

*Robert J. ...*  
CLERK

BYLAW NUMBER 8255 BEING A BYLAW TO AMEND  
BYLAW NUMBER 4742 BEING THE BURNABY ZONING BYLAW 1965

PROPERTY REZONED TO: P2 ADMINISTRATION AND ASSEMBLY DISTRICT

Part of Lot "C", D.L. 95, Group 1, Plan 16808  
Parcel 1, D.L. 95, Group 1, Ref. Plan 60693  
Part of Lot 52, B1k. 2, D.L. 95, Grp. 1, Map 927, Ref. Pl. 6916

MAP "B"

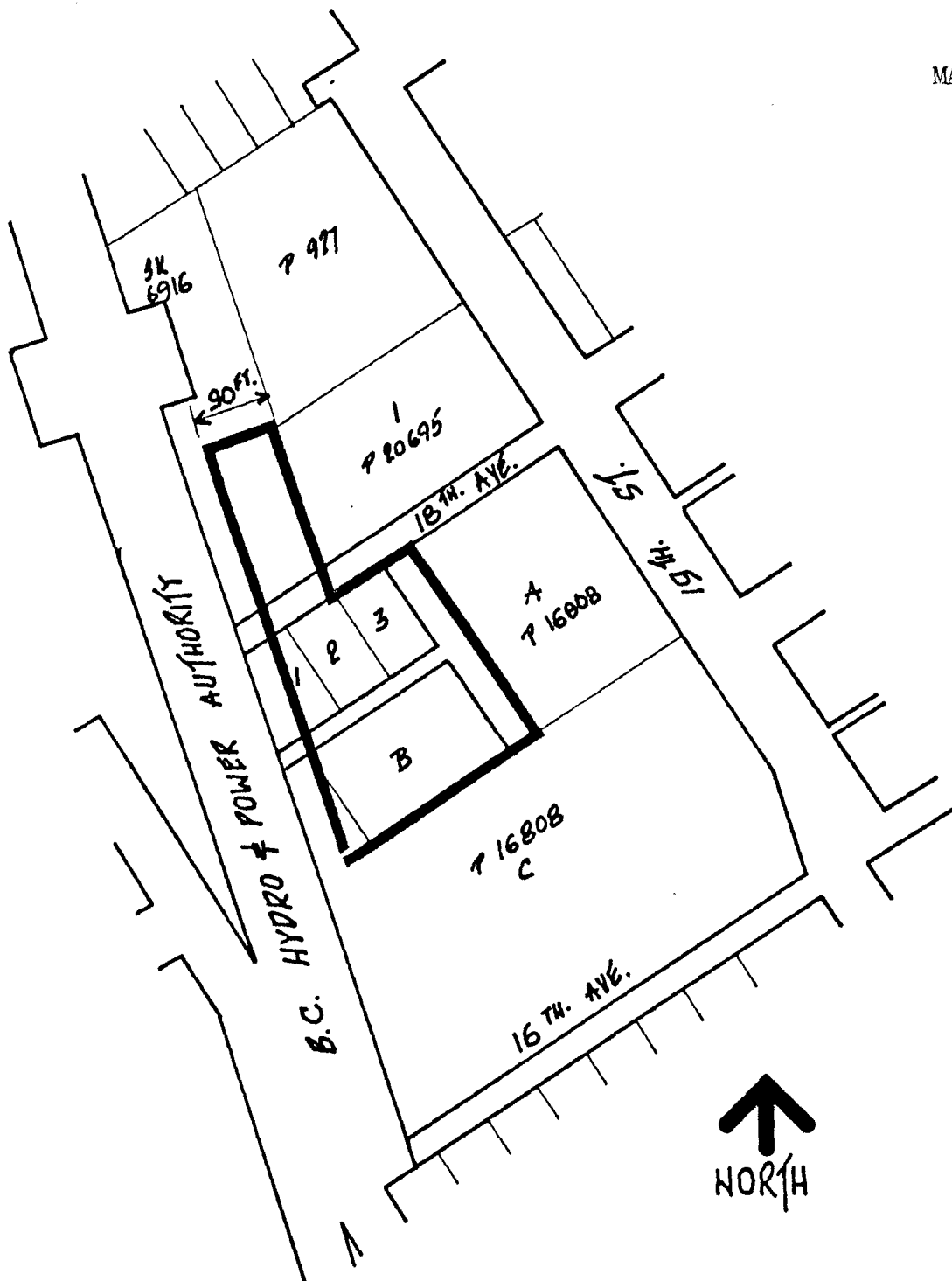

THE AREA(S) SHOWN ABOVE  
OUTLINED IN BLACK (—)  
IS (ARE) REZONED:

FROM: M2 GENERAL INDUSTRIAL DISTRICT AND  
R5 RESIDENTIAL DISTRICT  
TO: P2 ADMINISTRATION AND ASSEMBLY DISTRICT

PLANNING  
DEPARTMENT

THE CORPORATION OF THE DISTRICT OF BURNABY

SCALE 1" = 200'

DRAWN J.R.C.

OFFICIAL ZONING MAP