

THE CORPORATION OF THE DISTRICT OF BURNABY

BYLAW NO. 8210

A BYLAW to amend Bylaw No. 4742, being  
Burnaby Zoning Bylaw 1965.

WHEREAS application for rezoning has been made to the Council.

AND WHEREAS the Council has held a public hearing thereon after duly giving notice of the time and place of such hearing as prescribed by section 720 of the Municipal Act, R.S.B.C. 1979.

NOW THEREFORE the Council of The Corporation of the District of Burnaby ENACTS as follows:

1. This Bylaw may be cited as "BURNABY ZONING BYLAW 1965, AMENDMENT BYLAW NO. 32, 1984."
2. The Map (hereinafter called "Map 'A'"), attached to and forming an integral part of Bylaw No. 4742, being "Burnaby Zoning Bylaw 1965", and designated as the Official Zoning Map of The Corporation of the District of Burnaby, is hereby amended according to the Map (hereinafter called "Map 'B'"), marginally numbered R.Z. 1212, annexed to this Bylaw, and in accordance with the explanatory legend, notations, references and boundaries designated, described, delimited and specified in particularity shown upon said Map 'B'; and the various boundaries and districts shown upon said Map 'B' respectively are an amendment of and in substitution for the respective districts, designated and marked on said Map 'A' insofar as the same are changed, modified or varied thereby, and the said Map 'A' shall be deemed to be and is hereby declared to be amended accordingly and the said Map 'B' is hereby declared to be and shall form an integral part of said Map 'A', as if originally incorporated therein and shall be interpreted accordingly.

3. The Comprehensive Development Plan entitled SENIOR CITIZENS'S DEVELOPMENT/ROSEWOOD STREET/MARY STREET/HOLLY STREET prepared by HOWARD/YANO ARCHITECTS, and on file in the office of the Director Planning and Building Inspection, is deemed to be attached to and form part of this bylaw and any development on the lands rezoned by this bylaw shall be in conformity with the said Comprehensive Development Plan.

Read a first time this 11th day of June, 1984

Read a second time this 25th day of June, 1984

Read a third time this 30th day of March, 1987

Reconsidered and adopted this 6th day of April, 1987

  
M A Y O R

  
D E P U T Y C L E R K

BYLAW NUMBER 8210 BEING A BYLAW TO AMEND  
BYLAW NUMBER 4742 BEING THE BURNABY ZONING BYLAW 1965

PROPERTY REZONED TO: CD COMPREHENSIVE DEVELOPMENT DISTRICT AND  
AMENDED CD COMPREHENSIVE DEVELOPMENT DISTRICT

Lot 1, Lot 16, Blk. 12, D.L. 30, Plan 3036; Lot 1, Lot 16, Blk. 13, D.L. 30, Plan 3036;  
Rem. 72, Rem. 73, Rem. 74, Ex. Pl. 44227, D.L. 30, Plan 29773

MAP "B"

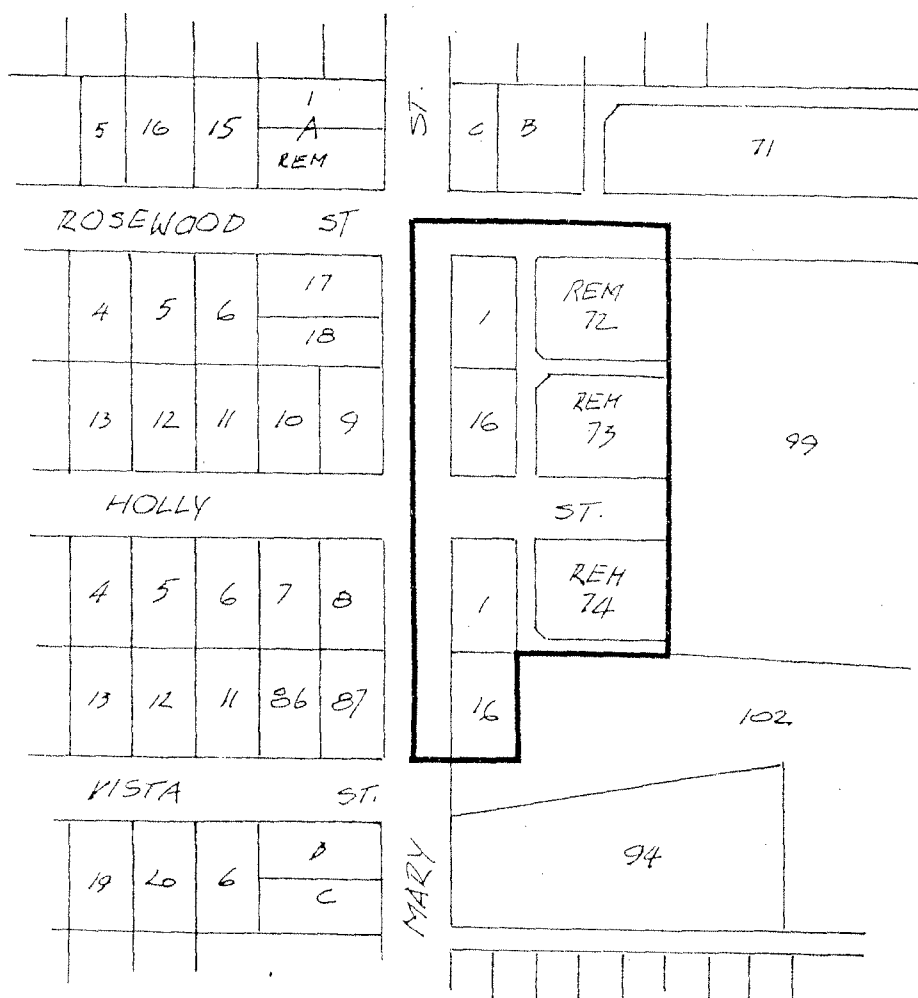

THE AREA(S) SHOWN ABOVE  
OUTLINED IN BLACK (—)  
IS (ARE) REZONED:

FROM: R5- RESIDENTIAL DISTRICT AND  
CD COMPREHENSIVE DEVELOPMENT DISTRICT  
TO: CD COMPREHENSIVE DEVELOPMENT DISTRICT AND  
AMENDED CD COMPREHENSIVE DEVELOPMENT DISTRICT



PLANNING DEPARTMENT		THE CORPORATION OF THE DISTRICT OF BURNABY	
SCALE	1" = 240'	OFFICIAL ZONING MAP	
DRAWN	G. P.		
DATE	1984 MAY		
		No. RZ 1212	