

THE CORPORATION OF THE DISTRICT OF BURNABY

BY-LAW NO. 7708

A BY-LAW to amend By-Law No. 4742, being
"Burnaby Zoning By-Law 1965"

WHEREAS application for rezoning has been made to
the Council.

AND WHEREAS the Council has held a public hearing
thereon after duly giving notice of the time and place of such
hearing as prescribed by section 720 of the Municipal Act, R.S.B.C.
1979.

NOW THEREFORE the Council of The Corporation of the
District of Burnaby ENACTS as follows:

1. This By-law may be cited as "BURNABY ZONING BY-LAW
1965, AMENDMENT BY-LAW NO. 55 , 19 81."
2. The Map (hereinafter called "Map 'A'"), attached to
and forming an integral part of By-Law No. 4742, being "Burnaby
Zoning By-Law 1965", and designated as the Official Zoning Map
of The Corporation of the District of Burnaby, is hereby amended
according to the Map (hereinafter called "Map 'B'"), marginally
numbered R.Z. 950 , annexed to this By-Law, and in accord-
ance with the explanatory legend, notations, references and
boundaries designated, described, delimited and specified in
particularity shown upon said Map 'B'; and the various boundaries
and districts shown upon said Map 'B' respectively are an amend-
ment of and in substitution for the respective districts, desig-
nated and marked on said Map 'A' insofar as the same are changed,
modified or varied thereby, and the said Map 'A' shall be deemed
to be and is hereby declared to be amended accordingly and the
said Map 'B' is hereby declared to be and shall form an integral
part of said Map 'A', as if originally incorporated therein and
shall be interpreted accordingly.

3. The Comprehensive Development Plan entitled "Curle Avenue Townhouse Development, prepared by I.B.I. Group, Architects, and on file in the office of the Director of Planning, is deemed to be attached to and form part of this by-law and any development on the lands rezoned by this by-law shall be in conformity with the said Comprehensive Development Plan.

Read a first time this 13th day of JULY 1981.

Read a second time this 10th day of AUGUST 1981.

Read a third time this 26th day of OCTOBER 1981.

Reconsidered and adopted this 31st day of OCTOBER 1983

William R. Lawrence
MAYOR

James Hudson
CLERK

BYLAW NUMBER 7708 BEING A BYLAW TO AMEND
BYLAW NUMBER 4742 BEING THE BURNABY ZONING BYLAW 1965

PROPERTY REZONED TO: CD COMPREHENSIVE DEVELOPMENT DISTRICT

LEGAL DESCRIPTION: Pcl. "D" Expl. Plan 27425 of "A & B", Blk. 11 D.L. 68 Plan 11090

Lot "A" exc. Expl. Plan 27425, Blk. 11, D.L. 68, Plan 11090

MAP "B"

Lot 12, D.L. 68, Plan 3431

Lot 10, D.L. 68, Plan 3431

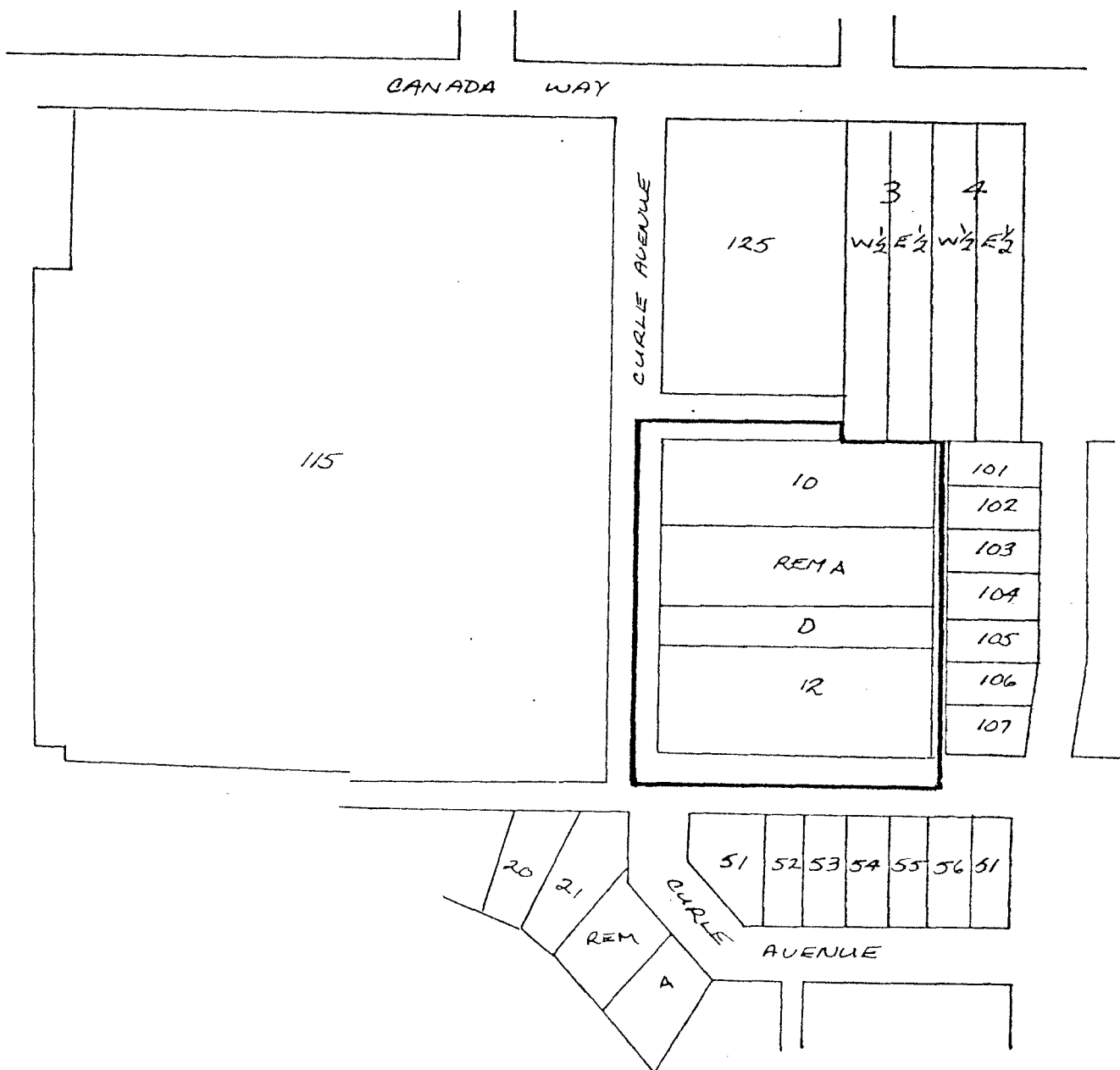

THE AREA(S) SHOWN ABOVE
OUTLINED IN BLACK (—)
IS (ARE) REZONED:

FROM: R5 - RESIDENTIAL DISTRICT
TO: CD - COMPREHENSIVE DEVELOPMENT DISTRICT

James Hudson

PLANNING DEPARTMENT	
SCALE	1" = 200'
DRAWN	R.P.
DATE	1981 July

THE CORPORATION OF THE DISTRICT OF BURNABY

OFFICIAL ZONING MAP

No. RZ 950