

THE CORPORATION OF THE DISTRICT OF BURNABY

BY-LAW NO. 7703

A BY-LAW to amend By-Law No. 4742, being
"Burnaby Zoning By-Law 1965"

WHEREAS application for rezoning has been made to the
Council.

AND WHEREAS the Council has held a public hearing thereon
after duly giving notice of the hearing as prescribed by section 720
of the Municipal Act R.S.B.C. 1979.

NOW THEREFORE the Council of The Corporation of the
District of Burnaby ENACTS as follows:

1. This By-Law may be cited as "BURNABY ZONING BY-LAW 1965,
AMENDMENT BY-LAW NO. 52 , 1981".
2. The Map (hereinafter called "Map 'A'") attached to and
forming an integral part of By-Law No. 4742, being "Burnaby Zoning By-
Law 1965"; and designated as the Official Zoning Map of The Corporation
of the District of Burnaby, is hereby amended according to the Map
(hereinafter called "Map 'B'"), marginally numbered R.Z. 947
annexed to this By-Law, and in accordance with the explanatory legend,
notations, references and boundaries designated, described, delimited
and specified in particularity shown upon said Map 'B'; and the various
boundaries and districts shown upon said Map 'B' respectively are an
amendment of and in substitution for the respective districts, designated
and marked on said Map 'A' insofar as the same are changed, modified or
varied thereby, and the said Map 'A' shall be deemed to be and is hereby
declared to be amended accordingly and the said Map 'B' is hereby
declared to be and shall form an integral part of said Map 'A', as if
originally incorporated therein, and shall be interpreted accordingly.

Read a first time this 29th day of JUNE , 1981.

Read a second time this 27th day of JULY , 1981.

Read a third time this 20th day of AUGUST , 1984.

Reconsidered and adopted this 10th day of SEPTEMBER , 1984.

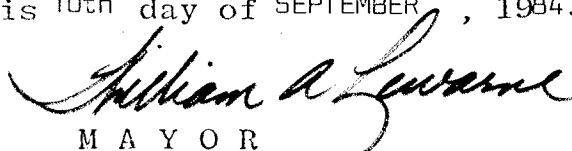
MAYOR

CLERK

BYLAW NUMBER 7703 BEING A BYLAW TO AMEND
BYLAW NUMBER 4742 BEING THE BURNABY ZONING BYLAW 1965

PROPERTY REZONED TO: R9 RESIDENTIAL DISTRICT

Lot 1, D.L. 25, P1. 13830

MAP "B"

STREET

STREET

14th Avenue

13th AVENUE

12th AVE.

11th AVENUE

10th AVENUE

FIRST

NEWCOMBE

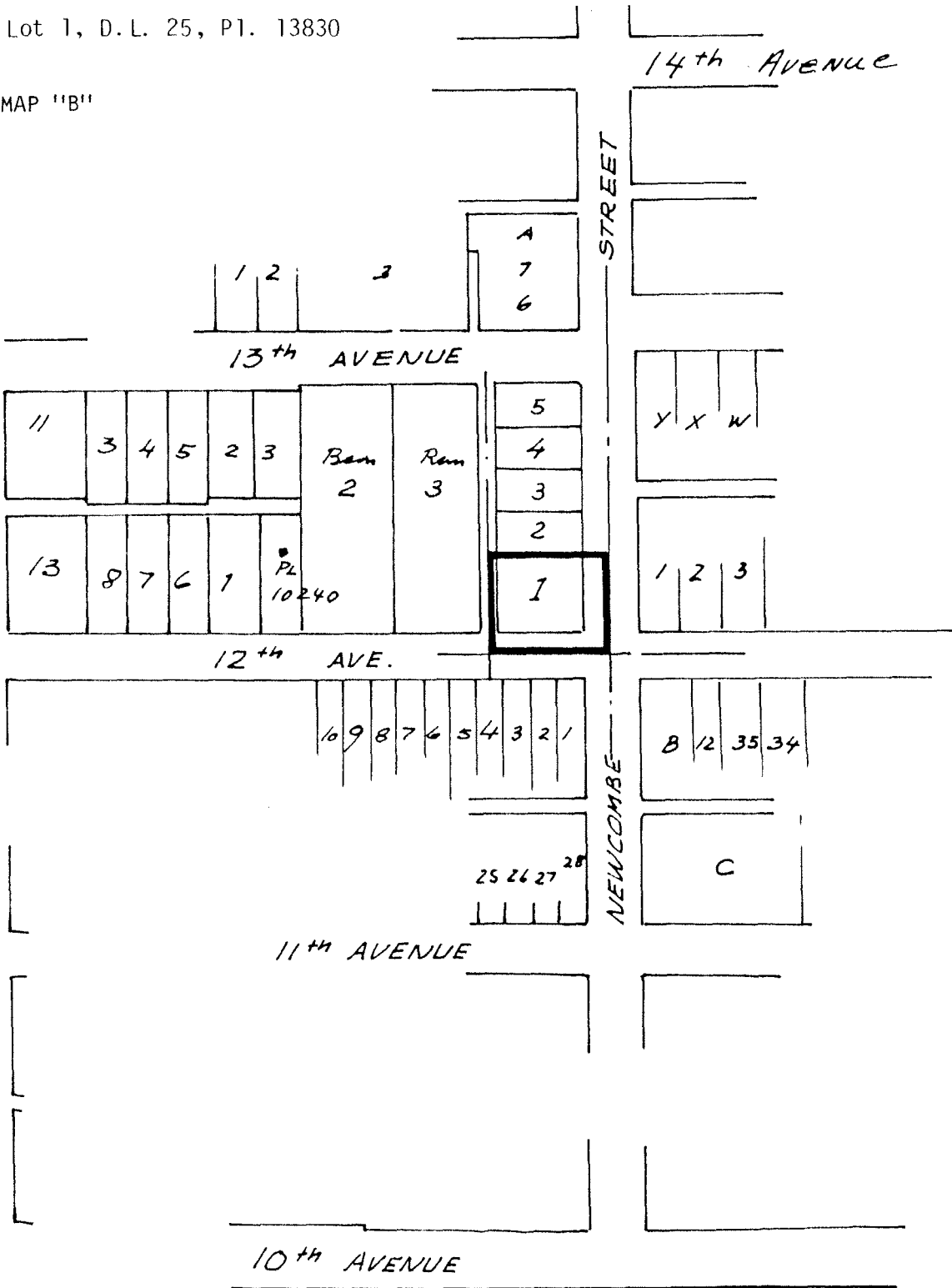

THE AREA(S) SHOWN ABOVE
OUTLINED IN BLACK (—)
IS (ARE) REZONED:

FROM: R5 RESIDENTIAL DISTRICT
TO: R9 RESIDENTIAL DISTRICT

PLANNING DEPARTMENT	
SCALE	1" = 200'
DRAWN	H. A. J.
DATE	June 1981

THE CORPORATION OF THE DISTRICT OF BURNABY

OFFICIAL ZONING MAP

No. RZ 947