

THE CORPORATION OF THE DISTRICT OF BURNABY

BY-LAW NO. 7651

A BY-LAW to Stop Up and Close to Traffic a
Portion of Road

WHEREAS that portion of road shown on the plan annexed hereto dedicated by Plan 7778 is no longer required for road purposes.

NOW THEREFORE the Council of The Corporation of the District of Burnaby ENACTS as follows:

1. This By-law may be cited as "BURNABY ROAD CLOSING BY-LAW NO. 2, 1981".
2. That portion of road situate, lying and being in the Municipality of Burnaby, in the Province of British Columbia, and being more particularly known and described as all that portion of Block 24, District Lot 95, Group 1, New Westminster District, dedicated by Plan 7778 and containing by admeasurement 98.5 m^2 shown outlined red on the plan prepared by E. T. Wong, B.C.L.S., certified correct the 13th day of January, 1981, a copy of which is annexed hereto, is hereby stopped up and closed to traffic.
3. The Municipal Clerk is hereby authorized and empowered to petition the Minister of Municipal Affairs to abandon the said portion of road more particularly described in Section 2 hereof and vest title thereto in the name of The Corporation of the District of Burnaby.

Read a first time this 4th day of MAY 1981.

Read a second time this 4th day of MAY 1981.

Read a third time this 4th day of MAY 1981.

Reconsidered and adopted this 11th day of MAY 1981.



M A Y O R

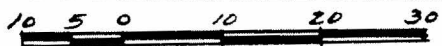

C L E R K

BY-LAW PLAN TO ACCOMPANY
THE CORPORATION OF THE
DISTRICT OF BURNABY LANE
CLOSING BY-LAW No. _____
OF PART OF BLOCK 24
DISTRICT LOT 95 GROUP 1
PLAN 7778
NEW WESTMINSTER DISTRICT
RATIO: 1:750 

PLAN _____

Deposited in the Land Title
 Office at New Westminster, B.C.
 this ___ day of _____, 198__

 Assistant Deputy Registrar

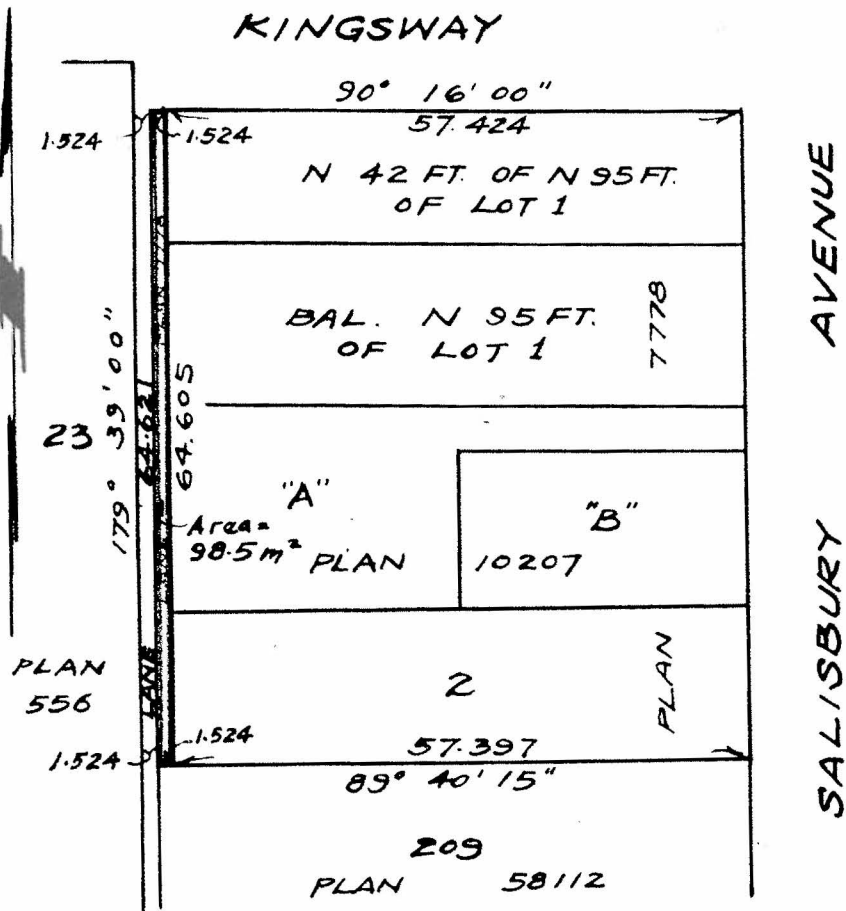

THE CORPORATION OF THE
DISTRICT OF BURNABY

All distances are in metres unless
 otherwise stated.

Bearings are astronomic and
 are referred to meridian of Plan 7778
 m² denotes square metres

CERTIFIED CORRECT ACCORDING
 TO LAND TITLE OFFICE RECORDS:
 this 13th day of January, 1981

"This plan lies within the Greater
 Vancouver Regional District."

E. J. Wong
 B.C.L.S. James Hudson

Ken K. Wong & Associates
 Canada & B.C. Land Surveyors
 5624 E. Hastings Street
 Burnaby, B.C. V5B 1R4

SmZ-20