

THE CORPORATION OF THE DISTRICT OF BURNABY

BY-LAW NO. 7494

A BY-LAW to amend By-Law No. 4742, being
"Burnaby Zoning By-Law 1965".

WHEREAS application for rezoning has been made to the
Council.

AND WHEREAS the Council has held a public hearing thereon
after duly giving notice of the time and place of such hearing.

NOW THEREFORE the Council of The Corporation of the
District of Burnaby ENACTS as follows:

1. This By-law may be cited as "BURNABY ZONING BY-LAW 1965,
AMENDMENT BY-LAW NO. 12, 19 80 ".

2. The Map (hereinafter called "Map 'A'") attached to and
forming an integral part of By-Law No. 4742, being "Burnaby Zoning By-
Law 1965", and designated as the Official Zoning Map of The Corporation
of the District of Burnaby, is hereby amended according to the Map
(hereinafter called "Map 'B'"), marginally numbered R.Z. 849
annexed to this By-law, and in accordance with the explanatory legend,
notations, references and boundaries designated, described, delimited
and specified in particularity shown upon said Map 'B'; and the various
boundaries and districts shown upon said Map 'B' respectively are an
amendment of and in substitution for the respective districts, designated
and marked on said Map 'A' insofar as the same are changed, modified or
varied thereby, and the said Map 'A' shall be deemed to be and is hereby
declared to be amended accordingly and the said Map 'B' is hereby declared
to be and shall form an integral part of said Map 'A', as if originally
incorporated therein, and shall be interpreted accordingly.

Read a first time this 21st day of APRIL 19 80

Read a second time this 21st day of APRIL 19 80

Read a third time this 21st day of APRIL 19 80

Reconsidered and adopted this 5th day of MAY 1980

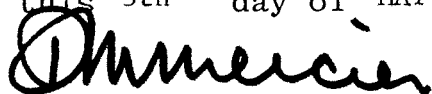

M A Y O R

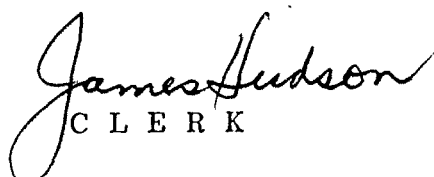

C L E R K

BYLAW NUMBER 7494 BEING A BYLAW TO AMEND
BYLAW NUMBER 4742 BEING THE BURNABY ZONING BYLAW 1965

PROPERTY REZONED TO: R2 - RESIDENTIAL DISTRICT (b)
AND A3 - TRUCK GARDENING DISTRICT (c)
LEGAL: Portion of Lot 137, D.L. 157/163, Plan 45779

MAP "B"

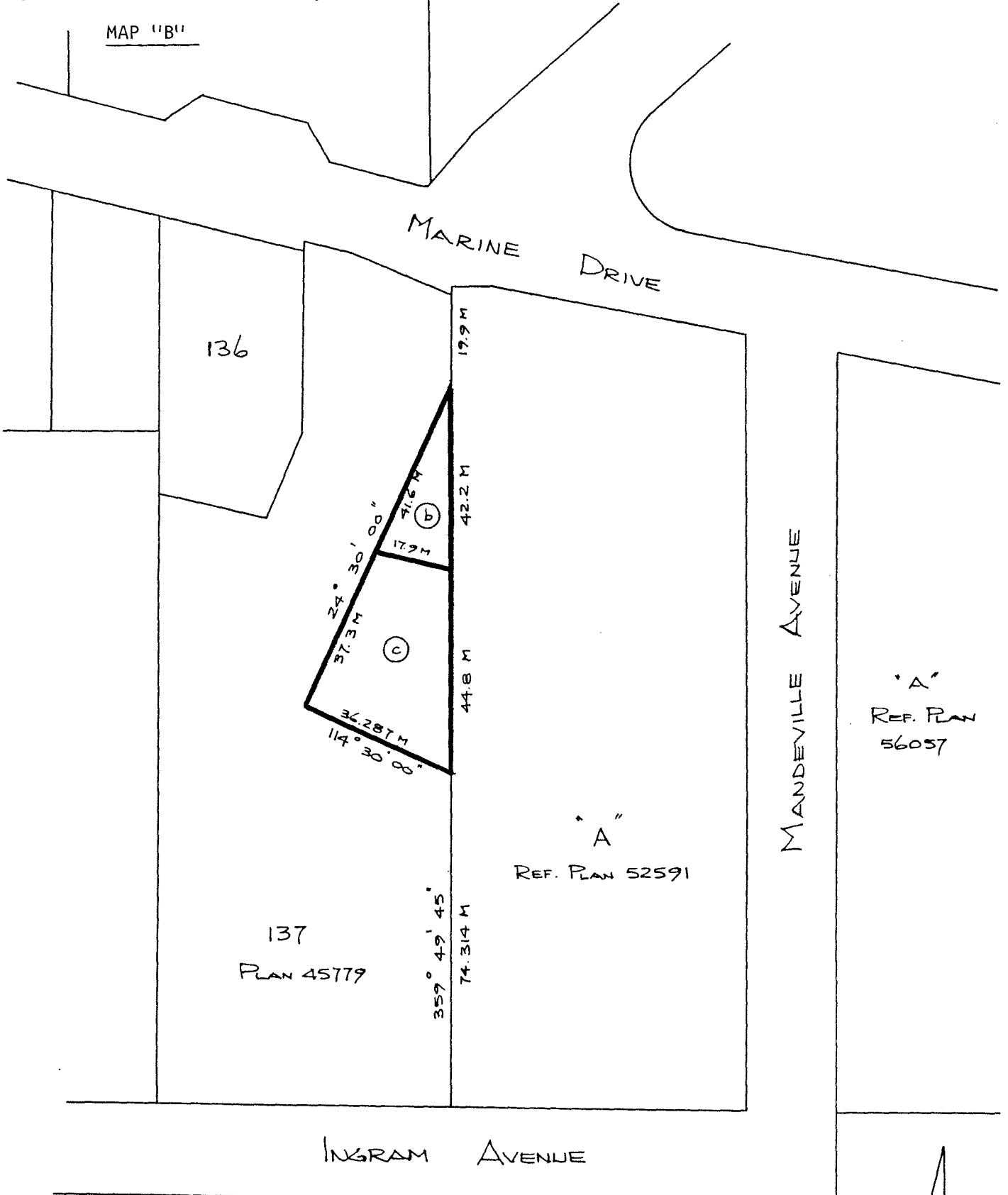

THE AREA(S) SHOWN ABOVE
OUTLINED IN BLACK (—)
IS (ARE) REZONED:

FROM: P3 - PARK AND PUBLIC USE DISTRICT
TO: A3 - TRUCK GARDENING DISTRICT
and R2 - RESIDENTIAL DISTRICT

BEARINGS ARE ASTRONOMIC
AND ARE DERIVED FROM
PLAN 45579.

PLANNING DEPARTMENT		THE CORPORATION OF THE DISTRICT OF BURNABY	
SCALE	1" = 200'	OFFICIAL ZONING MAP	
DRAWN	R.P.		
DATE	80 04 01		
		No. RZ	849