

THE CORPORATION OF THE DISTRICT OF BURNABY

BY-LAW NO. 7225

A BY-LAW to amend By-Law No. 4742, being  
"Burnaby Zoning By-Law 1965"

WHEREAS application for rezoning has been made to the Council.

AND WHEREAS the Council has held a public hearing thereon after duly giving notice of the time and place of such hearing.

NOW THEREFORE the Council of The Corporation of the District of Burnaby ENACTS as follows:

1. This By-Law may be cited as "BURNABY ZONING BY-LAW 1965, AMENDMENT BY-LAW NO. 15, 19 78 ".

2. The Map (hereinafter called "Map "A"") attached to and forming an integral part of By-Law No. 4742, being "Burnaby Zoning By-Law 1965", and designated as the Official Zoning Map of The Corporation of the District of Burnaby, is hereby amended according to the Map (hereinafter called "Map "B""), marginally numbered R.Z. 777 annexed to this By-Law, and in accordance with the explanatory legend, notations, references and boundaries designated, described, delimited and specified in particularity shown upon said Map "B"; and the various boundaries and districts shown upon said Map "B" respectively are an amendment of and in substitution for the respective districts, designated and marked on said Map "A" insofar as the same are changed, modified or varied thereby, and the said Map "A" shall be deemed to be and is hereby declared to be amended accordingly and the said Map "B" is hereby declared to be and shall form an integral part of said Map "A", as if originally incorporated therein, and shall be interpreted accordingly.

Read a first time this 26th day of June, 1978.

Read a second time this 26th day of June, 1978.

Read a third time this 4th day of July, 1978.

Reconsidered and adopted by an affirmative vote of at least two-thirds of all the members of the Council present at the meeting at which the vote is taken and entitled to vote on the by-law this 17th day of July, 1978 .



ACTING

MAYOR

DEPUTY

CLERK

BYLAW NUMBER 7225 BEING A BYLAW TO AMEND  
BYLAW NUMBER 4742 BEING THE BURNABY ZONING BYLAW 1965

PROPERTY REZONED TO:

MAP "B"

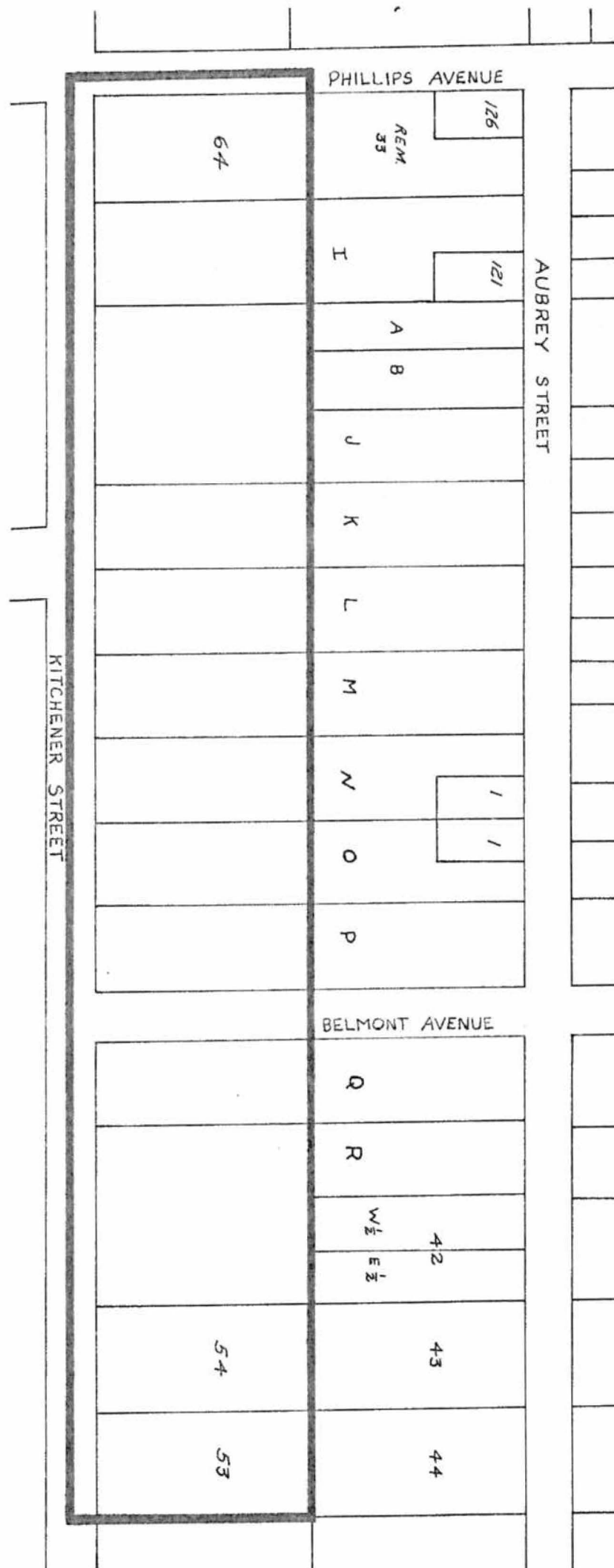

THE AREA(S) SHOWN ABOVE  
OUTLINED IN BLACK (—)  
IS (ARE) REZONED:

PLANNING  
DEPARTMENT

THE CORPORATION OF THE DISTRICT OF BURNABY

SCALE 1:2400

DRAWN SAM

OFFICIAL ZONING MAP

DATE 1978 JUNE

No. RZ 777

BYLAW NUMBER 7225 BEING A BYLAW TO AMEND  
BYLAW NUMBER 4742 BEING THE BURNABY ZONING BYLAW 1965

PROPERTY REZONED TO: RESIDENTIAL DISTRICT TWO (R2)

LEGAL: Lots 53, 54, 64, D.L. 138, Plan 1256; Rear portions of  
Lots "I" except Explanatory Plan 25861, "J", "K", "L",  
"M", "N", except Plan 26234, "O" except Explanatory Plan  
36262, "P", "Q", "R", all of D.L. 138, Plan 12221; Portion  
of Belmont Avenue.

THE AREA(S) SHOWN ABOVE  
OUTLINED IN BLACK (—)  
IS (ARE) REZONED:

FROM: Small Holdings District (A2)

TO: Residential District Two (R2)

PLANNING DEPARTMENT		THE CORPORATION OF THE DISTRICT OF BURNABY	
SCALE		OFFICIAL ZONING MAP	
DRAWN			
DATE			
		No. RZ	