

THE CORPORATION OF THE DISTRICT OF BURNABY

BY-LAW NO. 7031

A BY-LAW to amend By-Law No. 4742, being
"Burnaby Zoning By-Law 1965"

WHEREAS application for rezoning has been made to the Council.

AND WHEREAS the Council has held a public hearing thereon after duly giving notice of the time and place of such hearing.

NOW THEREFORE the Council of The Corporation of the District of Burnaby ENACTS as follows:

1. This By-Law may be cited as "BURNABY ZONING BY-LAW 1965, AMENDMENT BY-LAW NO. 20 19 77".

2. The Map (hereinafter called "Map "A"") attached to and forming an integral part of By-Law No. 4742, being "Burnaby Zoning By-Law 1965", and designated as the Official Zoning Map of The Corporation of the District of Burnaby, is hereby amended according to the Maps (hereinafter called "Map "B""), marginally numbered R.Z. 728 a, 728 b, and 728 c annexed to this By-Law, and in accordance with the explanatory legend, notations, references and boundaries designated, described, delimited and specified in particularity shown upon said Map "B"; and the various boundaries and districts shown upon said Map "B" respectively are an amendment of and in substitution for the respective districts, designated and marked on said Map "A" insofar as the same are changed, modified or varied thereby, and the said Map "A" shall be deemed to be and is hereby declared to be amended accordingly and the said Map "B" is hereby declared to be and shall form an integral part of said Map "A", as if originally incorporated therein, and shall be interpreted accordingly.

Read a first time this 25th day of April, 1977

Read a second time this 25th day of April, 1977

Read a third time this 25th day of April, 1977

Reconsidered and adopted by an affirmative vote of at least two-thirds of all the members of the Council present at the meeting at which the vote is taken and entitled to vote on the by-law this 2nd day of May, 1977.



James Hudson
MAYOR
James Hudson
CLERK

BYLAW NUMBER 7031 BEING A BYLAW TO AMEND
 BYLAW NUMBER 4742 BEING THE BURNABY ZONING BYLAW 1965

PROPERTY REZONED TO:

MAP "B"

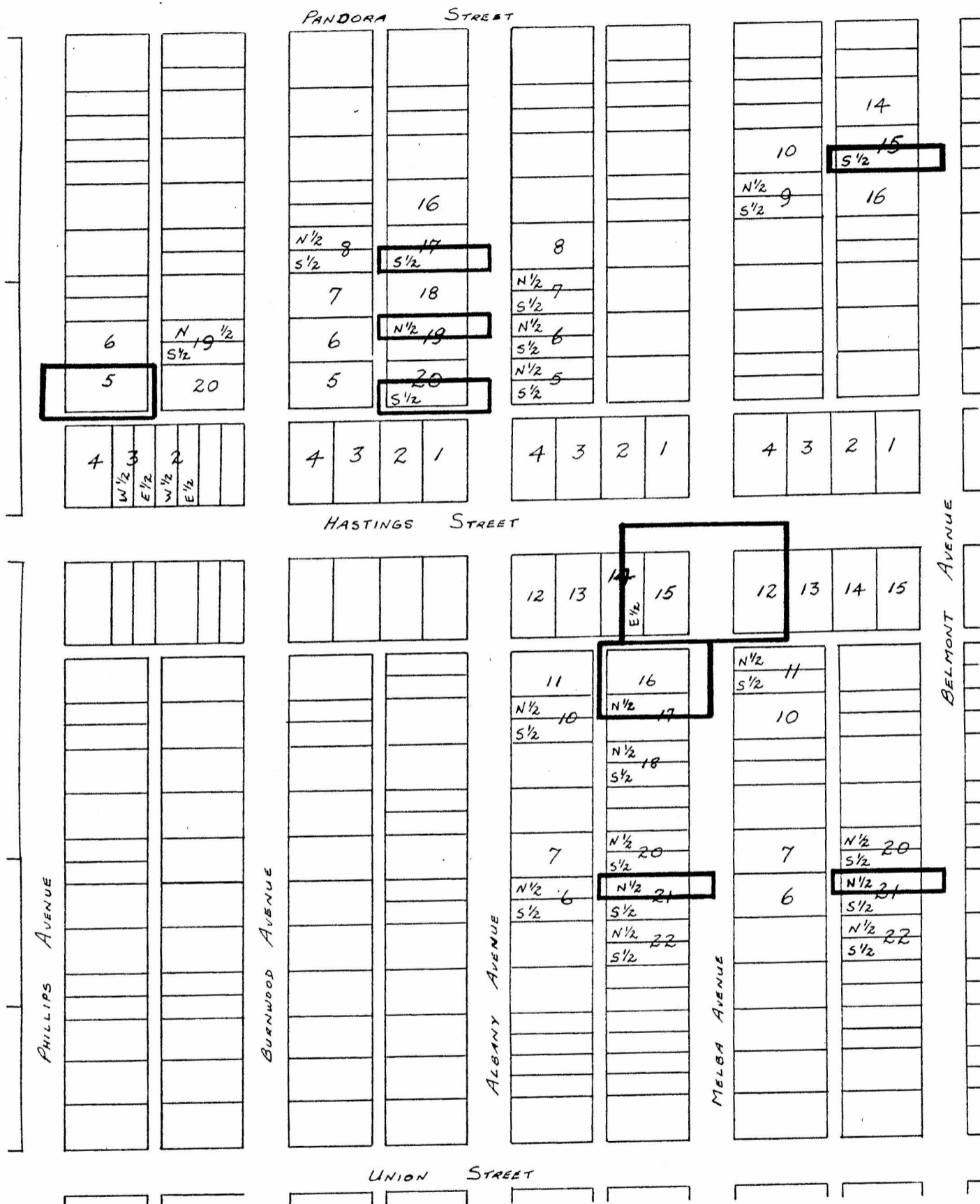

THE AREA(S) SHOWN ABOVE
 OUTLINED IN BLACK (—)
 IS (ARE) REZONED:

FROM: Small Holdings District (A2)
 TO: Park and Public Use District (P3)

| | |
|---------------------|-----------|
| PLANNING DEPARTMENT | |
| SCALE | 1" = 200' |
| DRAWN | SAM |
| DATE | APRIL '77 |

THE CORPORATION OF THE DISTRICT OF BURNABY

OFFICIAL ZONING MAP

BYLAW NUMBER 7031 BEING A BYLAW TO AMEND
BYLAW NUMBER 4742 BEING THE BURNABY ZONING BYLAW 1965

PROPERTY REZONED TO: PARK AND PUBLIC USE DISTRICT (P3)

SCHEDULE I

| <u>LEGAL DESCRIPTION</u> | <u>ADDRESS</u> |
|--|----------------------|
| Lot 5, Blk. 17, D.L. 208, Plan 2501 | 350 Phillips Avenue |
| Lot 17 S 1/2, Blk. 18, D.L. 208, Plan 2501 | 295 Albany Avenue |
| Lot 19 N 1/2, Blk. 18, D.L. 208, Plan 2501 | 325 Albany Avenue |
| Lot 20 S 1/2, Blk. 18, D.L. 208, Plan 2501 | 355 Albany Avenue |
| Lot 15 N 1/2, Blk. 20, D.L. 208, Plan 2501 | 261 Belmont Avenue |
| Lot 14 E 1/2, Blk. 14, D.L. 208, Plan 2501 | 7536 Hastings Street |
| Lot 15, Blk. 14, D.L. 208, Plan 2501 | 7544 Hastings Street |
| Lot 12, Blk. 13, D.L. 208, Plan 2501 | 7556 Hastings Street |
| Lot 16, Blk. 14, D.L. 208, Plan 2501 | 461 Melba Avenue |
| Lot 17 N 1/2, Blk. 14, D.L. 208, Plan 2501 | 487 Melba Avenue |
| Lot 21 N 1/2, Blk. 14, D.L. 208, Plan 2501 | 579 Melba Avenue |
| Lot 21 N 1/2, Blk. 13, D.L. 208, Plan 2501 | 579 Belmont Avenue |

THE AREA(S) SHOWN ABOVE
OUTLINED IN BLACK (—)
IS (ARE) REZONED:

FROM: Small Holdings District (A2)

TO: Park and Public Use District (P3)

| | |
|------------------------|--|
| PLANNING DEPARTMENT | THE CORPORATION OF THE DISTRICT OF BURNABY |
| SCALE | OFFICIAL ZONING MAP |
| DRAWN | |
| DATE | |
| | No. RZ |

BYLAW NUMBER 7031 BEING A BYLAW TO AMEND
BYLAW NUMBER 4742 BEING THE BURNABY ZONING BYLAW 1965

PROPERTY REZONED TO:

MAP "B"

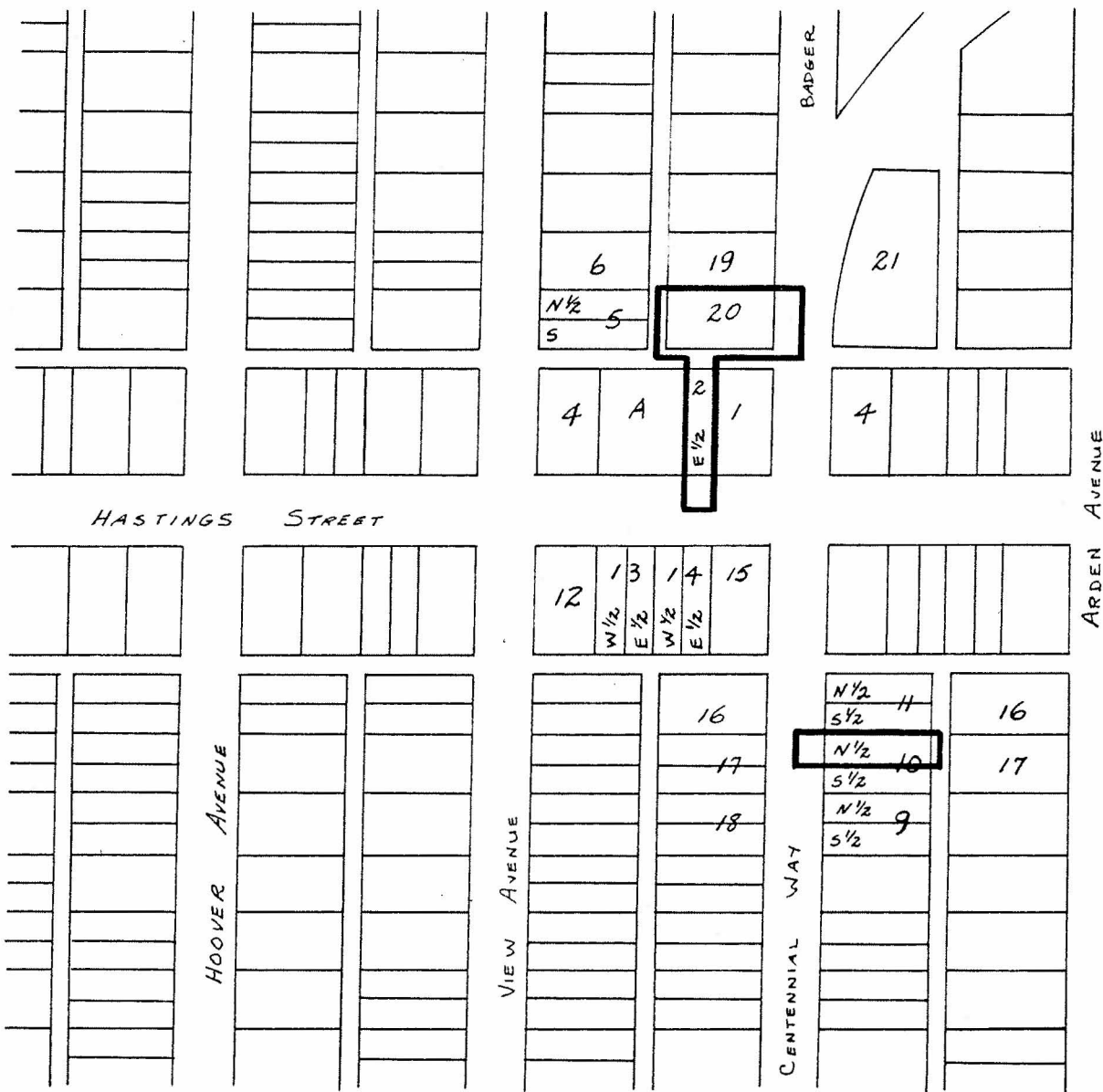

THE AREA(S) SHOWN ABOVE
OUTLINED IN BLACK (—)
IS (ARE) REZONED:

FROM: Small Holdings District (A2)
TO: Park and Public Use District (P3)

| | |
|---------------------|-----------|
| PLANNING DEPARTMENT | |
| SCALE | 1" = 200' |
| DRAWN | SAM |
| DATE | APRIL '77 |

THE CORPORATION OF THE DISTRICT OF BURNABY

OFFICIAL ZONING MAP

BYLAW NUMBER 7031 BEING A BYLAW TO AMEND
 BYLAW NUMBER 4742 BEING THE BURNABY ZONING BYLAW 1965

PROPERTY REZONED TO: PARK AND PUBLIC USE DISTRICT (P3)

SCHEDULE II

| <u>LEGAL DESCRIPTION</u> | <u>ADDRESS</u> |
|---|----------------------|
| Lot 20, Blk. 23, D.L. 208, Plan 2501 | 383 Centennial Way |
| Lot 2 E 1/2, Blk. 23, D.L. 208, Plan 2501 | 7735 Hastings Street |
| Lot 10 N 1/2, Blk. 9, D.L. 208, Plan 2501 | 464 Centennial Way |

THE AREA(S) SHOWN ABOVE
 OUTLINED IN BLACK (—)
 IS (ARE) REZONED:

FROM: Small Holdings District (A2)

TO: Park and Public Use District (P3)

| | |
|------------------------|--|
| PLANNING DEPARTMENT | THE CORPORATION OF THE DISTRICT OF BURNABY |
| SCALE | OFFICIAL ZONING MAP No. RZ |
| DRAWN | |
| DATE | |

BYLAW NUMBER 7031 BEING A BYLAW TO AMEND
 BYLAW NUMBER 4742 BEING THE BURNABY ZONING BYLAW 1965

PROPERTY REZONED TO: PARK AND PUBLIC USE DISTRICT (P3)

MAP "B"

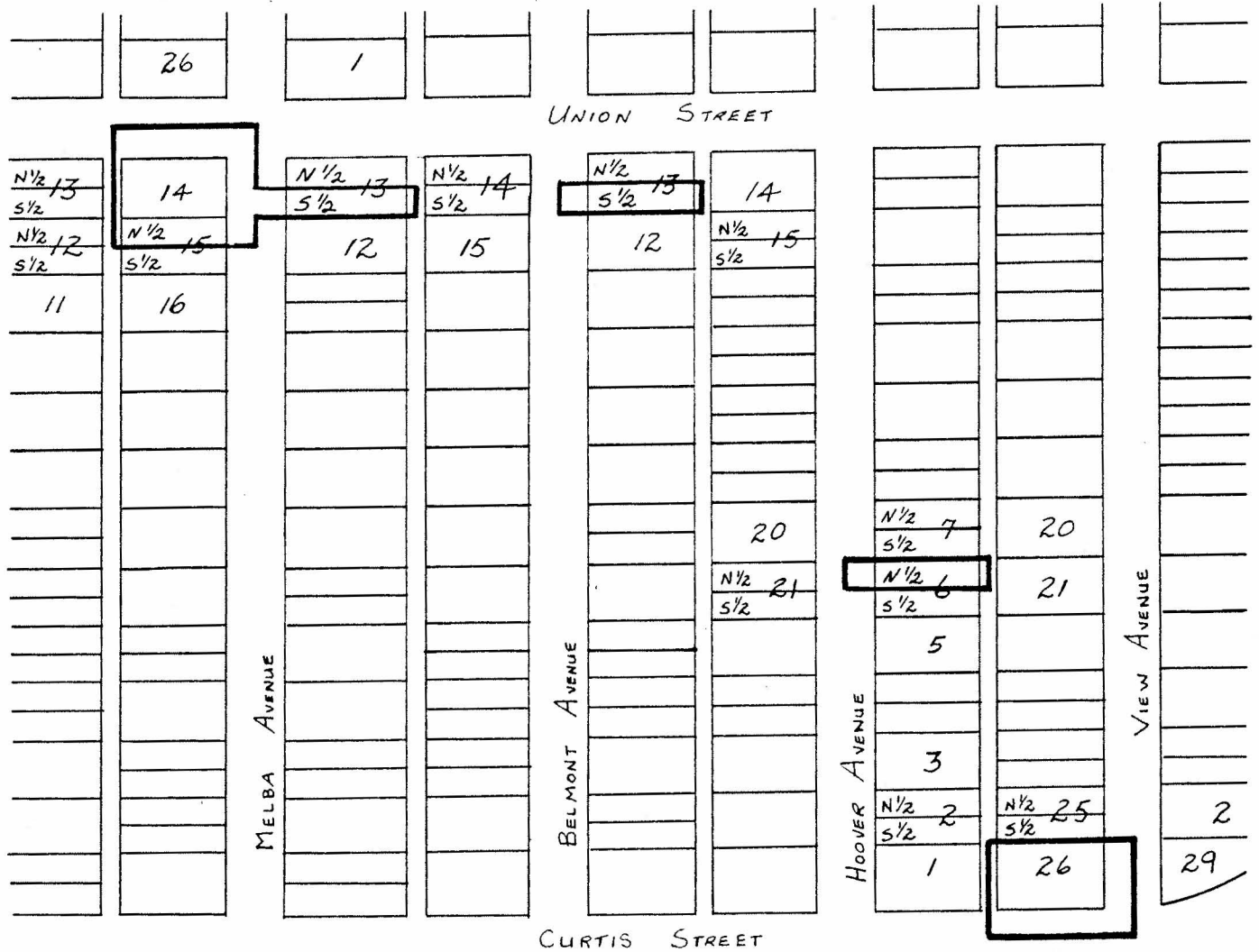

THE AREA(S) SHOWN ABOVE
 OUTLINED IN BLACK (—)
 IS (ARE) REZONED:

FROM: Small Holdings District (A2)
 TO: Park and Public Use District (P3)



| | | | |
|---------------------|-----------|--|--|
| PLANNING DEPARTMENT | | THE CORPORATION OF THE DISTRICT OF BURNABY | |
| SCALE | 1" = 200' | <h1>OFFICIAL ZONING MAP</h1> <p>No. RZ 728 c</p> | |
| DRAWN | SAM | | |
| DATE | APRIL '77 | | |

BYLAW NUMBER 7031 BEING A BYLAW TO AMEND
 BYLAW NUMBER 4742 BEING THE BURNABY ZONING BYLAW 1965

PROPERTY REZONED TO: PARK AND PUBLIC USE DISTRICT (P3)

SCHEDULE III

| <u>LEGAL DESCRIPTION</u> | <u>ADDRESS</u> |
|---|----------------------|
| Lot 14, Blk. 3, D.L. 208, Plan 2501 | 711 Melba Avenue - |
| Lot 15 N 1/2, Blk. 3, D.L. 208, Plan 2501 | 731 Melba Avenue - |
| Lot 13 S 1/2, Blk. 4, D.L. 208, Plan 2501 | 720 Melba Avenue - |
| Lot 13 S 1/2, Blk. 5, D.L. 208, Plan 2501 | 734 Belmont Avenue - |
| Lot 6 N 1/2, Blk. 6, D.L. 208, Plan 2501 | 916 Hoover Avenue - |
| Lot 26, Blk. 6, D.L. 208, Plan 2501 | 987 View Avenue - |

THE AREA(S) SHOWN ABOVE
 OUTLINED IN BLACK (—)
 IS (ARE) REZONED:

FROM: Small Holdings District (A2)
 TO: Park and Public Use District (P3)

| | |
|---------------------|--|
| PLANNING DEPARTMENT | THE CORPORATION OF THE DISTRICT OF BURNABY |
| SCALE | OFFICIAL ZONING MAP No. RZ |
| DRAWN | |
| DATE | |