

THE CORPORATION OF THE DISTRICT OF BURNABY

BY-LAW NO. 6737

A BY-LAW to amend By-law No. 4742 , being
"Burnaby Zoning By-law 1965".

WHEREAS application for rezoning has been made to
the Council.

AND WHEREAS the Council has held a public hearing
thereon after duly giving notice of the time and place of
such hearing.

NOW THEREFORE the Council of The Corporation of the
District of Burnaby ENACTS as follows:

1. This By-law may be cited as "BURNABY ZONING BY-LAW
1965, AMENDMENT BY-LAW NO.50 , 1975".
2. The Map (hereinafter called "Map "A'") attached to
and forming an integral part of By-law No. 4742, being "Burnaby
Zoning By-law 1965", and designated as the Official Zoning Map
of The Corporation of the District of Burnaby, is hereby amended
according to the Map (hereinafter called "Map "B'"), marginally
numbered R.Z. 638 , annexed to this By-law, and in
accordance with the explanatory legend, notations, references
and boundaries designated, described, delimited and specified
in particularity shown upon said Map "B"; and the various boun-
daries and districts shown upon said Map "B" respectively are
an amendment of and in substitution for the respective districts,
designated and marked on said Map "A" insofar as the same are
changed, modified or varied thereby, and the said Map "A" shall
be deemed to be and is hereby declared to be amended accord-
ingly and the said Map "B" is hereby declared to be and shall
form an integral part of said Map "A" as if originally incor-
porated therein and shall be interpreted accordingly.

3.

Read a first time this 27th day of October , 1975.

Read a second time this 27th day of October , 1975.

Read a third time this 8th day of December , 1975.

Reconsidered and adopted by an affirmative vote of
at least two-thirds of all the members of the council this
15th day of December , 1975.

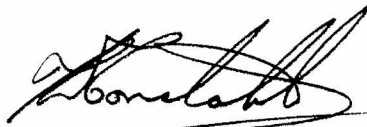

M A Y O R



C L E R K



BYLAW NUMBER 6737 BEING A BYLAW TO AMEND
 BYLAW NUMBER 4742 BEING THE BURNABY ZONING BYLAW 1965

PROPERTY REZONED TO: Amended Comprehensive Development District (CD)

Lot 40, D.L. 79, Plan 47720

MAP "B"

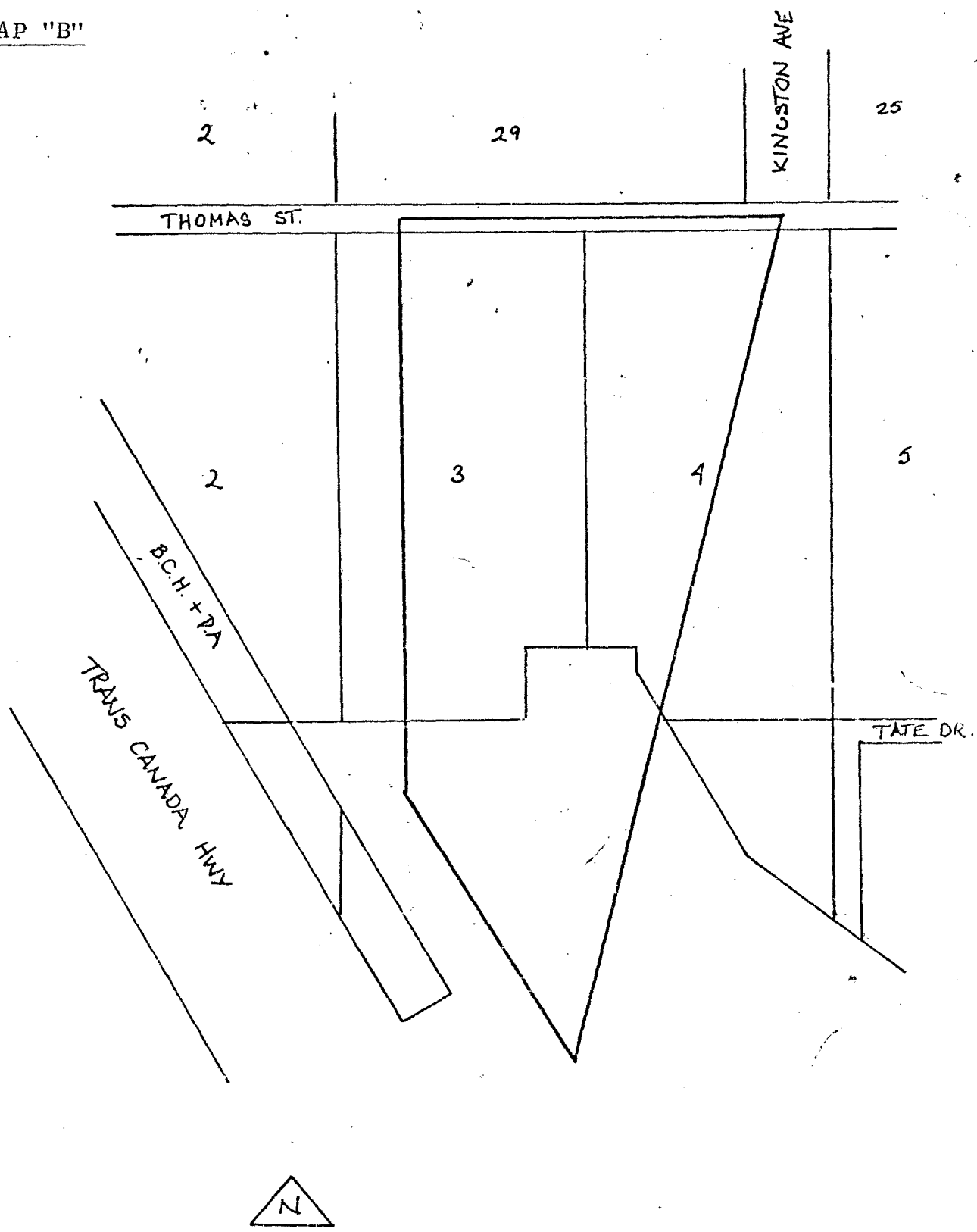

THE AREA(S) SHOWN ABOVE
 OUTLINED IN BLACK (---)
 IS (ARE) REZONED:

FROM: Comprehensive Development District (CD).
 TO: Amended Comprehensive Development District

PLANNING DEPARTMENT	
SCALE	1:2000
DRAWN	7/85
DATE	Oct 1975

THE CORPORATION OF THE DISTRICT OF BURNABY

OFFICIAL ZONING MAP

208