

THE CORPORATION OF THE DISTRICT OF BURNABY

BY-LAW NO. 6538

A BY-LAW to amend By-Law No. 4742, being  
"Burnaby Zoning By-Law 1965"

WHEREAS application for rezoning has been made to the Council.

AND WHEREAS the Council has held a public hearing thereon after duly giving notice of the time and place of such hearing.

NOW THEREFORE the Council of The Corporation of the District of Burnaby ENACTS as follows:

1. This By-Law may be cited as "BURNABY ZONING BY-LAW 1965, AMENDMENT BY-LAW NO. 54, 1974".

2. The Map (hereinafter called "Map 'A'") attached to and forming an integral part of By-Law No. 4742, being "Burnaby Zoning By-Law 1965", and designated as the Official Zoning Map of The Corporation of the District of Burnaby, is hereby amended according to the Map (hereinafter called "Map 'B'"), marginally numbered R.Z. 563, annexed to this By-Law, and in accordance with the explanatory legend, notations, references and boundaries designated, described, delimited and specified in particularity shown upon said Map "B"; and the various boundaries and districts shown upon said Map "B" respectively are an amendment of and in substitution for the respective districts, designated and marked on said Map "A" insofar as the same are changed, modified or varied thereby, and the said Map "A" shall be deemed to be and is hereby declared to be amended accordingly and the said Map "B" is hereby declared to be and shall form an integral part of said Map "A", as if originally incorporated therein, and shall be interpreted accordingly.

3. The Comprehensive Development Plan entitled "Residential Complex, Burnaby, B.C., Inverness Estates", prepared by Jones, Haave, Delgatty, Architects, and comprising sheets marked A1 to A30 inclusive, together with Landscape Plans marked L1 to L6 inclusive, deposited with and signed by the Municipal Clerk, is deemed to be attached to and form part of this By-Law.

Read a first time this 9th day of September 1974.

Read a second time this 9th day of September 1974.

Read a third time this 5th day of August 1975.

Reconsidered and adopted this 17th Day of MARCH, 1980.



MAYOR

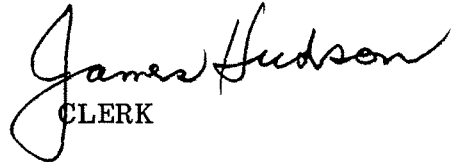

CLERK

BY-LAW NO. 6538 BEING A BY-LAW TO AMEND BY-LAW  
 NO. 4742 BEING THE BURNABY ZONING BY-LAW, 1965

PROPERTY REZONED TO Comprehensive Development District (CD)

- Legal: a) D.L.4, Blk 3 S $\frac{1}{2}$ , S.D. "B", Lot 2 Ex. S.425.59' and Ex. Pt. on Plan 21111, Plan 6913;  
 b) Block 3, S.D. "B" Lot 2 S 425.59', Plan 6913,  
 c) Block 1/8/2 S $\frac{1}{2}$ , Lot "H", Ex. Pl. 15089 and Ex. Pl. 21111, Plan 845;  
 d) Lot 81, Plan 36433 all Group 1, NWD.

MAP "B"

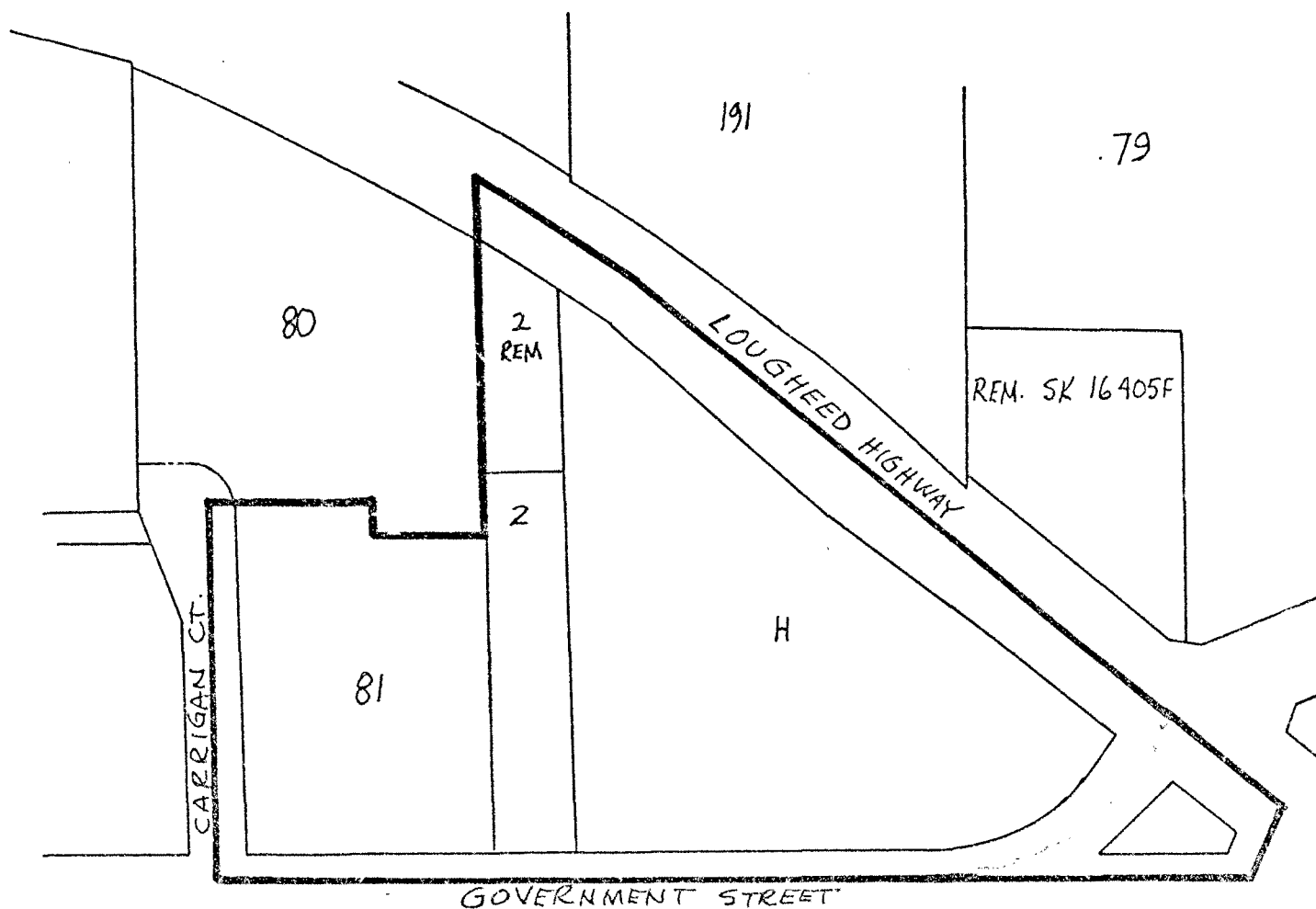

THE AREA(S) SHOWN ABOVE OUTLINED  
 IN BLACK (—) IS (ARE) REZONED:

From: Community Commercial District (C2)  
 Small Holdings District (A2), and  
 Comprehensive Development District (CD)

To: Comprehensive Development District (CD)

*James Hudson*



PLANNING DEPARTMENT

CORPORATION OF THE DISTRICT OF BURNABY

SCALE 1" = 200'

DRAWN DB

OFFICIAL ZONING MAP

DATE OCT 1974

NO RZ 503