

THE CORPORATION OF THE DISTRICT OF BURNABY

BY-LAW NO. 6406

A BY-LAW to amend By-Law No. 4742, being
"Burnaby Zoning By-Law 1965"

WHEREAS application for rezoning has been made to the Council.

AND WHEREAS the Council has held a public hearing thereon after duly giving notice of the time and place of such hearing.

NOW THEREFORE the Council of The Corporation of the District of Burnaby ENACTS as follows:

1. This By-law may be cited as "BURNABY ZONING BY-LAW 1965, AMENDMENT BY-LAW NO. 45, 1973".
2. The Map (hereinafter called "Map "A'") attached to and forming an integral part of By-Law No. 4742, being "Burnaby Zoning By-Law 1965", and designated as the Official Zoning Map of The Corporation of the District of Burnaby, is hereby amended according to the Map (hereinafter called "Map "B'"), marginally numbered R.Z. 525, annexed to this By-law, and in accordance with the explanatory legend, notations, references and boundaries designated, described, delimited and specified in particularity shown upon said Map "B"; and the various boundaries and districts shown upon said Map "B" respectively are an amendment of and in substitution for the respective districts, designated and marked on said Map "A" insofar as the same are changed, modified or varied thereby, and the said Map "A" shall be deemed to be and is hereby declared to be amended accordingly and the said Map "B" is hereby declared to be and shall form an integral part of said Map "A", as if originally incorporated therein and shall be interpreted accordingly.
3. The Comprehensive Development Plan entitled "Proposed Addition to Sheraton Villa Inn, Burnaby, B. C.", prepared by Lort & Lort, Architects, and comprising Sheets marked 1 to 7 inclusive

and 1 to 5 inclusive, together with planting plans numbered 1 to 3 inclusive, deposited with and signed by the Municipal Clerk, is deemed to be attached to and form part of this by-law.

Read a first time this 26th day of November, 1973

Read a second time this 26th day of November, 1973.

Read a third time this 4th day of March, 1974.

Reconsidered and adopted by an affirmative vote of at least two-thirds of all the members of the Council this 8th day of April, 1974.



M A Y O R



C L E R K



BY-LAW NO. 6406 BEING A BY-LAW TO AMEND BY-LAW
 NO. 4742 BEING THE BURNABY ZONING BY-LAW, 1965

PROPERTY REZONED TO Comprehensive Development District (CD)

Legal: D.L. 70, W 1/2 Lot 10, Plan 3216 exc. pt. on Plan 26625
 D.L. 70, Blk. 11, Lot A ex. F. 569.25', Plan 9892
 D.L. 70F, W 1/2 and F 1/2 Lot 10, Plan 3216

MAP "B"

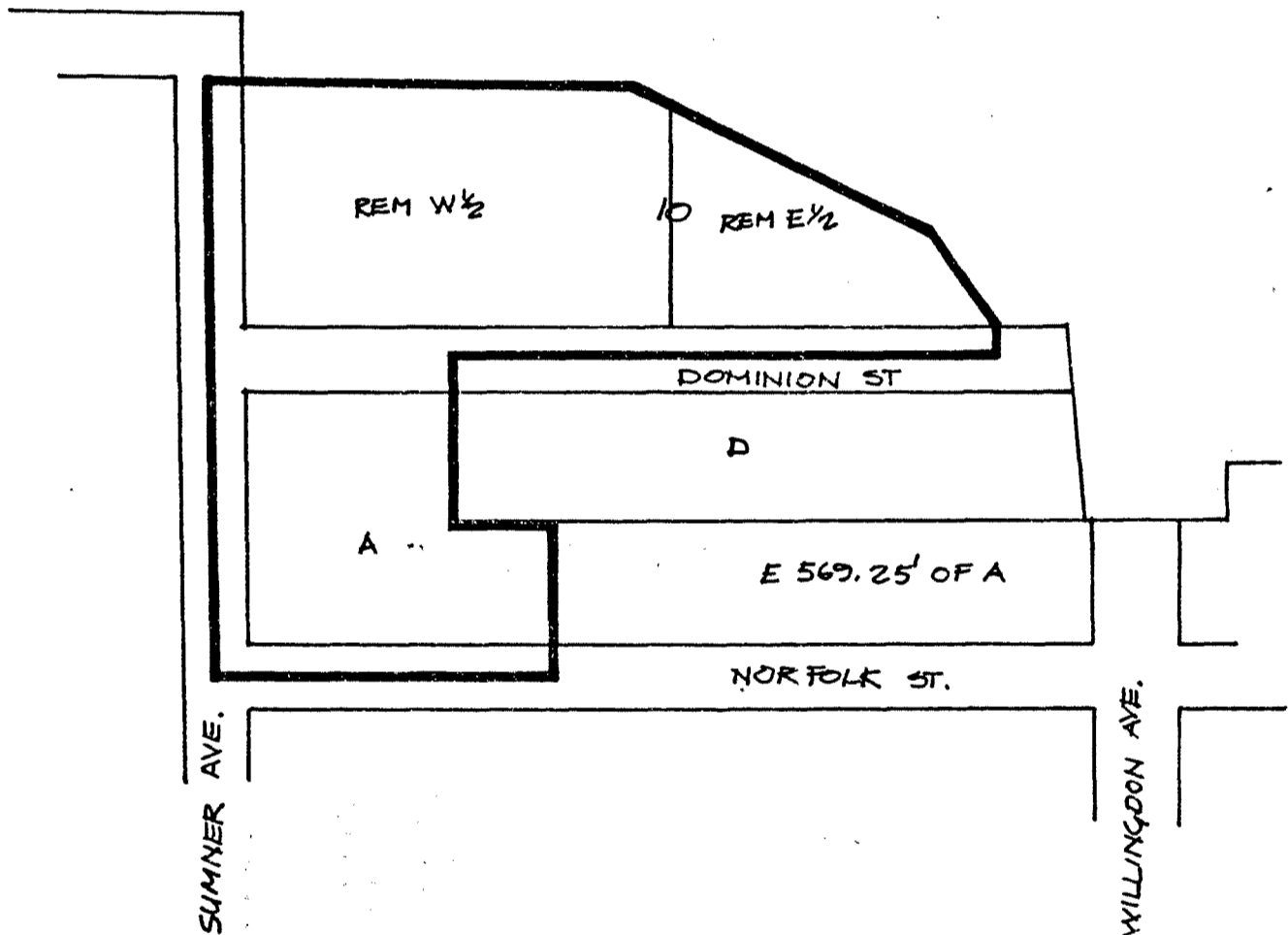

THE AREA(S) SHOWN ABOVE OUTLINED
 IN BLACK (—) IS (ARE) REZONED:

FROM: M2 General Industrial District and
 C5 Tourist Commercial District
 TO: Comprehensive Development District (CD)



PLANNING DEPARTMENT	
SCALE	1"=200'
DRAWN	lbb
DATE	APRIL '74

CORPORATION OF THE DISTRICT OF BURNABY

OFFICIAL ZONING MAP

NO RZ 525