

THE CORPORATION OF THE DISTRICT OF BURNABY

BY-LAW NO. 6320

A BY-LAW to amend By-Law No. 4742, being
"Burnaby Zoning By-Law 1965".

WHEREAS application for rezoning has been made to the Council.

AND WHEREAS the Council has held a public hearing thereon after duly giving notice of the time and place of such hearing.

NOW THEREFORE the Council of The Corporation of the District of Burnaby ENACTS as follows:

1. This By-law may be cited as "BURNABY ZONING BY-LAW 1965, AMENDMENT BY-LAW NO. 21, 1973".
2. The Map (hereinafter called "Map "A"") attached to and forming an integral part of By-Law No. 4742, being "Burnaby Zoning By-Law 1965", and designated as the Official Zoning Map of The Corporation of the District of Burnaby, is hereby amended according to the Map (hereinafter called Map "B"), marginally numbered R.Z. 497, annexed to this By-law, and in accordance with the explanatory legend, notations, references and boundaries designated, described, delimited and specified in particularity shown upon said Map "B"; and the various boundaries and districts shown upon said Map "B" respectively are an amendment of and in substitution for the respective districts, designated and marked on said Map "A" insofar as the same are changed, modified or varied thereby, and the said Map "A" shall be deemed to be and is hereby declared to be amended accordingly and the said Map "B" is hereby declared to be and shall form an integral part of said Map "A", as if originally incorporated therein and shall be interpreted accordingly.
3. The Comprehensive Development Plan entitled "Cypress Central Office 1973 Addition", prepared by Thompson, Berwick, Pratt & Partners, and comprising Drawings marked A-1 to A-4 inclusive, and Landscape Plan prepared by Don Vaughan & Associates Ltd., Landscape

Architects, deposited with and signed by the Municipal Clerk, is deemed to be attached to and form part of this by-law.

Read a first time this 16th day of July, 1973.

Read a second time this 16th day of July, 1973.

Read a third time this 27th day of August, 1973.

Reconsidered and adopted by an affirmative vote of at least two-thirds of all the members of the Council this 4th day of September, 1973.



Handwritten signature of the Mayor.

MAYOR

Handwritten signature of the Deputy Clerk.

DEPUTY CLERK

BY-LAW NO. 6320 BEING A BY-LAW TO AMEND BY-LAW
 NO. 4742 BEING THE BURNABY ZONING BY-LAW, 1965

PROPERTY REZONED TO Comprehensive Development District (CD)

MAP "B"

Legal: Lot "A" except South 122 feet and
 except Explanatory Plan 14336, Block 36,
 D.L.'s 122/3/4, Plan 4912

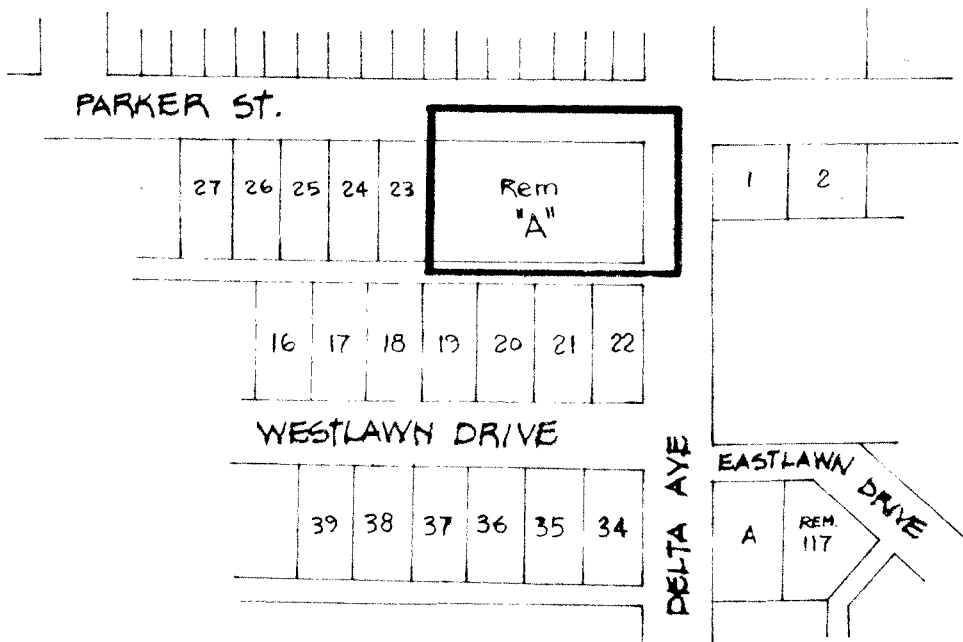

THE AREA(S) SHOWN ABOVE OUTLINED

IN BLACK (—) IS (ARE) REZONED:

FROM: Neighbourhood Institutional District (PI)
 TO: Comprehensive Development District (CD)



P L A N N I N G D E P A R T M E N T	
SCALE	1" = 200'-0"
DRAWN	lbb
DATE	OCT. 1973

CORPORATION OF THE DISTRICT OF BURNABY

OFFICIAL ZONING MAP

NO RZ 497