

THE CORPORATION OF THE DISTRICT OF BURNABY

BY-LAW NO. 6301

A BY-LAW to amend By-Law No. 4742, being  
"Burnaby Zoning By-Law 1965".

WHEREAS application for rezoning has been made to the  
Council.

AND WHEREAS the Council has held a public hearing thereon  
after duly giving notice of the time and place of such hearing.

NOW THEREFORE the Council of The Corporation of the  
District of Burnaby ENACTS as follows:

1. This By-law may be cited as "BURNABY ZONING BY-LAW 1965,  
AMENDMENT BY-LAW NO. 18, 1973".
2. The Map (hereinafter called "Map "A"") attached to and  
forming an integral part of By-Law No. 4742, being "Burnaby Zoning By-  
Law 1965", and designated as the Official Zoning Map of The Corporation  
of the District of Burnaby, is hereby amended according to the Map  
(hereinafter called "Map "B""), marginally numbered R.Z. 500, annexed to  
this By-Law, and in accordance with the explanatory legend, notations,  
references and boundaries designated, described, delimited and specified  
in particularity shown upon said Map "B"; and the various boundaries  
and districts shown upon said Map "B" respectively are an amendment of  
and in substitution for the respective districts, designated and marked  
on said Map "A" insofar as the same are changed, modified or varied  
thereby, and the said Map "A" shall be deemed to be and is hereby  
declared to be amended accordingly and the said Map "B" is hereby  
declared to be and shall form an integral part of said Map "A", as if  
originally incorporated therein and shall be interpreted accordingly.
3. The Comprehensive Development Plan entitled "Green Tree  
Village Residential Development in Burnaby, B. C. for Dawson Develop-  
ments Ltd.", prepared by Michael Katz, Architects, and comprising Sheets  
marked GR2 Condominiums L1 to L8 inclusive, GR2 Single Family 1 to 16

inclusive, E1 to E5 inclusive, and HEF 2 to HEF 11 inclusive, deposited with and signed by the Municipal Clerk, is deemed to be attached to and form part of this by-law.

Read a first time this 18th day of June, 1973.

Read a second time this 18th day of June, 1973.

Read a third time this 20th day of August, 1973.

Reconsidered and adopted by an affirmative vote of at least two-thirds of all the members of the Council this 10th day of September, 1973.



A handwritten signature in cursive script, likely belonging to the Mayor.

M A Y O R

A handwritten signature in cursive script, likely belonging to the Deputy Clerk.

D E P U T Y C L E R K

BY-LAW NO. 6301 BEING A BY-LAW TO AMEND BY-LAW NO. 4742 BEING THE BURNABY ZONING BY-LAW, 1965

PROPERTY REZONED TO CD Comprehensive Development District

Old Legal: Approx. 6.3 acre portion of Lot 1, D.L.'s 73/81, Plan 40648,  
 New Legal: Lots 41 & 42, D.L. 81N, Plan 44669, N.W.D., Grp. 1 N.W.D.

MAP "B"

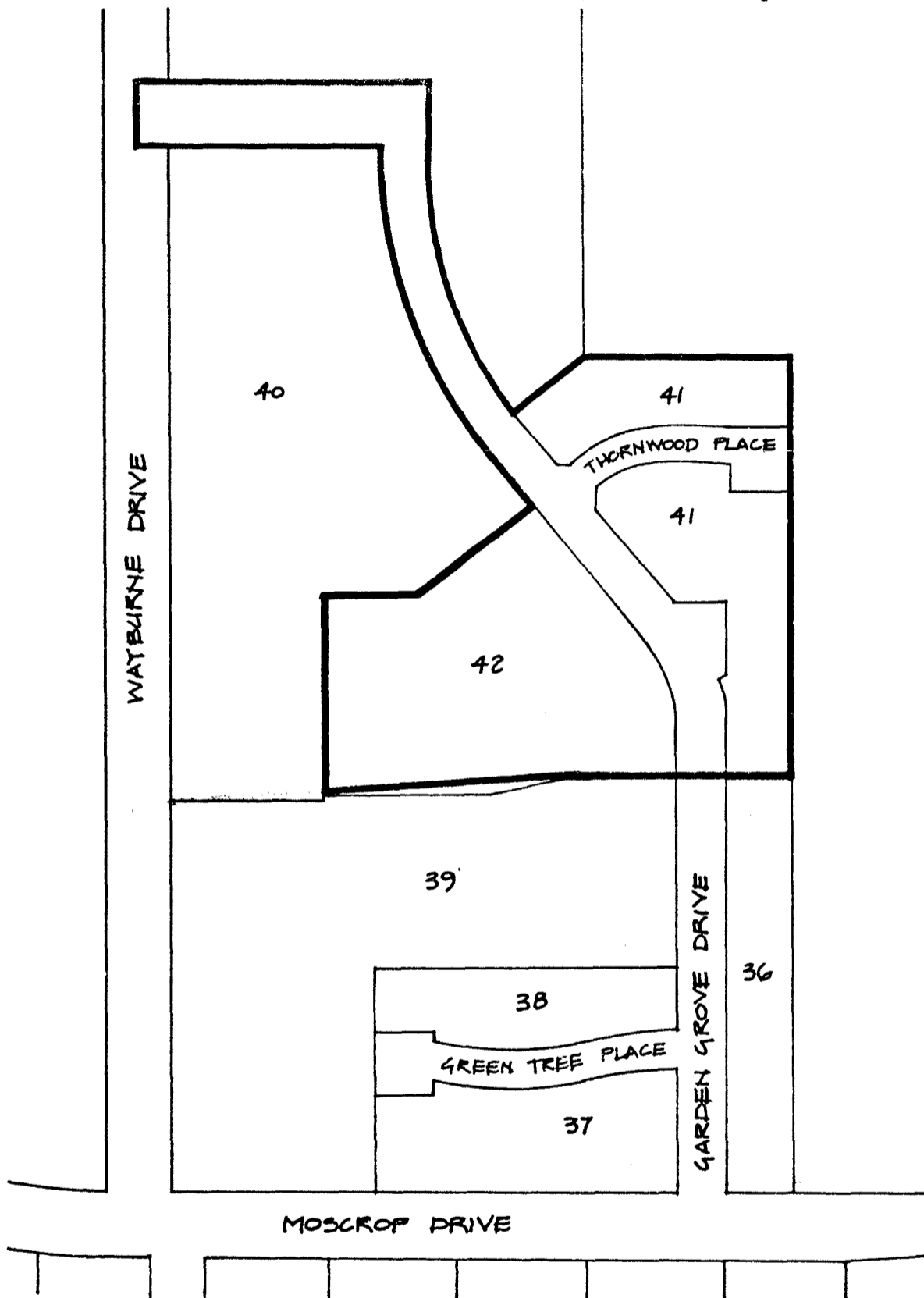

THE AREA(S) SHOWN ABOVE OUTLINED

IN BLACK (—) IS (ARE) REZONED:

FROM: Cemetery District (P4)

TO: Comprehensive Development District (CD)



PLANNING DEPARTMENT	
SCALE	1" = 200'
DRAWN	lbb
DATE	OCT. '73

CORPORATION OF THE DISTRICT OF BURNABY

OFFICIAL ZONING MAP

NO RZ 500