

THE CORPORATION OF THE DISTRICT OF BURNABY

BY-LAW NO. 6270

A BY-LAW to amend By-Law No. 4742, being  
"Burnaby Zoning By-Law 1965"

WHEREAS application for rezoning has been made to  
the Council.

AND WHEREAS the Council has held a public hearing  
thereon after duly giving notice of the time and place of such  
hearing.

NOW THEREFORE the Council of The Corporation of the  
District of Burnaby ENACTS as follows:

1. This By-law may be cited as "BURNABY ZONING BY-LAW  
1965, AMENDMENT BY-LAW NO. 13, 1973".
2. The Map (hereinafter called "Map "A'") attached to  
and forming an integral part of By-Law No. 4742, being "Burnaby  
Zoning By-Law 1965", and designated as the Official Zoning Map  
of The Corporation of the District of Burnaby, is hereby amended  
according to the Map (hereinafter called "Map "B'"), marginally  
numbered R.Z. 571, annexed to this By-Law, and in accordance  
with the explanatory legend, notations, references and boundaries  
designated, described, delimited and specified in particularity  
shown upon said Map "B"; and the various boundaries and districts  
shown upon said Map "B" respectively are an amendment of and in  
substitution for the respective districts, designated and marked  
on said Map "A" insofar as the same are changed, modified or  
varied thereby, and the said Map "A" shall be deemed to be and  
is hereby declared to be amended accordingly and the said Map "B"  
is hereby declared to be and shall form an integral part of said  
Map "A", as if originally incorporated therein and shall be  
interpreted accordingly.

3. The Comprehensive Development Plan entitled "40 Unit Townhouse Condominium for Jordan Developments Corp. Ltd., Ellerslie Ave. & Lougheed Highway, Burnaby, B. C.", prepared by D. M. Sarter, Architect, and comprising sheets marked 1 to 18 inclusive, together with Landscape Plans marked L1 and L2, deposited with and signed by the Municipal Clerk, is deemed to be attached to and form part of this by-law.

Read a first time this 16th day of April, 1973.

Read a second time this 16th day of April, 1973.

Read a third time this 3rd day of September, 1974.

Reconsidered and adopted by an affirmative vote of at least two-thirds of all the members of the Council this 9th day of September, 1974.

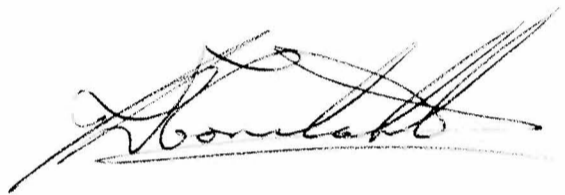

M A Y O R



C L E R K



BY-LAW NO. 6270 BEING A BY-LAW TO AMEND BY-LAW  
 NO. 4742 BEING THE BURNABY ZONING BY-LAW, 1965

PROPERTY REZONED TO CD Comprehensive Development District

Old Legal: Lot 9 exc. Expl. Pl. 11295, Blk. 2, D.L.'s 44/78,  
 Plan 3049  
 Pcl. C, Expl. Pl. 9256, Ex. Ex. Pl. 11295, S.D.'s 7/8,  
 Blk. 2, D.L. 44/78

New Legal: D.L.'s 44/78, Lot 117, Plan 45870

MAP "B"

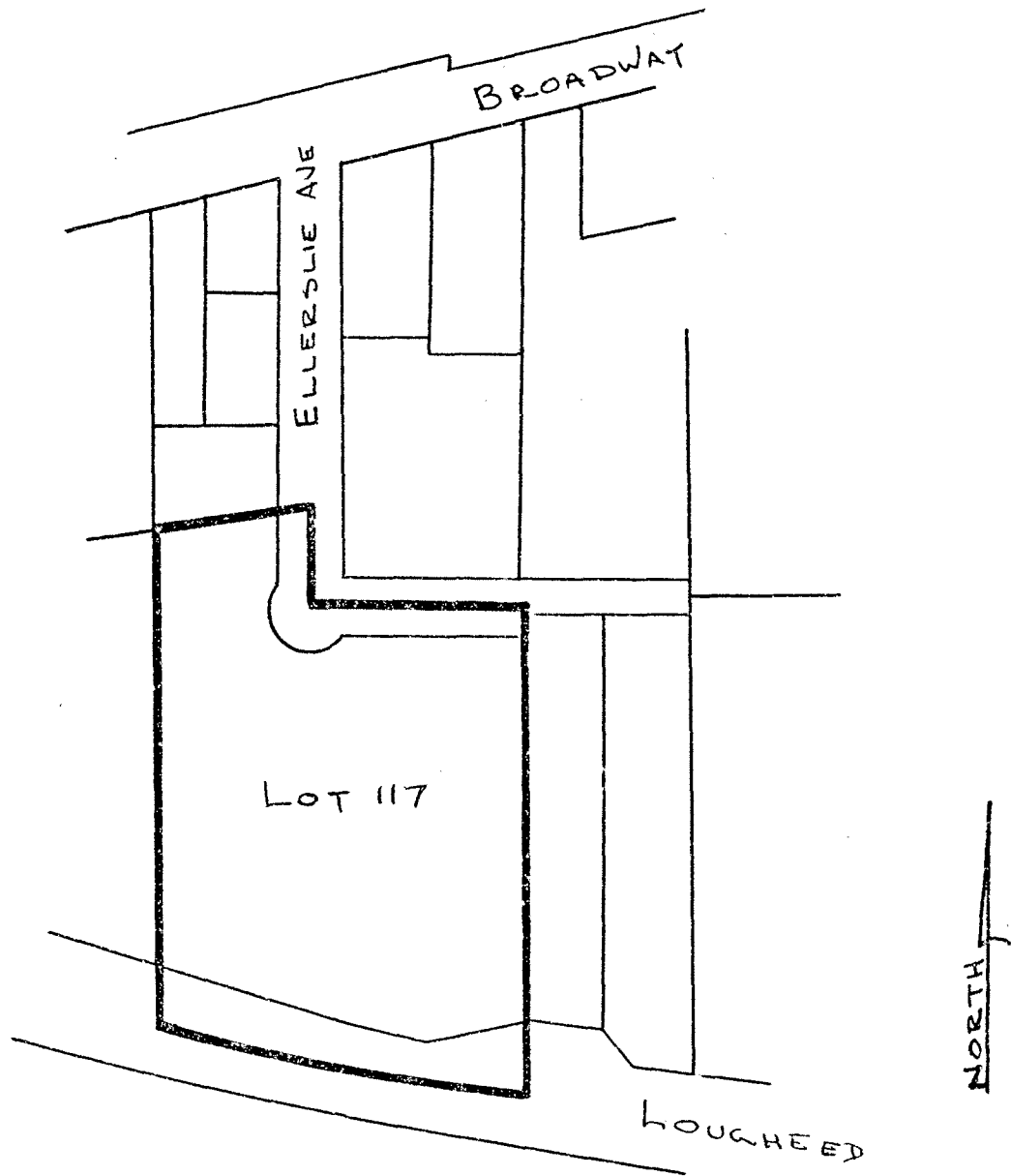

THE AREA(S) SHOWN ABOVE OUTLINED  
 IN BLACK (—) IS (ARE) REZONED:  
 FROM: A2 Small Holdings District  
 TO: CD Comprehensive Development District

PLANNING DEPARTMENT	
SCALE	1" = 200'
DRAWN	HR
DATE	SEPT '66

CORPORATION OF THE DISTRICT OF BURNABY

OFFICIAL ZONING MAP

NO RZ 571