

THE CORPORATION OF THE DISTRICT OF BURNABY

BY-LAW NO. 6224

A BY-LAW to amend By-Law No. 4742, being  
"Burnaby Zoning By-Law 1965.

WHEREAS application for rezoning has been made to the Council.

AND WHEREAS the Council has held a public hearing thereon after duly giving notice of the time and place of such hearing.

NOW THEREFORE the Council of The Corporation of the District of Burnaby ENACTS as follows:

1. This By-law may be cited as "BURNABY ZONING BY-LAW 1965, AMENDMENT BY-LAW NO. 2, 1973".
2. The Map (hereinafter called "Map 'A'"), attached to and forming an integral part of By-Law No. 4742, being "Burnaby Zoning By-Law 1965", and designated as the Official Zoning Map of The Corporation of the District of Burnaby, is hereby amended according to the Map (hereinafter called Map 'B'), marginally numbered R.Z. 486, annexed to this By-law, and in accordance with the explanatory legend, notations, references and boundaries designated, described, delimited and specified in particularity shown upon said Map 'B'; and the various boundaries and districts shown upon said Map 'B' respectively are an amendment of and in substitution for the respective districts, designated and marked on said Map 'A' insofar as the same are changed, modified or varied thereby, and the said Map 'A' shall be deemed to be and is hereby declared to be amended accordingly and the said Map 'B' is hereby declared to be and shall form an integral part of said Map 'A', as if originally incorporated therein and shall be interpreted accordingly.
3. The Comprehensive Development Plan entitled "Winston Street Warehouse Project", prepared by Beedie Construction Co. Ltd., and comprising complete architectural plans and landscape drawings, and on file in the office of the Director of Planning, is deemed to be attached to and form part of this By-law.

Read a first time this 5th day of February, 1973.

Read a second time this 5th day of February, 1973.

Read a third time this 12th day of March, 1973.

Reconsidered and adopted by an affirmative vote of at least two-thirds of all the members of the Council this 26th day of March, 1973.

*Robert A. Pethe*  
MAYOR

*James Hudson*  
CLERK

BY-LAW NO. 622/4 BEING A BY-LAW AMEND BY-LAW  
 NO. 4742 BEING THE BURNABY ZONING BY-LAW, 1965

PROPERTY REZONED TO Comprehensive Development District (CD)

Legal: Block 3/4, Except Explanatory Plan 3389/4, D.L. 40, Plan 29647

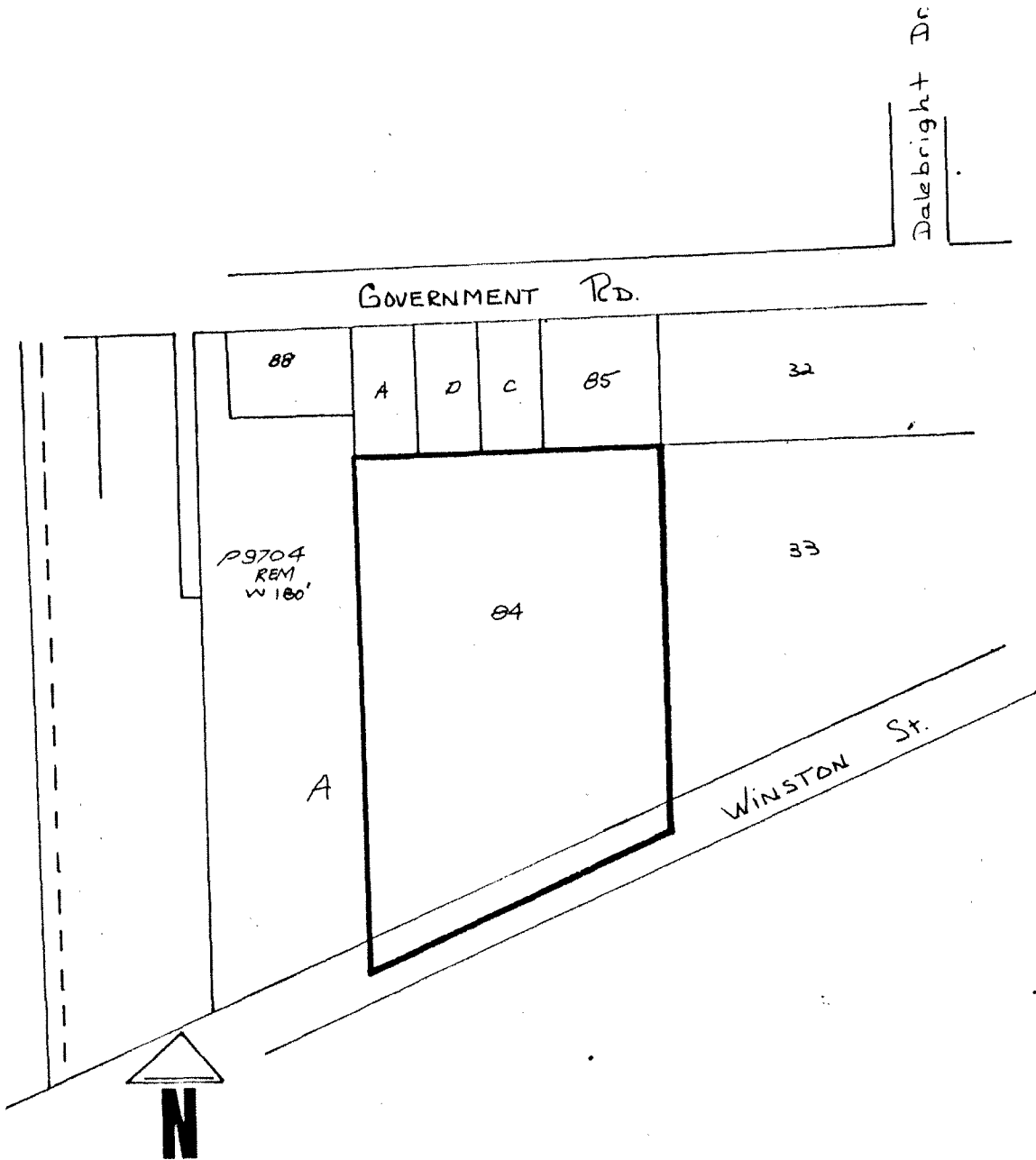

THE AREA(S) SHOWN ABOVE OUTLINED  
 IN BLACK (—) IS (ARE) REZONED:

From: Residential District (R1)  
 To: Comprehensive Development District (CD)

PLANNING DEPARTMENT		CORPORATION OF THE DISTRICT OF BURNABY	
SCALE	1:200	OFFICIAL ZONING MAP	
DRAWN	JH		
DATE	March, 73.		
		NO RZ 486	

BY-LAW NO. 6224

BEING A BY-LAW TO AMEND BY-LAW

NO. 4742 BEING THE BURNABY ZONING BY-LAW, 1965

PROPERTY REZONED TO Comprehensive Development District (CD)

Legal: Block 34, Except Explanatory Plan 33894, D.L. 40, Plan 29647

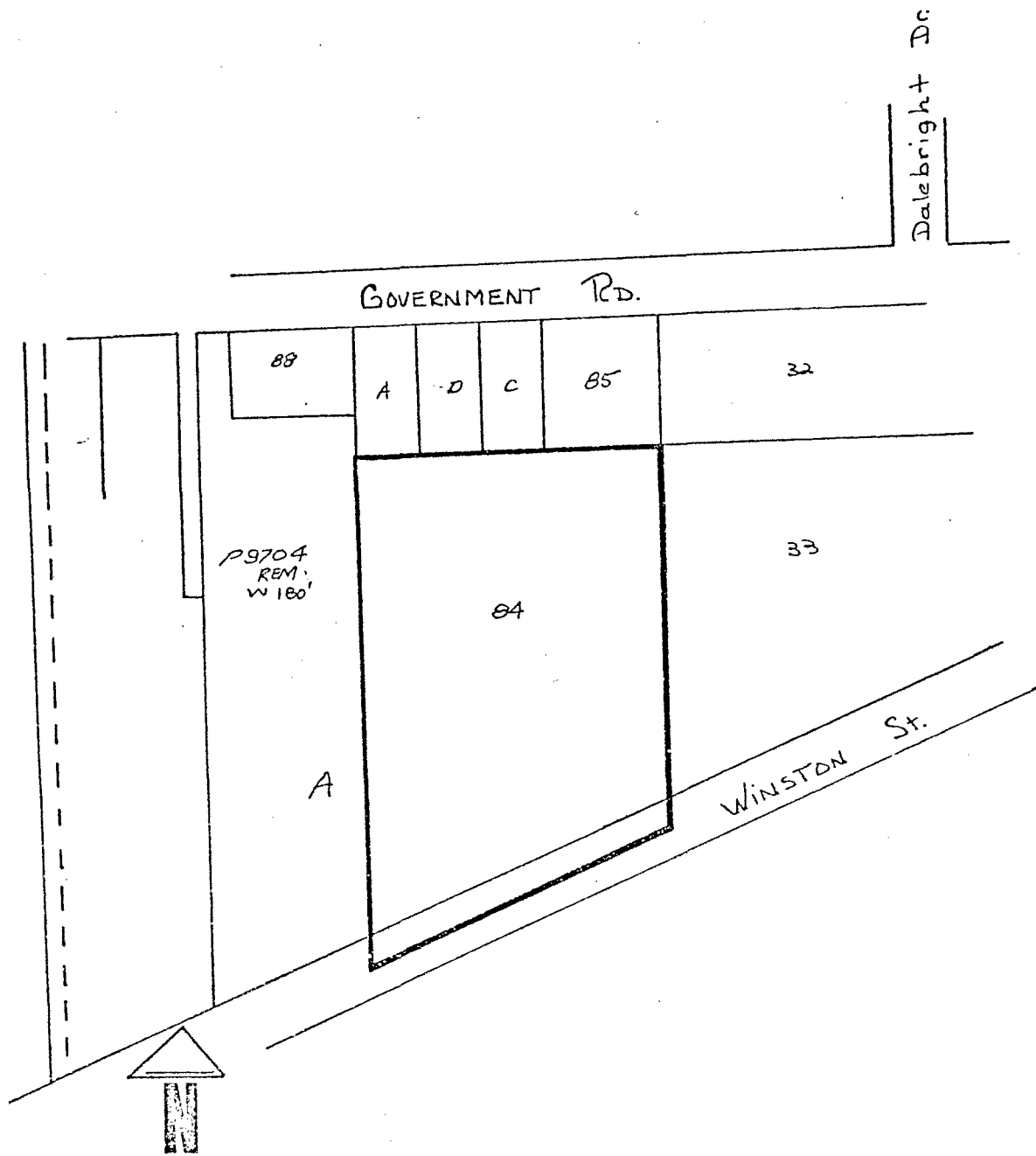

Dalebright Dc

THE AREA(S) SHOWN ABOVE OUTLINED IN BLACK ( ) IS (ARE) REZONED:

From: Residential District (R1)  
To: Comprehensive Development District (CD)

*James Hudson*

PLANNING DEPARTMENT	
SCALE	1:200
DRAWN	JH
DATE	M - L - 75

CORPORATION OF THE DISTRICT OF BURNABY

OFFICIAL ZONING MAP

NO R 7 486