

THE CORPORATION OF THE DISTRICT OF BURNABY

BY-LAW NO. 5908

A BY-LAW To Stop Up and Close to Traffic
Portions of Lane.

WHEREAS those portions of lane shown outlined in red on plan annexed hereto were established as lane by those certain plans deposited in the Land Registry Office at the City of New Westminster, Province of British Columbia, under number 1439.

AND WHEREAS the said portions of lane are no longer required for lane purposes.

NOW THEREFORE the Council of The Corporation of the District of Burnaby ENACTS as follows.

1. This By-Law may be cited as "BURNABY ROAD CLOSING BY-LAW NO. 7, 1971".
2. That portion of lane (hereinafter called the "said portion "A"") being all and singular that certain parcel or tract of land and premises situate, lying and being in the Municipality of Burnaby, in the Province of British Columbia, and being a portion, formerly lane, of the South Half of District Lot One Hundred Sixteen (116), Group One (1), New Westminster District, which said portion is more particularly described in Schedule "A" attached hereto, is hereby stopped up and closed to traffic.
3. The Mayor and Clerk are hereby authorized and empowered to petition the Lieutenant-Governor in Council to abandon the said portion "A" and vest title thereto in The Corporation of the District of Burnaby.

Read a first time this 25th day of May , 1971.

Read a second time this 25th day of May , 1971.

Read a third time this 25th day of May , 1971.

Reconsidered and adopted this 31st day of May , 1971.

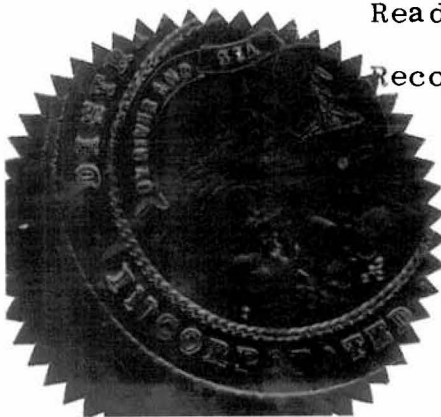

Robert A. Ritchie
MAYOR
J. A. How
CLERK

SCHEDULE "A"

All and singular that certain parcel or tract of land and premises situate, lying, and being in the Municipality of Burnaby, Province of British Columbia, known as a portion of the South $\frac{1}{2}$ of District Lot 116, Group 1, New Westminster District, which portion is lane dedicated by plan 1439 deposited, and which may be described more particularly as being bounded as follows:

Commencing at the northeast corner of Lot 1, Block 16, of the said plan 1439;

thence S $89^{\circ} 06' 30''$ E, and following the straight line joining the northeast corner of the said Lot 1 to the northwest corner of Lot A, Plan 22114, a distance of 16 feet;

thence S $0^{\circ} 01' 00''$ W, and following the west boundary of the said Lot A, a distance of 105.70 feet, more or less, to the southwest corner thereof;

thence N $60^{\circ} 15' 00''$ W, and following the straight line joining the southwest corner of Lot A, aforesaid, to the southeast corner of the said Lot 1, a distance of 18.43 feet, more or less;

thence N $0^{\circ} 01' 00''$ E, and following the east boundary of the said Lot 1, a distance of 96.40 feet, more or less, to the point of commencement.

The herein-described portion contains by calculation 1617 square feet, more or less.

DISTRICT LOT BOUNDARY

ROAD BOUNDARY

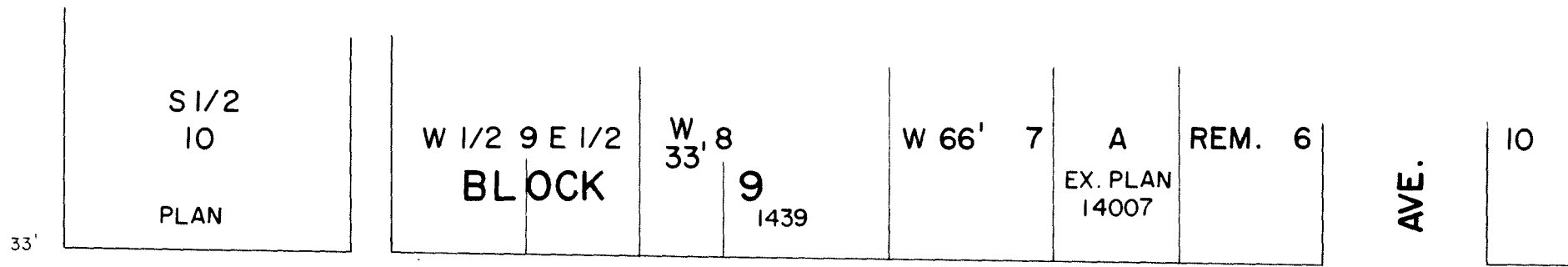

66' **VENABLES STREET** 66'

