

THE CORPORATION OF THE DISTRICT OF BURNABY

BY-LAW NO. 5587

A BY-LAW to Stop Up and Close to Traffic a  
Portion of Road.

WHEREAS that portion of road shown outlined in red on Plan annexed hereto was established as highway by that certain plan deposited in the Land Registry Office at the City of New Westminster, Province of British Columbia, under number 1321.

AND WHEREAS the said portion of road is no longer required for highway purposes.

NOW THEREFORE the Council of The Corporation of the District of Burnaby ENACTS as follows:

1. This By-Law may be cited as "BURNABY ROAD CLOSING BY-LAW NO. 10, 1969".
  
2. That portion of road (hereinafter called the "said portion"), being all and singular that certain parcel or tract of land and premises situate, lying and being in the Municipality of Burnaby, in the Province of British Columbia, and being more particularly known and described as a portion, formerly road, of District Lot Sixty-nine (69), Group One (1), Plan 1321, New Westminster District, which said portion may be more particularly known and described as follows:

Commencing at the North-east corner of Lot 6, Block 45, Plan 1321;

Thence S 89° 04' 00" E, and following the easterly production of the south side of Norfolk Street, a distance of 66.00 feet, more or less, to the north-west corner of Lot 1, Block 46, Plan 1321;

Thence S 0° 04' 00"W, and following the westerly boundary of Block 46, Plan 1321, a distance of 100.00 feet, more or less, to the north-west corner of Lot 12, of the said Block 46;

Thence N 89° 04' 00" W a distance of 66.00 feet, more or less, to the north-east corner of Lot 7, Block 45, Plan 1321;

Thence N 0° 04' 00" E, and following the easterly boundary of Lot 6, of the said Block 45, a distance of 100.00 feet, more or less, to the point of commencement.

The bearings used herein are astronomic and refer to the meridian of Plan 7465.

The herein-described portion of road contains by calculation 0.152 acre, be the same more or less, as shown outlined in red on plan hereunto annexed prepared by B.S. Berting, B.C.L.S., dated the 25th day of September, 1969,

is hereby stopped up and closed to traffic.

3. The Mayor and Clerk are hereby authorized and empowered to petition the Lieutenant-Governor in Council to abandon the said portion and vest title thereto in The Corporation of the District of Burnaby.

Read a first time this 20th day of October, 1969.

Read a second time this 20th day of October, 1969.

Read a third time this 20th day of October, 1969.

Reconsidered and adopted this 27th day of October,

1969.



*Robert W. Pitte*

MAYOR

*J. H. H. H. H.*

CLERK

EXPLANATORY PLAN TO ACCOMPANY CORPORATION OF  
 THE DISTRICT OF BURNABY ROAD CLOSING BY - LAW N<sup>o</sup>.  
 OVER A PORTION OF ROAD IN DISTRICT LOT 69,  
 GROUP I, NEW WESTMINSTER DISTRICT, B.C.

Deposited in the Land Registry  
 Office at New Westminster, B.C.  
 this day of 1969.

Scale: 1 in. = 100 ft.

Registrar

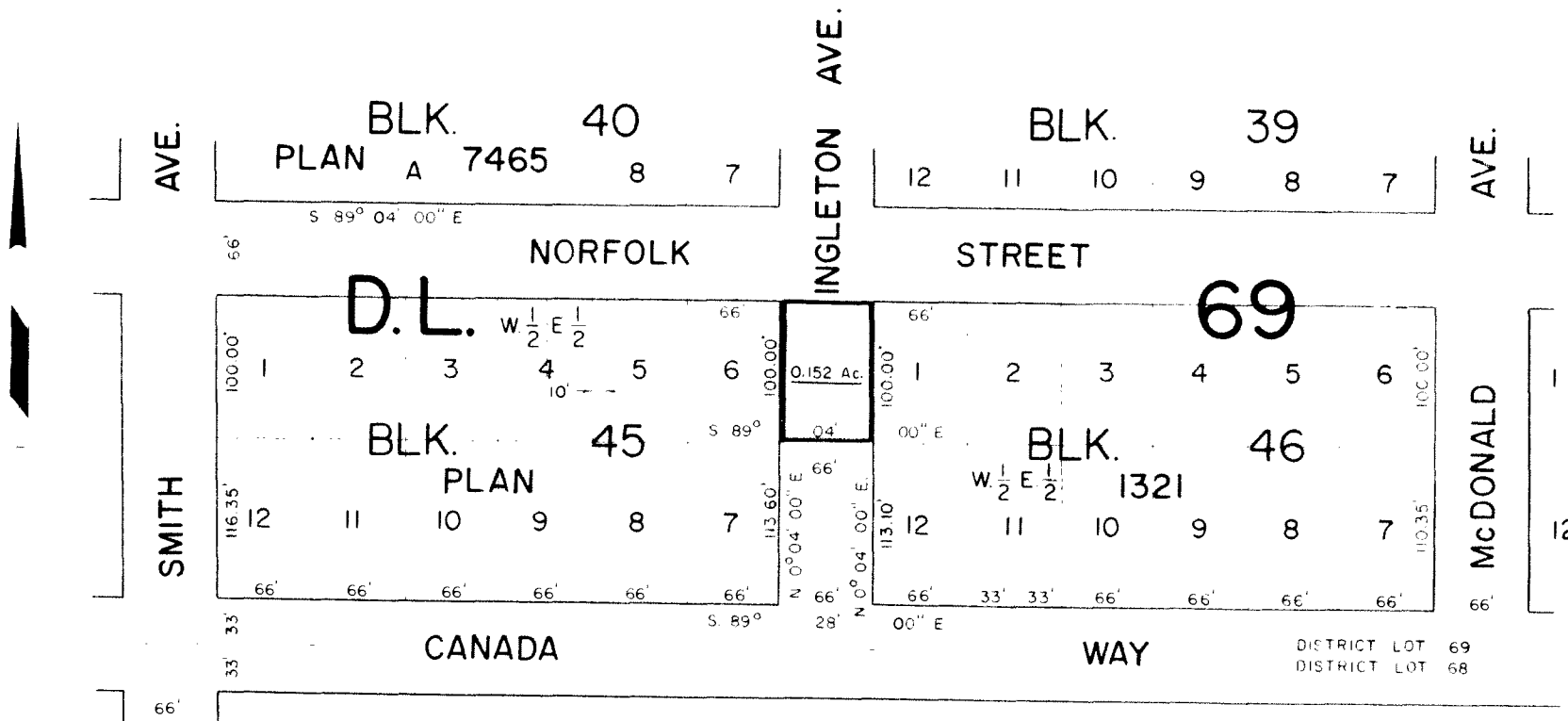

Note: Bearings are astronomic and are  
 derived from Plan 7465.  
 Portion to be closed is shown  
 outlined red.

BOOK OF REFERENCE	
PARCEL	AREA
PORTION OF ROAD	0.152 Ac.

The Corporation of the District  
 of Burnaby.

Mayor:

Municipal Clerk

Certified correct according to Land  
 Registry Office records. Dated  
 this 25th. day of Sept. 1969.

*B. Sterling*

The Corporation of the District of Burnaby,  
 Design Division, Engineering Department,  
 4949 Canada Way, Burnaby 2, B.C.

File 690713(b)