

THE CORPORATION OF THE DISTRICT OF BURNABY

BY-LAW NO. 5562

A BY-LAW to amend By-Law No. 4742, being  
"Burnaby Zoning By-Law 1965".

WHEREAS application for rezoning has been made to the Council.

AND WHEREAS the Council has held a public hearing thereon after duly giving notice of the time and place of such hearing.

NOW THEREFORE the Council of The Corporation of the District of Burnaby ENACTS as follows:

1. This By-law may be cited as "BURNABY ZONING BY-LAW 1965, AMENDMENT BY-LAW NO. 45, 1969".
2. The Map (hereinafter called "Map "A") attached to and forming an integral part of By-Law No. 4742, being "Burnaby Zoning By-Law 1965", and designated as the Official Zoning Map of The Corporation of the District of Burnaby, is hereby amended according to the Map (hereinafter called "Map "B") marginally numbered R.Z. 247, annexed to this By-law, and in accordance with the explanatory legend, notations, references and boundaries designated, described, delimited and specified in particularity shown upon said Map "B"; and the various boundaries and districts shown upon said Map "B" respectively are an amendment of and in substitution for the respective districts, designated and marked on said Map "A" insofar as the same are changed, modified or varied thereby, and the said Map "A" shall be deemed to be and is hereby declared to be amended accordingly and the said Map "B" is hereby declared to be and shall form an integral part of said Map "A", as if originally incorporated therein, and shall be interpreted accordingly.
3. The Comprehensive Development Plan entitled "103 Suite Apartment Building For M. & L. Enterprises Ltd. At Sanders Street in Burnaby, B. C.", prepared by Peter Kaffka, Architect, dated

August, 1969 and comprising site plan, sheets 1 to 9 inclusive, and landscaping plan (sheets 1L and 2L) prepared by Justice & Webb Landscape Architects Ltd. dated August 7, 1969, deposited with and signed by the Municipal Clerk, is deemed to be attached to and form part of this By-law.

Read a first time this 15th day of September, 1969.

Read a second time this 15th day of September, 1969.

Read a third time this 10th day of October, 1969.

Reconsidered and adopted by an affirmative vote of at least two-thirds of all the members of the Council this 20th day of October, 1969.



*Robert W. Pitte*  
MAYOR  
*J. Shaw*  
CLERK

SECTION 16 - COMPREHENSIVE DEVELOPMENT DISTRICT (CDD)

PREPARED BY THE DEVELOPMENT DEPARTMENT

DATE: 29/10/69  
 SCALE: 1:1000  
 SHEET NO. 16

**MAP "B"**

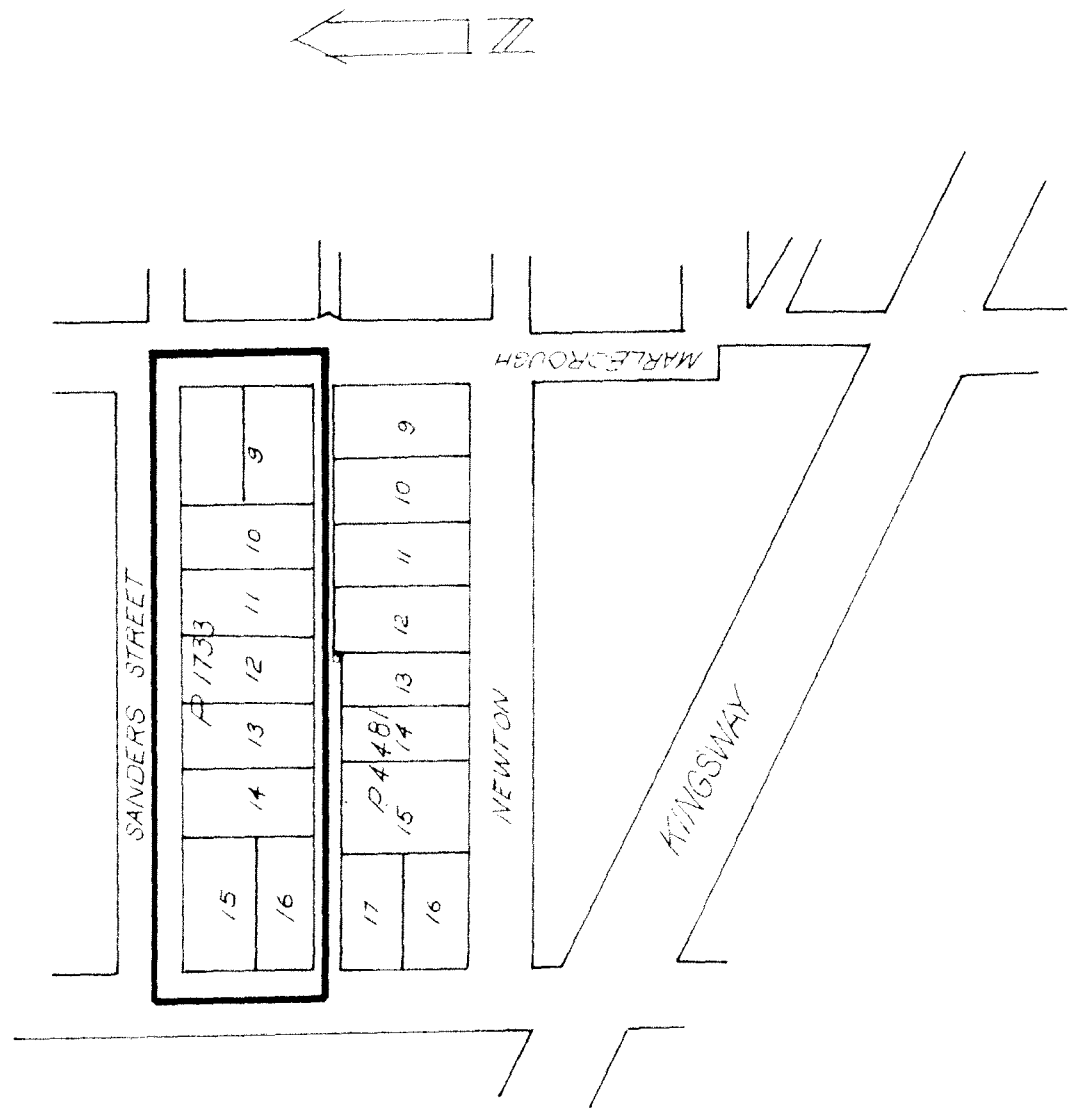

SECTION 16 - COMPREHENSIVE DEVELOPMENT DISTRICT (CDD)

FROM RESIDENTIAL DISTRICT FIVE (R5)  
 TO COMPREHENSIVE DEVELOPMENT DISTRICT (CDD)

CORPORATION OF THE DISTRICT OF BUNNADY

1/1" REP 200'  
 ST  
 29/10/69

**OFFICIAL ZONING MAP**