

THE CORPORATION OF THE DISTRICT OF BURNABY

BY-LAW NO. 5558

A BY-LAW to amend By-Law No. 4742, being  
"Burnaby Zoning By-Law 1965".

WHEREAS application for rezoning has been made to the  
Council.

AND WHEREAS the Council has held a public hearing thereon  
after duly giving notice of the time and place of such hearing.

NOW THEREFORE the Council of The Corporation of the  
District of Burnaby ENACTS as follows:

1. This By-law may be cited as "BURNABY ZONING BY-LAW 1965,  
AMENDMENT BY-LAW NO. 44, 1969".
2. The Map (hereinafter called "Map "A'") attached to and  
forming an integral part of By-Law No. 4742, being "Burnaby Zoning  
By-Law 1965", and designated as the Official Zoning Map of The  
Corporation of the District of Burnaby, is hereby amended according  
to the Map (hereinafter called "Map "B'"), marginally numbered  
R.Z. 250, annexed to this By-Law, and in accordance with the explana-  
tory legend, notations, references and boundaries designated,  
described, delimited and specified in particularity shown upon said  
Map "B"; and the various boundaries and districts shown upon said  
Map "B" respectively are an amendment of and in substitution for the  
respective districts, designated and marked on said Map "A" insofar  
as the same are changed, modified or varied thereby, and the said  
Map "A" shall be deemed to be and is hereby declared to be amended  
accordingly and the said Map "B" is hereby declared to be and shall  
form an integral part of said Map "A", as if originally incorporated  
therein and shall be interpreted accordingly.
3. The Comprehensive Development Plan entitled "Apartment  
Development in Burnaby, B. C. for Polaris Construction Co. Ltd.",  
prepared by L. O. Lund, Architect, dated the 3rd day of September,  
1969 and comprising sheets 1 to 21 inclusive, and Landscape Develop-  
ment Plan for Polaris Project at Lougheed Highway and Keswick,

Burnaby, B. C. (comprising six sheets) prepared by Philip Tattersfield & Associates Landscape Architects Ltd., deposited with and signed by the Municipal Clerk, is deemed to be attached to and form part of this By-law.

Read a first time this 25th day of August, 1969.

Read a second time this 25th day of August, 1969.

Read a third time this 27th day of October, 1969.

Reconsidered and adopted by an affirmative vote of at least two-thirds of all the members of the Council this 3rd day of November, 1969.

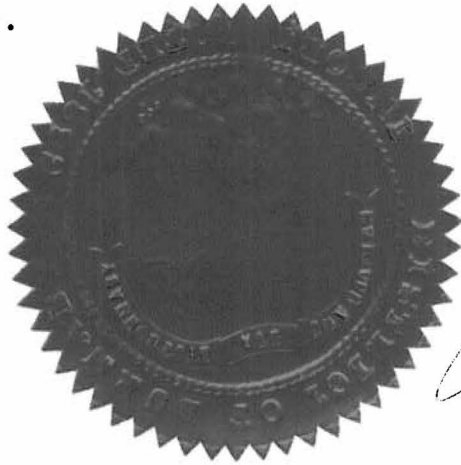

*Robert W. Pitche*

M A Y O R

*J. Shaw*

C L E R K

BY-LAW NO. 5558 BEING A BY-LAW TO AMEND BY-LAW  
 NO. 4742 BEING THE BURNABY ZONING BY-LAW, 1965  
 MAP "B"

PROPERTY REZONED TO COMPREHENSIVE DEVELOPMENT (CD)

- Legal: (a) Lot 1, Block 4, D.L. 4, Plan 11597  
 (b) Parcel "A", Sketch 12778, D.L. 4, Plan 4332  
 (c) Parcel "A" pt. South of Highway except Sketches  
 11929/12778, Block 3, D.L. 4, Plan 4332  
 (d) Block 4 W $\frac{1}{2}$  of S $\frac{1}{2}$  Except the N. 600 feet, D.L. 4, Plan 845  
 (e) N. 600 feet of Block 4 W $\frac{1}{2}$  of S $\frac{1}{2}$ , D.L. 4, Plan 845  
 (f) Parcel "A", Expl. Pl. 11637, Block 4, D.L. 4, Plan 845  
 (g) Lot 1, S.D. "B", Block 3, D.L. 4, Plan 6913  
 (h) Lot "A" of Pl. 2, Sk. 11929, Blk. 3, D.L. 4, Pl. 4332  
 (i) Block 4 N $\frac{1}{2}$  pt. South of Highway, D.L. 4, Plan 845  
 (j) Lot "E" exc. part on Pl. 21111, Blk. 5, D.L. 4, Pl. 18398

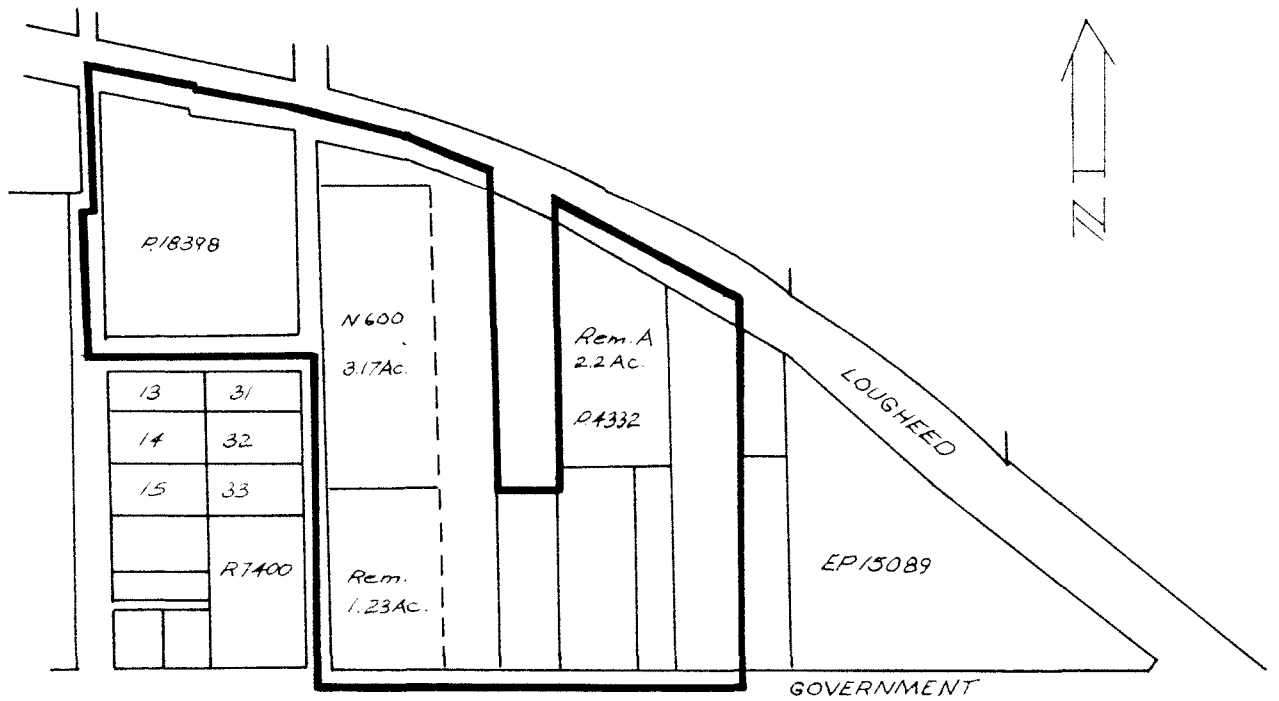

THE AREA SHOWN ABOVE OUTLINED  
 IN BLACK (—) IS (A) REZONED

FROM RESIDENTIAL DISTRICT ONE (R1) AND SMALL HOLDINGS (A2)  
 TO COMPREHENSIVE DEVELOPMENT (CD)

CORPORATION OF THE DISTRICT OF BURNABY

OFFICIAL ZONING MAP

1" REP 400'  
 S.T.  
 18/11/69

NO R Z 250