

THE CORPORATION OF THE DISTRICT OF BURNABY

BY-LAW NO. 5545

A BY-LAW to amend By-Law No. 4742, being
"Burnaby Zoning By-Law 1965"

WHEREAS application for rezoning has ~~been~~ been made to the Council.

AND WHEREAS the Council has held a public hearing thereon after
duly giving notice of the time and place of such hearing.

NOW THEREFORE the Council of The Corporation of the District of
Burnaby ENACTS as follows:

1. This By-Law may be cited as "BURNABY ZONING BY-LAW 1965, AMENDMENT
BY-LAW NO. 42, 19 69'.
2. The Map (hereinafter called "Map "A'") attached to and forming an
integral part of By-Law No. 4742, being "Burnaby Zoning By-Law 1965", and
designated as the Official Zoning Map of The Corporation of the District of
Burnaby, is hereby amended according to the Map (hereinafter called "Map "B'"),
marginally numbered R.Z. 238 , annexed to this By-Law, and in accordance with
the explanatory legend, notations, references and boundaries designated, des-
cribed, delimited and specified in particularity shown upon said Map "B"; and
the various boundaries and districts shown upon said Map "B" respectively are
an amendment of and in substitution for the respective districts, designated
and marked on said Map "A" insofar as the same are changed, modified or varied
thereby, and the said Map "A" shall be deemed to be and is hereby declared to
be amended accordingly and the said Map "B" is hereby declared to be and shall
form an integral part of said Map "A", as if originally incorporated therein,
and shall be interpreted accordingly.

Read a first time this 28th day of July, 19 69.

Read a second time this 28th day of July, 19 69.

Read a third time this 8th day of September 19 69.

Reconsidered and adopted by an affirmative vote of at least two-
thirds of all the members of the Council this 15th day of September, 19 69.



Robert W. Pette
MAYOR
J. Shaw
CLERK

BY-LAW NO. 5545 BEING A BY-LAW TO AMEND BY-LAW
 NO. 4742 BEING THE BURNABY ZONING BY-LAW, 1965
 MAP "B"

PROPERTY REZONED TO PARK AND PUBLIC USE DISTRICT (P3)

- Legal: (a) Lot 23, Blocks 24 & 25, D.L. 159, Plan 1268
 (b) Lot 10, Blocks 11, 16 and 19, D.L. 159, Plan 2043
 (c) Lot 15, Block 10, D.L. 159, Plan 2103
 (d) Lot 19, Blocks 11, 16 and 19, D.L. 159, Plan 2043
 (e) Lot 15, Block 9, D.L. 159, Plan 2103
 (f) Block 8 W $\frac{1}{2}$ exc. North 33 feet and Expl. Pl. 27749,
 D.L. 159, Plan 930
 (g) Lots 4, 5, and 6, Blocks 1 and 5, D.L. 159, Plan 1219
 (h) Lot 62, D.L. 159, Plan 27749

(Ravine Area from McPherson Avenue to Buller Avenue)

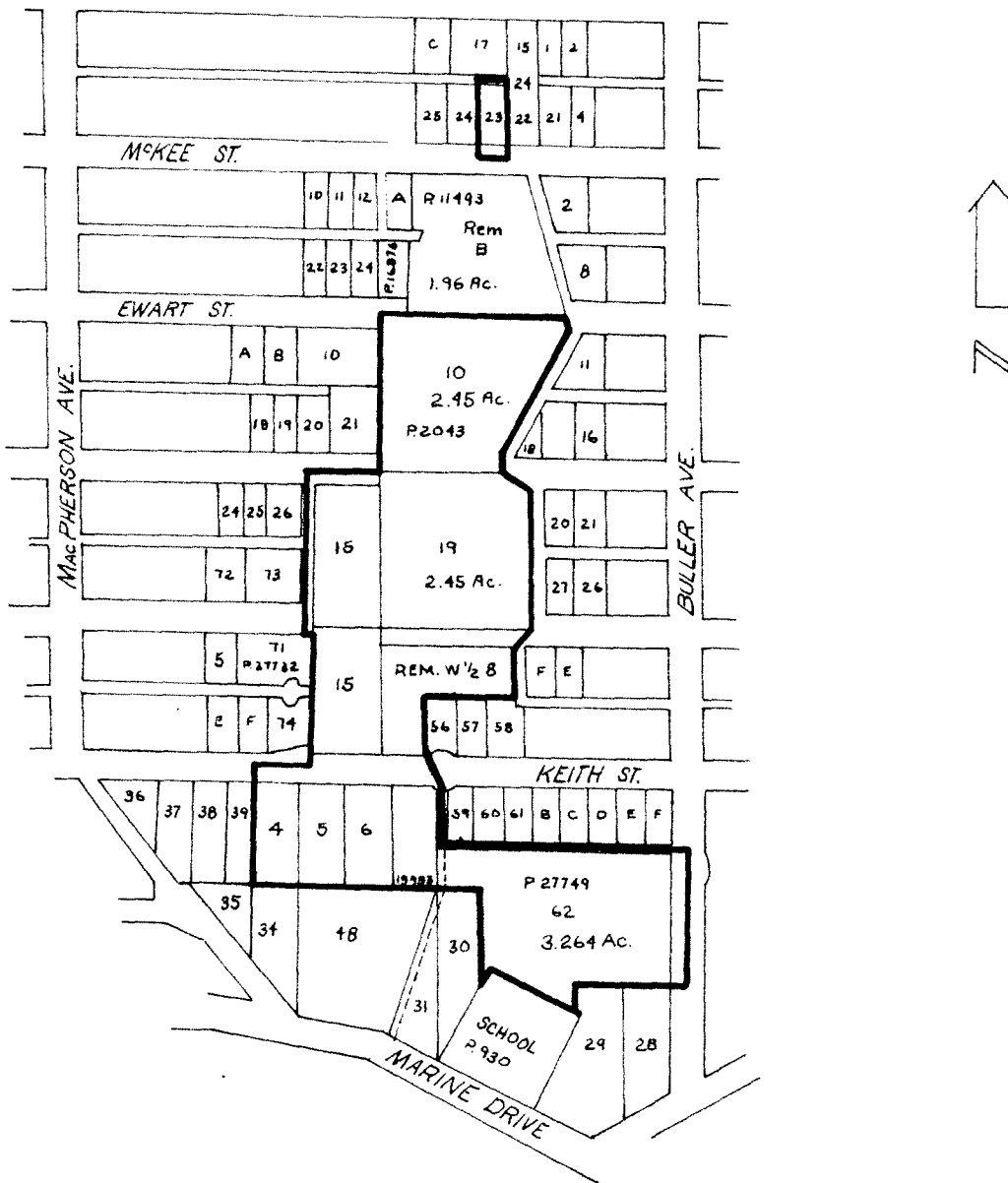

THE AREA(S) SHOWN ABOVE OUTLINED
 IN BLACK (—) IS (ARE) REZONED:

FROM RESIDENTIAL DISTRICT TWO (R2)
 TO PARK AND PUBLIC USE DISTRICT (P3)

PLANNING DEPARTMENT	CORPORATION OF THE DISTRICT OF BURNABY
SCALE 1"=REP. 400'	OFFICIAL ZONING MAP
DRAWN S.T.	
DATE 9/22/69	NO. R.Z. 238