

THE CORPORATION OF THE DISTRICT OF BURNABY

BY-LAW NO. 5453

A BY-LAW to Stop Up and Close to Traffic
a Portion of Road.

WHEREAS that portion of road shown outline in red on Plan annexed hereto was established as highway by that certain plan deposited in the Land Registry Office at the City of New Westminster, Province of British Columbia, under number 1448.

AND WHEREAS the said portion of road is no longer required for highway purposes.

NOW THEREFORE the Council of The Corporation of the District of Burnaby ENACTS as follows:

1. This By-Law may be cited as "BURNABY ROAD CLOSING BY-LAW NO. 10, 1968".

2. That portion of road (hereinafter called the "said portion"), being all and singular that certain parcel or tract of land and premises situate, lying and being in the Municipality of Burnaby, in the Province of British Columbia, and being more particularly known and described as a portion, formerly road, of District Lot Ninety-six (96), Group One (1), Plan 1448, New Westminster District, which said portion is more particularly described as follows:

Commencing at the northwest corner of Lot 32 of Lot 1, Block "C", Plan 1448, thence on a bearing of N 0° 06' 00" E and following the northerly production of the west boundary of said Lot 32, a distance of 16.02 feet, more or less, to the southwest corner of Lot 50, of Lot 1, Block "C", Plan 1448;

Thence on a bearing of N 86° 55' 30" E and following the southerly boundary of Lot 50, a distance of 120.05 feet, more or less, to intersection with the westerly boundary of Hedley Avenue;

Thence S 0° 06' 00" W and following the southerly production of the east boundary of said Lot 50, a distance of 16.02, more or less, to the north-east corner of Lot 31, of Lot 1, Block "C", Plan 1448;

Thence S 86° 55' 30" W, and following the northerly boundaries of said Lots 31 and 32, a distance of 120.05 feet, more or less, to the point of commencement, as shown outlined in red on plan prepared by B.S. Berting, B.C.L.S., dated the 7th day of November, 1968, a copy of which is hereunto annexed,

is hereby stopped up and closed to traffic.

3. The Mayor and Clerk are hereby authorized and empowered to petition the Lieutenant-Governor in Council to abandon the said portion and vest title thereto in Sheward Holdings Ltd.

Read a first time this 25th day of November, 1968.

Read a second time this 25th day of November, 1968.

Read a third time this 25th day of November, 1968.

Reconsidered and adopted this 2nd day of December,

1968.



Handwritten signature of the Mayor.

M A Y O R

Handwritten signature of the Deputy Clerk.

D E P U T Y C L E R K

EXPLANATORY PLAN OF A PORTION
 OF LANE IN DISTRICT LOT 96, GROUP 1,
 NEW WESTMINSTER DISTRICT, TO
 ACCOMPANY ROAD CLOSING BY - LAW
 No. 5453 OF THE CORPORATION OF THE
 DISTRICT OF BURNABY.

Deposited in the Land
 Registry Office at New
 Westminster, B.C. this
 day of _____ 1968

Registrar

Scale: 1 in. = 50 ft.

Bearings are astronomic and are derived from Plan 15552.
 Portion to be closed is shown outlined red.

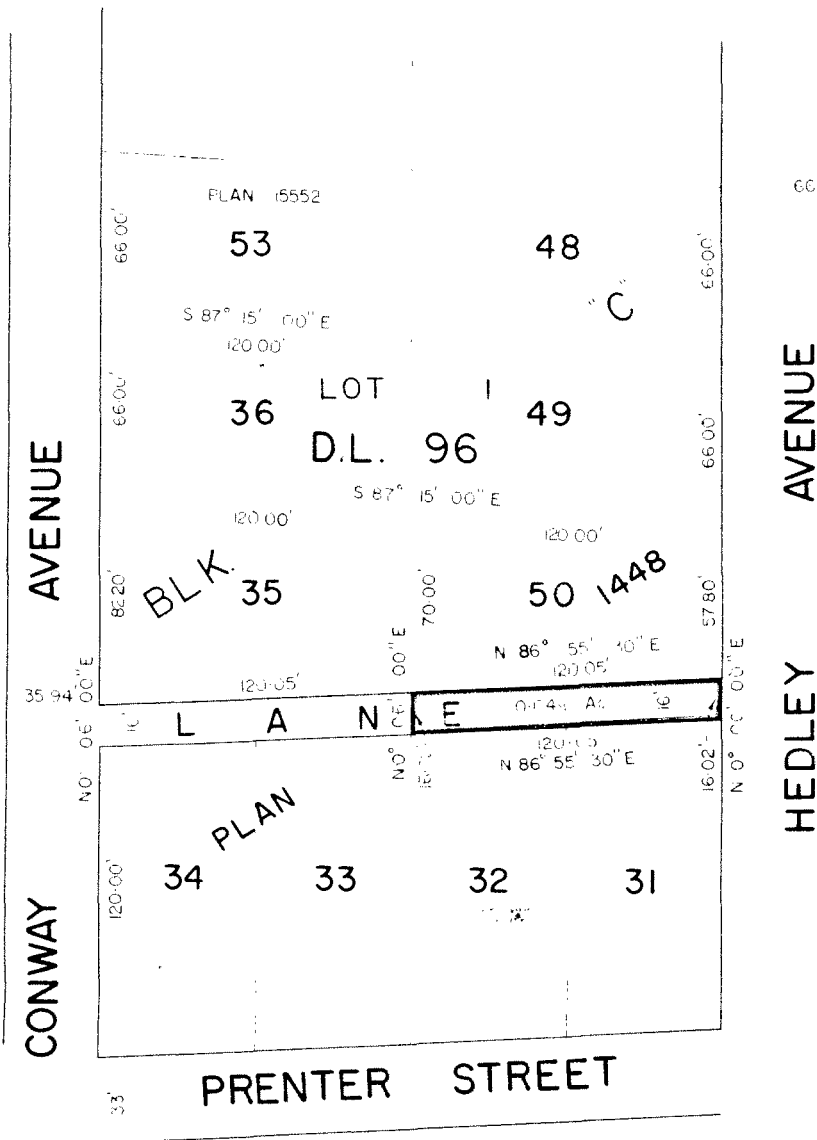

BOOK OF REFERENCE	
PARCEL	AREA
PORTION OF LANE	0.044 Ac

The Corporation of the District
 of Burnaby

Mayor: _____

DEPUTY Clerk: _____

Certified correct according to
 Land Registry Office records
 this 7th day of Nov 1968.

B. B. King
 B.C.L.S.

tion of the District of Burnaby,
 ion, Engineering Department,
 da Way, Burnaby 2, B.C.