

THE CORPORATION OF THE DISTRICT OF BURNABY

BY-LAW NO. 5260

A BY-LAW to amend By-Law No. 4742, being  
"Burnaby Zoning By-Law 1965".

WHEREAS application for rezoning has/~~have~~ been made to the  
Council

AND WHEREAS the Council has held a public hearing thereon after  
duly giving notice of the time and place of such hearing.

NOW THEREFORE the Council of The Corporation of the District of  
Burnaby ENACTS as follows:

1. This by-law may be cited as "BURNABY ZONING BY-LAW 1965, AMEND-  
MENT BY-LAW NO. 77 1967".

2. The Map (hereinafter called "Map "A"") attached to and forming an  
integral part of By-law No. 4742, being "Burnaby Zoning By-Law 1965", and  
designated as the Official Zoning Map of The Corporation of the District of  
Burnaby, is hereby amended according to the Map (hereinafter called "Map "B""),  
marginally numbered R.Z. 150, annexed to this by-law, and in accordance  
with the explanatory legend, notations, references and boundaries designated,  
described, delimited and specified in particularity shown upon said Map "B"; and  
the various boundaries and districts shown upon said Map "B" respectively are  
an amendment of and in substitution for the respective districts, designated  
and marked on said Map "A" insofar as the same are changed, modified or varied  
thereby, and the said Map "A" shall be deemed to be and is hereby declared to  
be amended accordingly and the said Map "B" is hereby declared to be and shall  
form an integral part of said Map "A", as if originally incorporated therein,  
and shall be interpreted accordingly.

Read a first time this 18th day of December 1967.

Read a second time this 18th day of December 1967.

Read a third time this 15th day of January 1968.

Reconsidered and adopted by an affirmative vote of at least two-  
thirds of all the members of the Council this 22nd day of January 1968.



*[Signature]*  
R E E V E  
*[Signature]*  
C L E R K

BY-LAW NO. 210 BEING A BY-LAW TO AMEND BY-LAW NO. 4742 BEING THE BURNABY ZONING BY-LAW, 1965

PROPERTY REZONED TO: MULTIPLE FAMILY RESIDENTIAL DISTRICT THREE (MFR3)  
 MAP "B"

Local: LOTS 3 TO 10 (Inclusive), Block 2, S.E. 151 3  
 Plan 2069 and positions of road as outlined below.

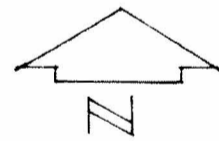
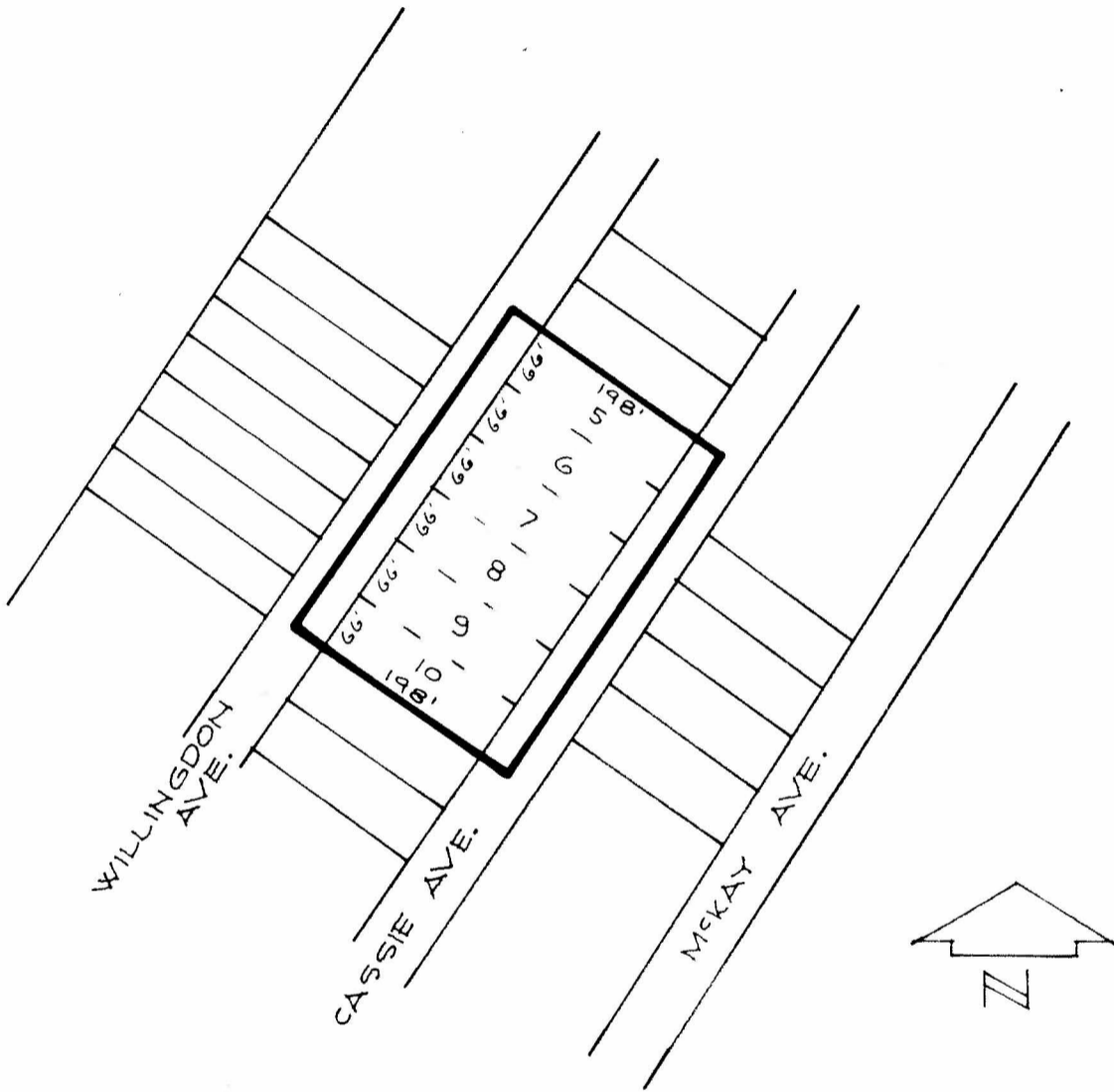

FROM: RESIDENTIAL DISTRICT FIVE (R5)  
 TO: MULTIPLE FAMILY RESIDENTIAL DISTRICT THREE (MFR3)

THE AREA(S) SHOWN ABOVE OUTLINED IN BLACK (—) IS (ARE) REZONED: See above.

PLANNING DEPARTMENT	
SCALE	1" = 200'
DRAWN	J.M.
DATE	FEB./68

CORPORATION OF THE DISTRICT OF BURNABY

OFFICIAL ZONING MAP

NO. R.Z. 10