

THE CORPORATION OF THE DISTRICT OF BURNABY

BY-LAW NO. 5070

A BY-LAW to amend By-Law No. 4742, being
"Burnaby Zoning By-Law 1965".

WHEREAS application for rezoning has/~~XXXX~~ been made to the
Council.

AND WHEREAS the Council has held a public hearing thereon after
duly giving notice of the time and place of such hearing.

NOW THEREFORE the Council of The Corporation of the District of
Burnaby ENACTS as follows:

1. This by-law may be cited as "BURNABY ZONING BY-LAW 1965, AMEND-
MENT BY-LAW NO. 13,1967".

2. The Map (hereinafter called "Map "A"") attached to and forming an
integral part of By-law No. 4742, being "Burnaby Zoning By-Law 1965", and
designated as the Official Zoning Map of The Corporation of the District of
Burnaby, is hereby amended according to the Map (hereinafter called "Map "B""),
marginally numbered R.Z. 76, annexed to this by-law, and in accordance
with the explanatory legend, notations, references and boundaries designated,
described, delimited and specified in particularity shown upon said Map "B"; and
the various boundaries and districts shown upon said Map "B" respectively are
an amendment of and in substitution for the respective districts, designated
and marked on said Map "A" insofar as the same are changed, modified or varied
hereby, and the said Map "A" shall be deemed to be and is hereby declared to
be amended accordingly and the said Map "B" is hereby declared to be and shall
form an integral part of said Map "A", as if originally incorporated therein,
and shall be interpreted accordingly.

Read a first time this 23rd day of January, 1967.

Read a second time this 23rd day of January, 1967.

Read a third time this 23rd day of January, 1967.

Reconsidered and adopted by an affirmative vote of at least two-
thirds of all the members of the Council this 13th day of February, 1967.



[Handwritten Signature]
R E E V E
[Handwritten Signature]
C L E R K

BY-LAW NO. 5070 BEING A BY-LAW TO AMEND BY-LAW NO. 4742 BEING THE BURNABY ZONING BY-LAW, 1965

PROPERTY REZONED TO: MULTIPLE FAMILY RESIDENTIAL DISTRICT THREE(RM3)

MAP BY:

Legal: That part of Block 3 West Half of North Half except part on Plan 4329, D.L. 4, Plan 845, shown outlined in black on the attached sketch and portions of road and lane as outlined below.

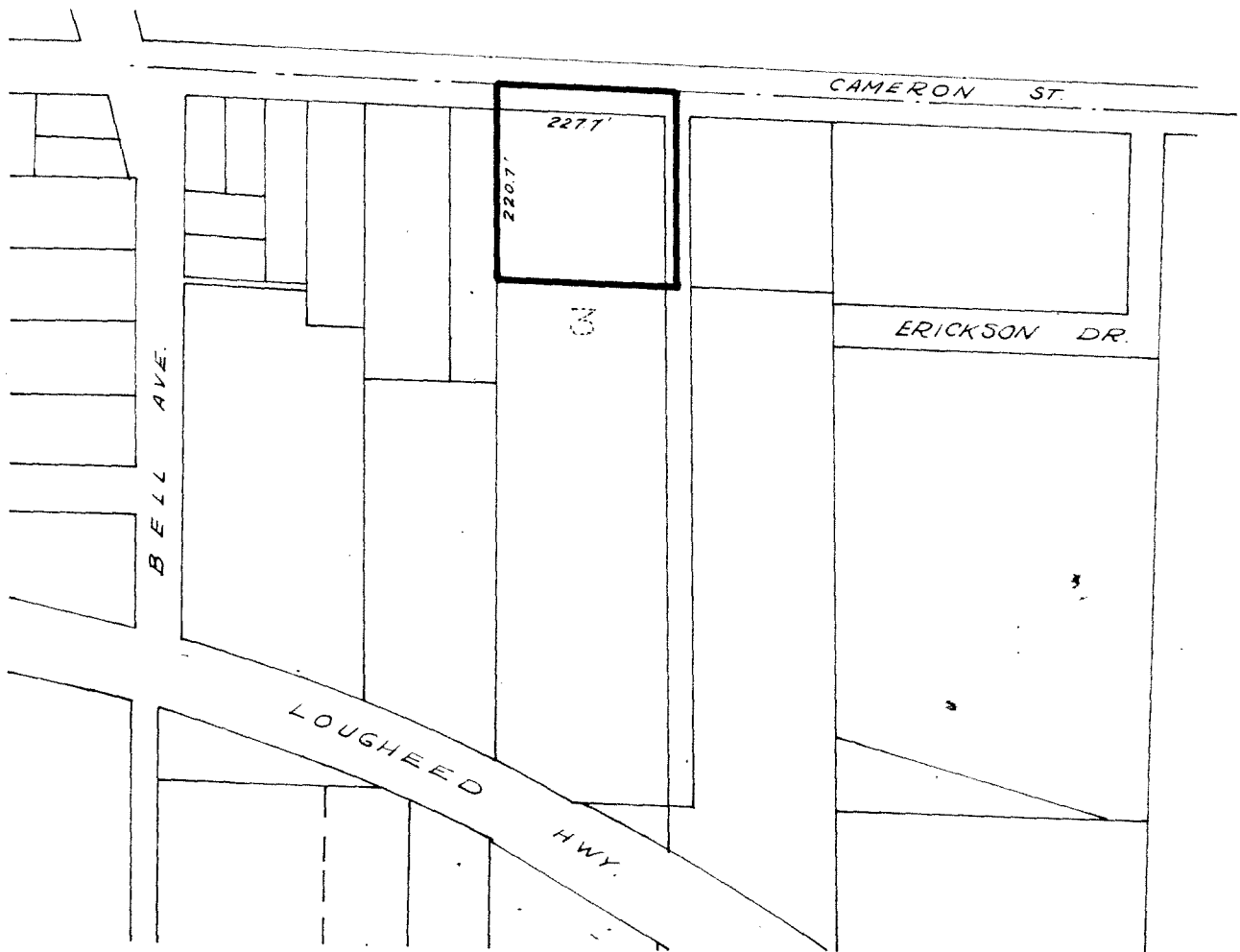

THE AREA(S) SHOWN ABOVE OUTLINED IN BLACK (—) IS(ARE) REZONED: FROM SMALL HOLDINGS DISTRICT (A2) TO MULTIPLE FAMILY RESIDENTIAL DISTRICT THREE(RM3)

B-1817

PLANNING DEPARTMENT		CORPORATION OF THE DISTRICT OF BURNABY	
SCALE		OFFICIAL ZONING MAP	
DRAWN			
DATE	Feb. 13, 1967		
		NO. R.Z. 76	