

THE CORPORATION OF THE DISTRICT OF BURNABY

BY-LAW NO. 3006.

A BY-LAW for closing a portion of Charles Street
within the Municipality of Burnaby.

WHEREAS the Board of School Trustees School District No. 41, (Burnaby), is the owner of lands on both sides of that portion of the public highway known as Charles Street in the Municipality of Burnaby outlined in red on the sketch hereto annexed as part of this By-law, made by Geoffrey K. Burnett, B.C.L.S., and dated the Fifth (5th) day of August 1949.

AND WHEREAS it is deemed expedient that the said part of the said Charles Street, hereinafter more particularly described, be closed for highway purposes and stopped up.

NOW THEREFORE the Council of The Corporation of the District of Burnaby in Open meeting assembled, ENACTS as follows:-

1. That the part of Charles Street outlined in red on the aforementioned sketch, and being:-

ALL AND SINGULAR that certain parcel or tract of land and premises situate, lying and being a portion of Charles Street in Lot 117, Group 1, District of New Westminster, Province of British Columbia, according to Plan 1222, deposited, and being more particularly described as follows:-

COMMENCING at the Southwest corner of block 24 in the Subdivision of the East half of Lot 117, Group 1, according to Plan 1222 deposited:

thence S.89°39'E. and following the Southerly boundary of said Block 24, 350.0 feet to the Southeast corner of Lot 12 of said Block 24;

thence S.0°21'W. 66.0 feet to the Northeast corner of Lot 7 of Block 25, according to Plan 1222, deposited;

thence N.89°39'W. and following the Northerly boundary of said Block 25, 350.0 feet to the Northwest corner thereof;

thence N.0°21'E. 66.0 feet to the point of commencement and containing by estimation 0.53 of an acre, be the same more or less as shown on the plan hereunto annexed and thereon outlined with Red Colour.

be stopped up and closed for highway purposes.

2. This By-law shall take effect upon registration thereof in the manner required by law.

3. This By-law may be cited as the "CHARLES STREET CLOSING BY-LAW 1949."

DONE AND PASSED in Open Council this Eighth (8th) day of
August A.D. 1949.

RECONSIDERED AND FINALLY PASSED this Twenty-second (22nd) day
of August A.D. 1949.



G. Morrison

REEVE

Charles B. Brown

CLERK

PLAN OF A PORTION OF CHARLES STREET
IN THE EAST HALF OF LOT 117, GROUP 1
NEW WESTMINSTER DISTRICT
ACCORDING TO PLAN 1222, DEPOSITED
TO ACCOMPANY CORPORATION OF THE DISTRICT
OF BURNABY BYLAW NUMBER

SCALE: 1 INCH = 100 FEET.

Note:

Bearings referred to Meridian
of Plan 9331, deposited.

PORTION OF CHARLES STREET TO BE CLOSED
OUTLINED WITH RED COLOUR.

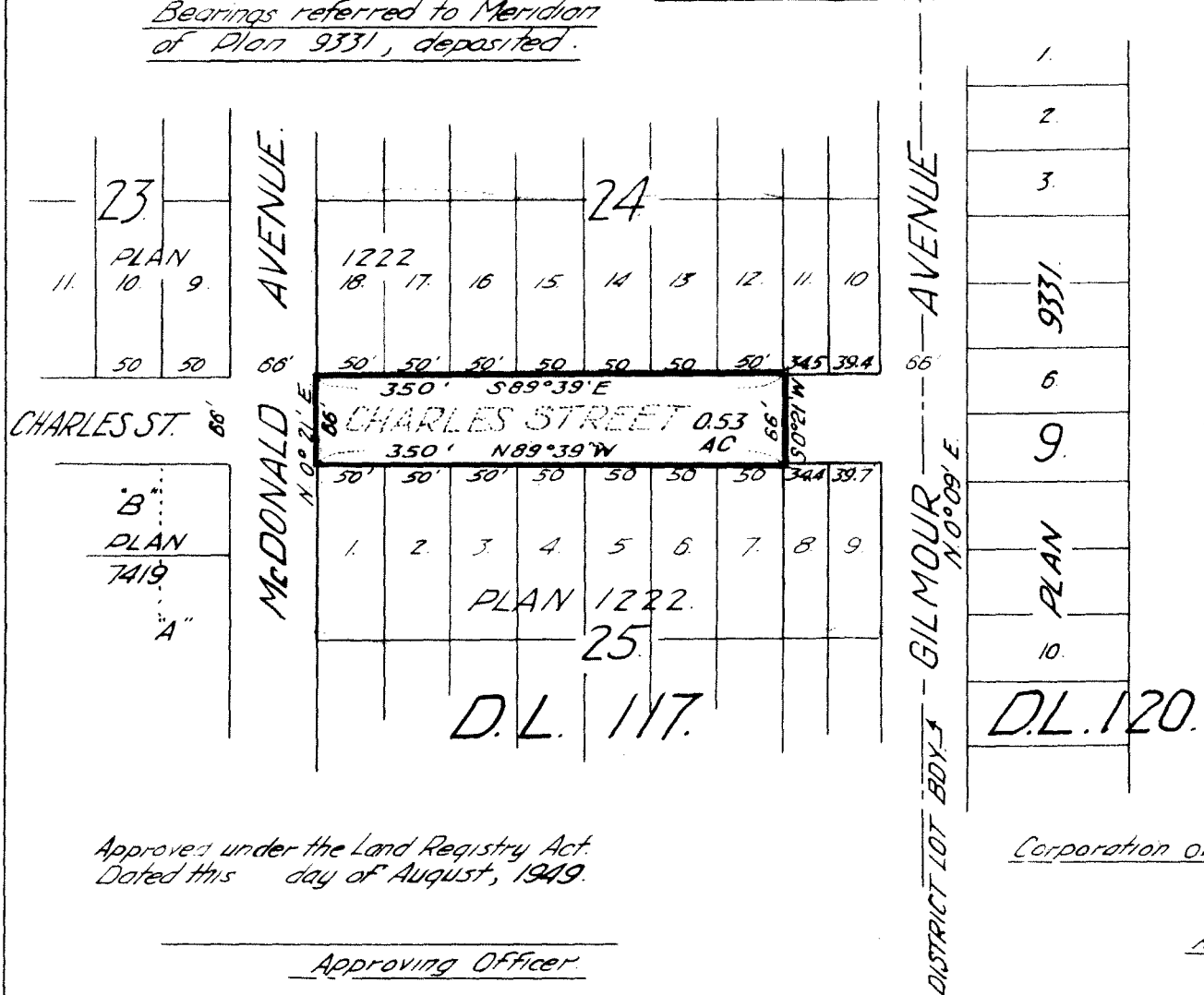

Deposited under Section 79
of the Land Registry Act.
this day of 194

Registrar

Corporation of the District of Burnaby

Reeve

Approved under the Land Registry Act.
Dated this day of August, 1949.

Approving Officer

Certified correct according to