

CITY OF BURNABY

BYLAW NO. 14389

A BYLAW to amend Bylaw No. 4742, being
Burnaby Zoning Bylaw 1965, as amended
by Bylaw No. 11990 being Burnaby Zoning
Bylaw 1965, Amendment Bylaw No. 51, 2005

WHEREAS application for rezoning has been made to the Council;

AND WHEREAS the Council has held a public hearing thereon after duly giving notice of the time and place of such hearing as prescribed by Sections 466 and 467 of the *Local Government Act*, R.S.B.C. 1996;

NOW THEREFORE the Council of the City of Burnaby ENACTS as follows:

1. This Bylaw may be cited as **BURNABY ZONING BYLAW 1965, AMENDMENT BYLAW NO. 32, 2021.**
2. Bylaw No. 4742, as amended by Bylaw No. 11990, is further amended as follows:
 - (a) The map (hereinafter called "Map 'A'") attached to and forming an integral part of Bylaw No. 4742, being Burnaby Zoning Bylaw 1965, and designated as the Official Zoning Map of the City of Burnaby, is hereby amended according to the Map (hereinafter called "Map 'B'"), marginally numbered REZ. 4388 annexed to this Bylaw, and in accordance with the explanatory

legend, notations, references and boundaries designated, described, delimited and specified in particularity shown upon said Map 'B', and the various boundaries and districts shown upon said Map 'B', respectively are an amendment of and in substitution for the respective districts, designated and marked on said Map 'A' insofar as the same are changed, modified or varied thereby, and the said Map 'A' shall be deemed to be and is hereby declared to be amended accordingly and the said Map 'B' is hereby declared to be and shall form an integral part of said Map 'A' as if originally incorporated therein and shall be interpreted accordingly.

Read a first time this 25th day of October, 2021

Read a second time this 6th day of December 2021

Read a third time this 25th day of April, 2022

Reconsidered and adopted this 25th day of April, 2022



MAYOR

CLERK

BYLAW NUMBER 14389 BEING A BYLAW TO AMEND BYLAW
NUMBER 4742 BEING BURNABY ZONING BYLAW 1965

REZ.21-37

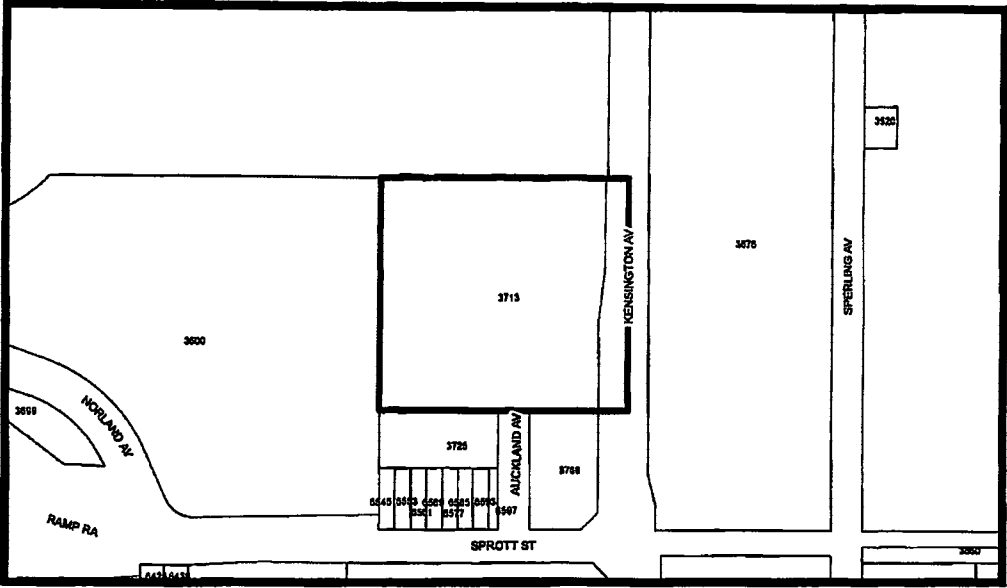

LEGAL: Lot 1 District Lot 77 Group 1 New Westminster District Plan BCP35150



THE AREA(S) SHOWN ABOVE OUTLINED IN BLACK (——) IS (ARE) REZONED

FROM: CD Comprehensive Development District (based on C2 Community Commercial District, C3e General Commercial District, P6 Regional Institutional District, and P2 Administration and Assembly District)

TO: P3 Park and Public Use District

		PLANNING & BUILDING DEPARTMENT			
Date: OCT 19 2021		OFFICIAL ZONING MAP			
Scale: 1:3,500					
Drawn By: RW					