

**CITY OF BURNABY**

**BYLAW NO. 14388**

A BYLAW to amend Bylaw No. 4742, being Burnaby Zoning Bylaw 1965, as amended by Bylaw Nos. 7496, 10267, 10517, and 10768, being Burnaby Zoning Bylaw 1965, Amendment Bylaw Nos. 14, 1980, 38, 1995, 2, 1997 and 32, 1998

WHEREAS application for rezoning has been made to the Council;

AND WHEREAS the Council has held a public hearing thereon after duly giving notice of the time and place of such hearing as prescribed by Sections 466 and 467 of the *Local Government Act*, R.S.B.C. 1996;

NOW THEREFORE the Council of the City of Burnaby ENACTS as follows:

1. This Bylaw may be cited as **BURNABY ZONING BYLAW 1965, AMENDMENT BYLAW NO. 31, 2021.**

2. Bylaw No. 4742, as amended by Bylaw Nos. 7496, 10267, 10517 and 10768, is further amended as follows:

(a) The Map (hereinafter called "Map 'A'"), attached to and forming an integral part of Bylaw No. 4742, being "Burnaby Zoning Bylaw 1965", and designated as the Official Zoning Map of the City of Burnaby, is hereby amended according to the Map (hereinafter called "Map 'B'"), marginally numbered REZ. 4387, annexed to this Bylaw, and in accordance with the explanatory legend, notations, references and boundaries designated, described, delimited and specified in particularity shown upon said Map 'B'; and the various boundaries and districts shown upon said Map 'B' respectively are an amendment of and in addition to the respective districts, designated and marked on said Map 'A' insofar as the same are changed, modified or varied

thereby, and the said Map 'A' shall be deemed to be and is hereby declared to be amended accordingly and the said Map 'B' is hereby declared to be and shall form an integral part of said Map 'A', as if originally incorporated therein and shall be interpreted accordingly.

(b) The Comprehensive Development Plan(s), more particularly described in Bylaw Nos. 7496, 10267, 10517, and 10768 are amended as may be necessary by the development plan entitled "Skysign Rezoning-REZ 21-20, 4250 Canada Way, Burnaby", prepared by Signarama Burnaby, on the lands rezoned by this Bylaw shall be in conformity with the said Comprehensive Development Plans as amended.

Read a first time this 25<sup>th</sup> day of October, 2021

Public Hearing held on 23<sup>rd</sup> day of November, 2021

Read a second time this 6<sup>th</sup> day of December, 2021

Read a third time, Reconsidered and Adopted by Council this 5th day of June, 2023



MAYOR



CORPORATE OFFICER

BYLAW NUMBER 14388 BEING A BYLAW TO AMEND BYLAW  
NUMBER 4742 BEING BURNABY ZONING BYLAW 1965

**REZ.21-20**

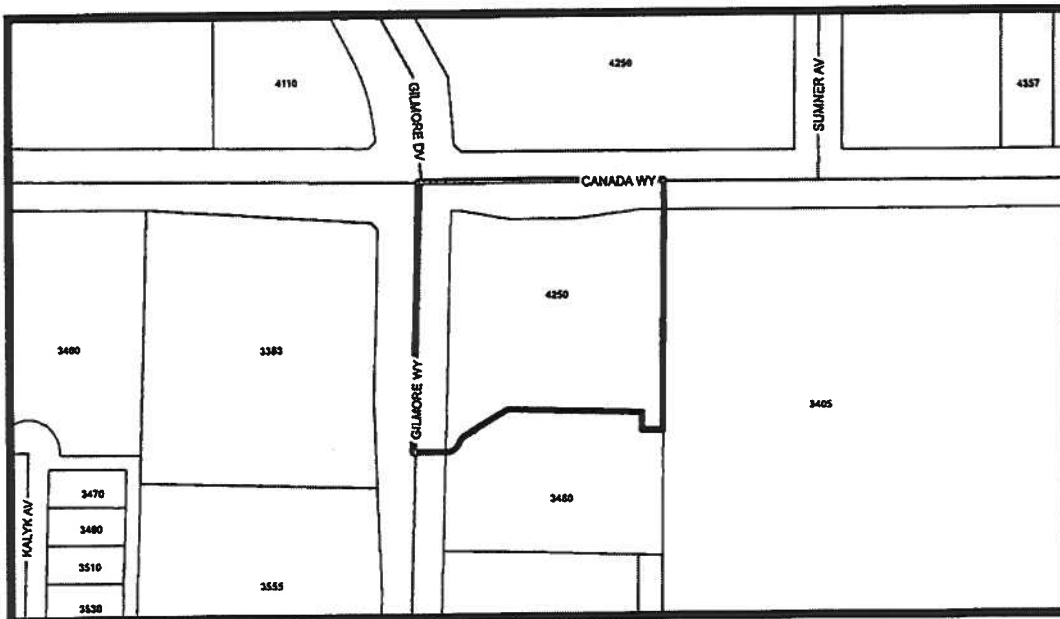

LEGAL: Lot A District Lot 71 Group 1 New Westminster District Plan LMP39921



THE AREA(S) SHOWN ABOVE OUTLINED IN BLACK ( ——— ) IS (ARE) REZONED

FROM: Amended CD Comprehensive Development District (based on M8a Advanced  
Technology Research District and Discovery Place Community Plan)

TO: Amended CD Comprehensive Development District (based on M8a Advanced  
Technology Research District and Discovery Place Community Plan guidelines and in  
accordance with the development plan entitled "Skysign Rezoning – REZ 21-20, 4250  
Canada Way, Burnaby" prepared by Signarama Burnaby)

		PLANNING & BUILDING DEPARTMENT			
Date:	OCT 15 2021	<b>OFFICIAL ZONING MAP</b>		Map "B" No. REZ. 4387	
Scale:	1:2,500				
Drawn By:	RW				