

**CITY OF BURNABY**

**BYLAW NO. 14245**

A BYLAW to amend Bylaw No. 4742, being Burnaby Zoning Bylaw 1965, as amended by Bylaw Nos. 7036 and 9907 being Burnaby Zoning Bylaw 1965, Amendment Bylaw Nos. 25, 1977 and 30, 1993

WHEREAS application for rezoning has been made to the Council;

AND WHEREAS the Council has held a public hearing thereon after duly giving notice of the time and place of such hearing as prescribed by Sections 466 and 467 of the *Local Government Act*, R.S.B.C. 1996;

NOW THEREFORE the Council of the City of Burnaby ENACTS as follows:

1. This Bylaw may be cited as **BURNABY ZONING BYLAW 1965, AMENDMENT BYLAW NO. 45, 2020.**

2. Bylaw No. 4742, as amended by Bylaw Nos. 7036 and 9907, is further amended as follows:

(a) The Map (hereinafter called "Map 'A'"), attached to and forming an integral part of Bylaw No. 4742, being "Burnaby Zoning Bylaw 1965", and designated as the Official Zoning Map of the City of Burnaby, is hereby amended according to the Map (hereinafter called "Map 'B'"), marginally numbered REZ. 4346, annexed to this Bylaw, and in accordance with the explanatory legend, notations, references and boundaries designated, described, delimited and specified in particularity shown upon said Map 'B'; and the various boundaries and districts shown upon said Map 'B' respectively are an amendment of and in addition to the respective districts, designated and marked on said Map 'A' insofar as the same are changed, modified or varied thereby, and the said Map 'A' shall be deemed to be and is hereby declared to be amended

accordingly and the said Map 'B' is hereby declared to be and shall form an integral part of said Map 'A', as if originally incorporated therein and shall be interpreted accordingly.

(b) The Comprehensive Development Plans, more particularly described in Bylaw Nos. 7036 and 9907, are amended as may be necessary by the development plan entitled "Riverwalk" prepared by VDZ + A Landscape Architecture / Civil Engineering / Urban Forestry and on file in the office of the Director Planning and Building; and any development on the lands rezoned by this Bylaw shall be in conformity with the said Comprehensive Development Plans as amended.

Read a first time this 23<sup>rd</sup> day of November, 2020

Read a second time this 17<sup>th</sup> day of December, 2020

Read a third time this 26<sup>th</sup> day of April, 2021

Reconsidered and adopted by Council this 28<sup>th</sup> day of June, 2021

  
MAYOR

  
CLERK

BYLAW NUMBER 14245 BEING A BYLAW TO AMEND BYLAW  
NUMBER 4742 BEING BURNABY ZONING BYLAW 1965

REZ. 20-21

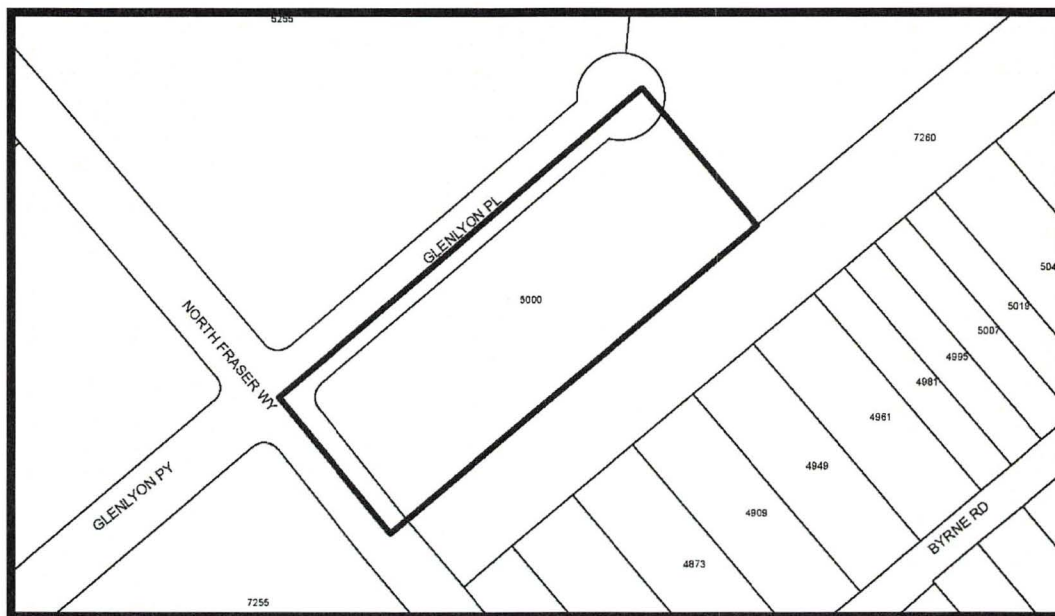

LEGAL: Lot 3, DL 165, Group 1, NWD Plan EPP49841



THE AREA(S) SHOWN ABOVE OUTLINED IN BLACK ( — ) IS (ARE) REZONED

FROM: CD Comprehensive Development District (based on M2 General Industrial District, M5 Light Industrial District, and Glenlyon Concept Plan as guidelines)

TO: Amended CD Comprehensive Development District (based on M2 General Industrial District, M5 Light Industrial District, P8 Parking District, and Glenlyon Concept Plan guidelines and in accordance with the development plan entitled "Riverwalk" prepared by VDZ + A Landscape Architecture / Civil Engineering / Urban Forestry)

		PLANNING & BUILDING DEPARTMENT			
Date:	Nov 17 2020	<b>OFFICIAL ZONING MAP</b>		Map "B" No. REZ. 4346	
Scale:	1:3,000				
Drawn By:	JS				